

Sill Flashing Fold Diagram

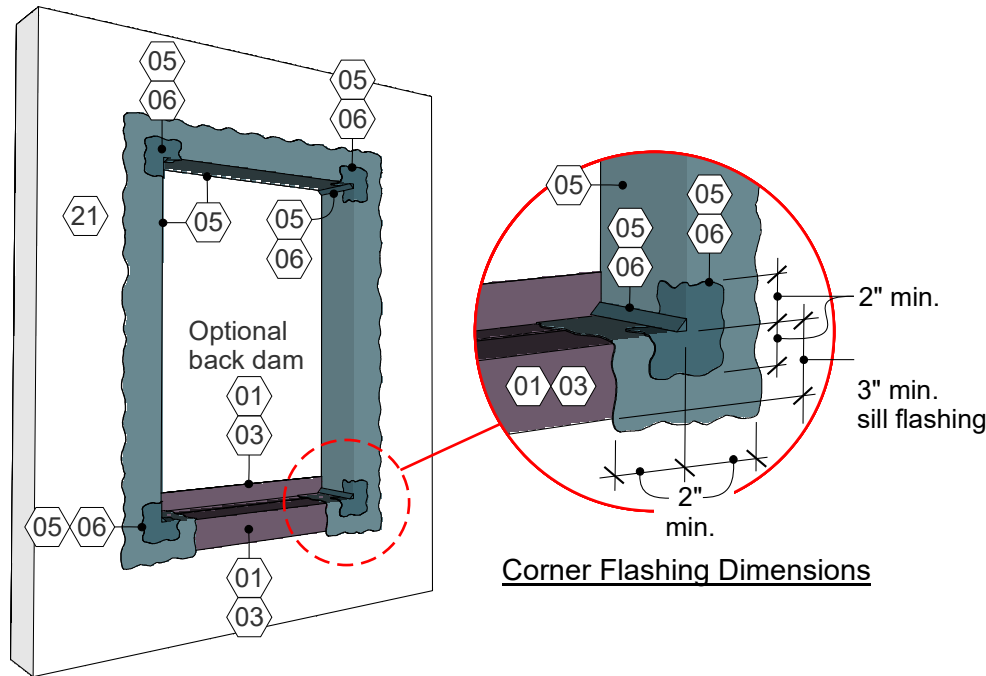

Corner Flashing Dimensions

NOTES

Refer to WALLcontrol Installer's Guides for detailed instructions regarding the specific products, personal protection, storage, handling, relevant codes, installation tools, substrate preparation, and general application guidelines. Coordinate installation of Siplast WALLcontrol products with the roofing trade to ensure compatibility and continuity with the roofing, waterproofing, and facade systems.

Sill First: Install the sill pan prior to the jamb or head flashing for the rough opening following the sequence:

1. Measure the **⟨01⟩ Siplast WALLcontrol Stainless Steel Butyl Adhered Flashing** or **⟨03⟩ Siplast WALLcontrol Reinforced Aluminum Butyl Adhered Flashing** for the sill flashing membrane to provide enough material for at least 3 inches lapping on the vertical wall surface and a depth into the rough opening that is beyond the inner surface of the fenestration/door frame to allow for an interior sealant joint and to accommodate the back dam height. Cut the sill flashing membrane to accommodate the opening width plus at least 3 inches turn up each jamb and the depth in the rough opening.
- Optional Back Dam: If utilizing an optional back dam, ensure the flashing depth is long enough to accommodate the back dam height. When applying the sill flashing membrane, fold the membrane up to the top to the designed height of the sill back dam (1 inch vertical back dam is a common height), pinch, fold, and turn the corner into an end dam.
2. Remove the release liner progressively for each face of the rough opening and press the membrane into place. Cut the sill flashing membrane at the face of the **⟨21⟩ substrate** at each corner to create the downward leg of the sill pan. Do not cut or damage the install flashing or AWB below.
3. Sill flashing membrane can be either one monolithic piece or multiple pieces to accommodate the installation. Sections of the flashing membranes are to be lapped at least 3 inches, sealed using **⟨05⟩ Siplast WALLcontrol Modified Silicone (STPE) VP Liquid Flashing** or **⟨06⟩ Siplast PS-715 NS Elastomeric Sealant** or a compatible approved sealant, and tooled.

Jambs and Head after Sill: Install the head flashing after the jamb flashing for the rough opening following the sequence:

1. Fill any gaps greater than ¼ inch in with **⟨05⟩ Siplast WALLcontrol Modified Silicone (STPE) VP Liquid Flashing** or **⟨06⟩ Siplast PS-715 NS Elastomeric Sealant** and allow to dry. Stamped holes in cold form steel studs can be sealed with **⟨01⟩ Siplast WALLcontrol Stainless Steel Butyl Adhered Flashing** or **⟨03⟩ Siplast WALLcontrol Reinforced Aluminum Butyl Adhered Flashing** and must be applied to overlap beyond the hole at least 3 inches.
2. Starting at the fenestration head, apply a bead of **⟨05⟩ Siplast WALLcontrol Modified Silicone (STPE) VP Liquid Flashing** onto the inside surface of the rough opening and onto the face of the wall. Use a trowel or brush to smooth out the flashing to a minimum thickness of 40 mils wet, extending a minimum of 2 inches onto the wall face and into the rough opening to a depth into the rough opening that is beyond the inner surface of the fenestration/door frame to allow for an interior sealant joint.
3. Continue the same process outlined above for the jambs. Lap the jamb liquid flashing onto the adhered sill membrane at least 2 inches.

General Notes:

1. The **⟨21⟩ substrate** must be clean and dry and free from any condition that would be detrimental to the adhesion of the membrane. **⟨08⟩ Siplast Pro Primer AC** is a water-based primer that imparts an aggressive, high-tack finish to improve adhesion to the substrate.
 2. Adhered materials must be firmly pressed onto the sheathing using a J-roller.
 3. See Detail 03.1 Fenestration Flashing Overview for information regarding the integration of the rough opening flashing with the wall AWB membrane. Fenestration flashings and AWB membrane should be installed in a sequence that maintains a continuous downward water drainage plane with an unobstructed path to the exterior of the wall system.
- For **⟨02⟩ Siplast WALLcontrol Reinforced Aluminum Butyl Adhered AWB** on the **⟨21⟩ substrate**, the AWB must be installed flush with the fenestration sill prior to treating the rough opening with **⟨05⟩ Siplast WALLcontrol Modified Silicone (STPE) VP Liquid Flashing**.