

SIDE LAP DETAIL - FULLY ADHERED SYSTEM

PARASOLO FLEECE-BACK MEMBRANE - INSULCEL LIGHTWEIGHT INSULATING CONCRETE

LEGEND

HEAT WELD

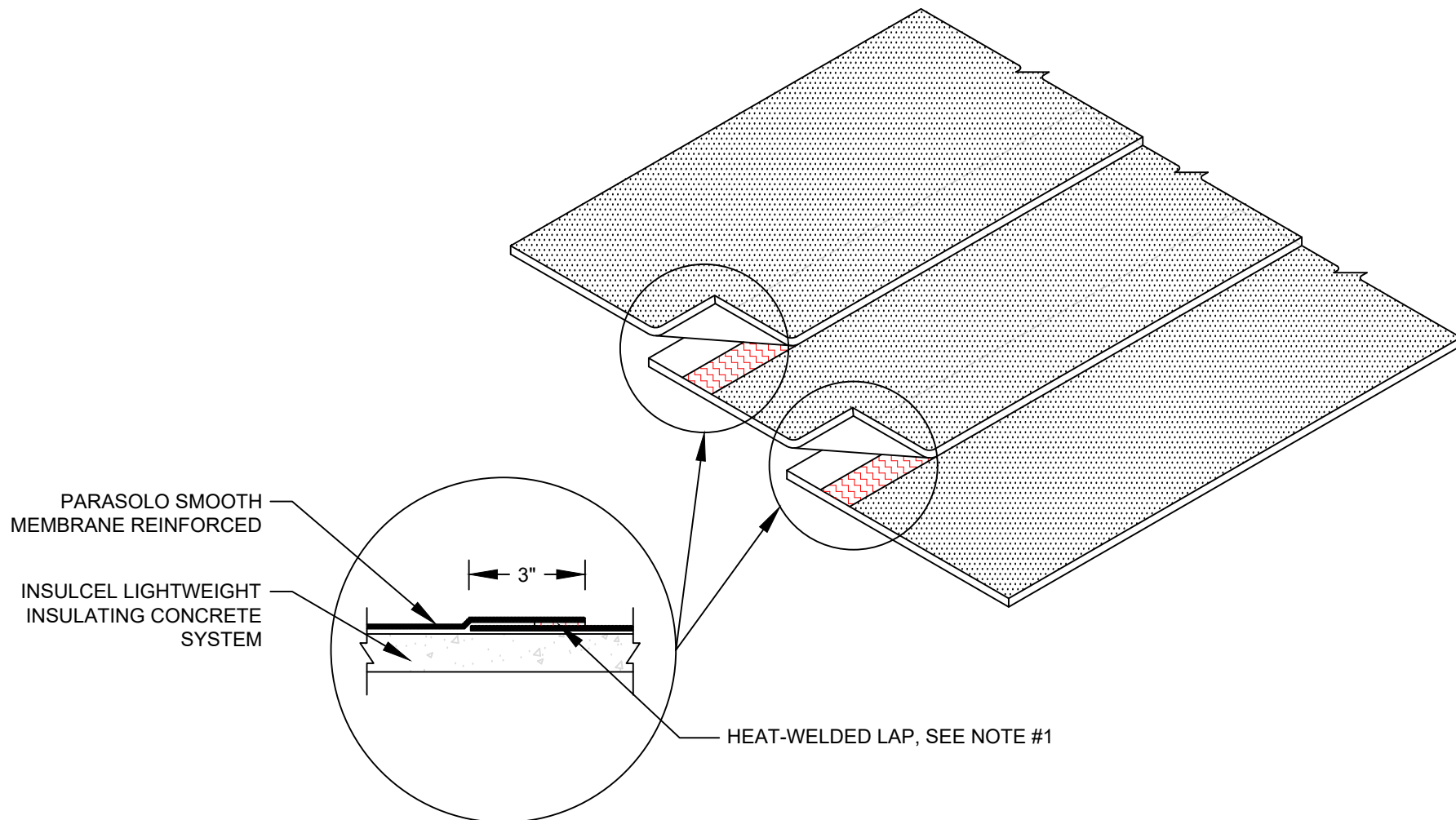

NOTES:

1. FOR HEAT-WELDING LAPS USE 1" MIN. WELD TO 1-1/2" MAXIMUM WELD.

Scale: NTS

REF: SIDE LAP DETAIL-ADHERED - PARASOLO - INSULCEL

Detail Number:
DE-SP-38-08a



14911 Quorum Drive, Suite 600 - Dallas, Texas - 75254 (800) 922-8800

www.siplast.com

Rev: 06.15.2023