

# POURABLE SEALANT POCKET

PARASOLO FLEECE BACK MEMBRANE  
INSULCEL LIGHTWEIGHT  
INSULATING CONCRETE

LEGEND

SEALANT

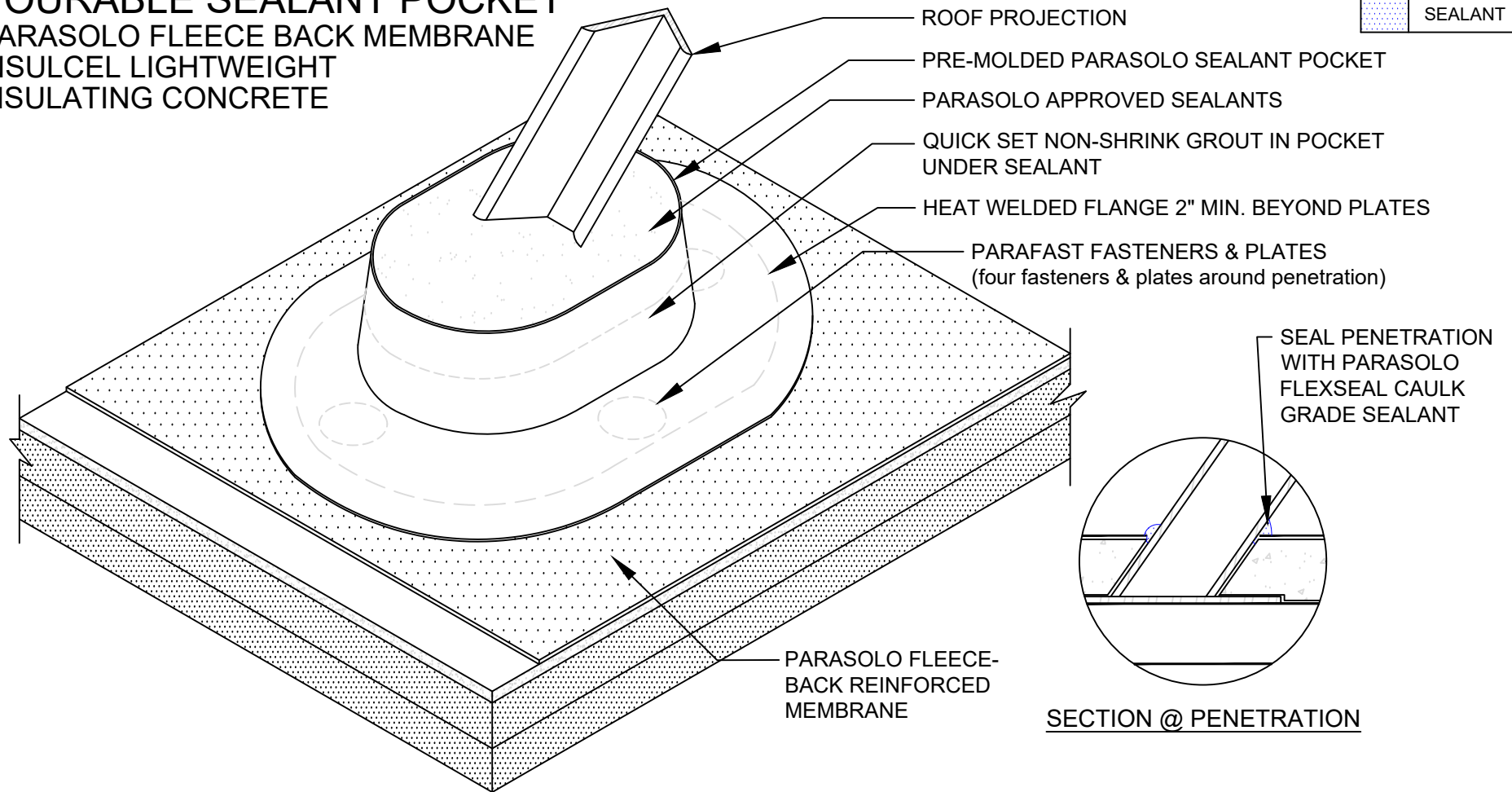

## NOTES:

1. ALLOW 2 INCHES OF CLEARANCE AROUND THE PROJECTION. IF MULTIPLE PROJECTIONS, ALLOW 1 INCH BETWEEN PROJECTION & POCKET.
2. THE EXISTING PROJECTION MUST BE CLEAN OF ALL DEBRIS BEFORE INSTALLATION.
3. IF SEALANT POCKET MUST BE CUT, STRIP IN CUT WITH AN UNREINFORCED PARASOLO STRIP 4 INCHES MIN. WIDE AND EXTEND ONTO THE FIELD MEMBRANE A MINIMUM OF 2 INCHES.
4. IF PLATES AND FASTENERS ENCROACH INTO THE SEAM AREA OF THE POCKET, THEN A TARGET MUST BE ADDED FIRST TO COVER THE FASTENERS.
5. REQUIREMENTS AND RECOMMENDATIONS DETAILED IN CURRENT SIPLAST SPECIFICATIONS SHALL APPLY IN ADDITION TO THE ABOVE DRAWING.

Scale: NTS

REF: POURABLE SEALANT POCKET - PARASOLO - INSULCEL

**Detail Number:**  
DE-SP-38-03i



14911 Quorum Drive, Suite 600 - Dallas, Texas - 75254 (800) 922-8800

[www.siplast.com](http://www.siplast.com)

**Rev:** 06.15.2023