

# LIGHTNING PROTECTION TERMINAL - WALL MOUNT DETAIL

## PARASOLO HYBRID SYSTEM - INSULATED

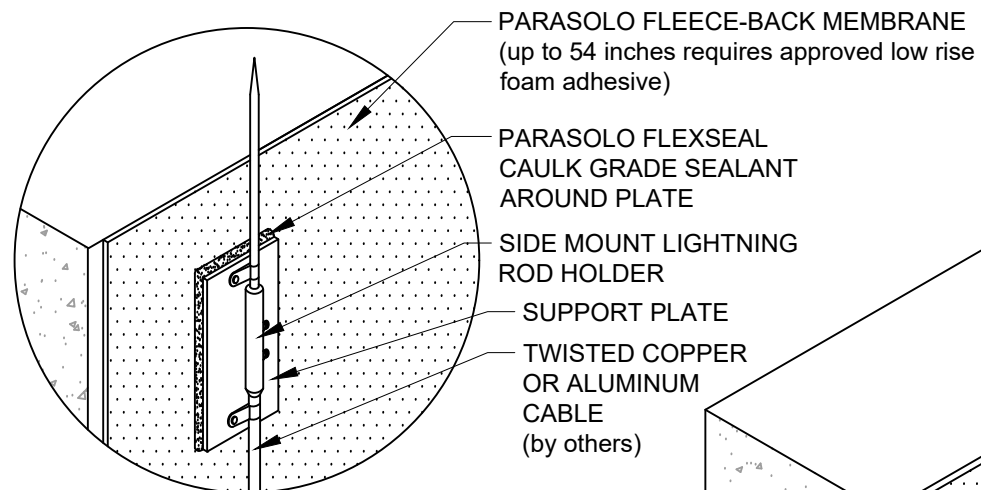

ALTERNATE ROD WALL MOUNT

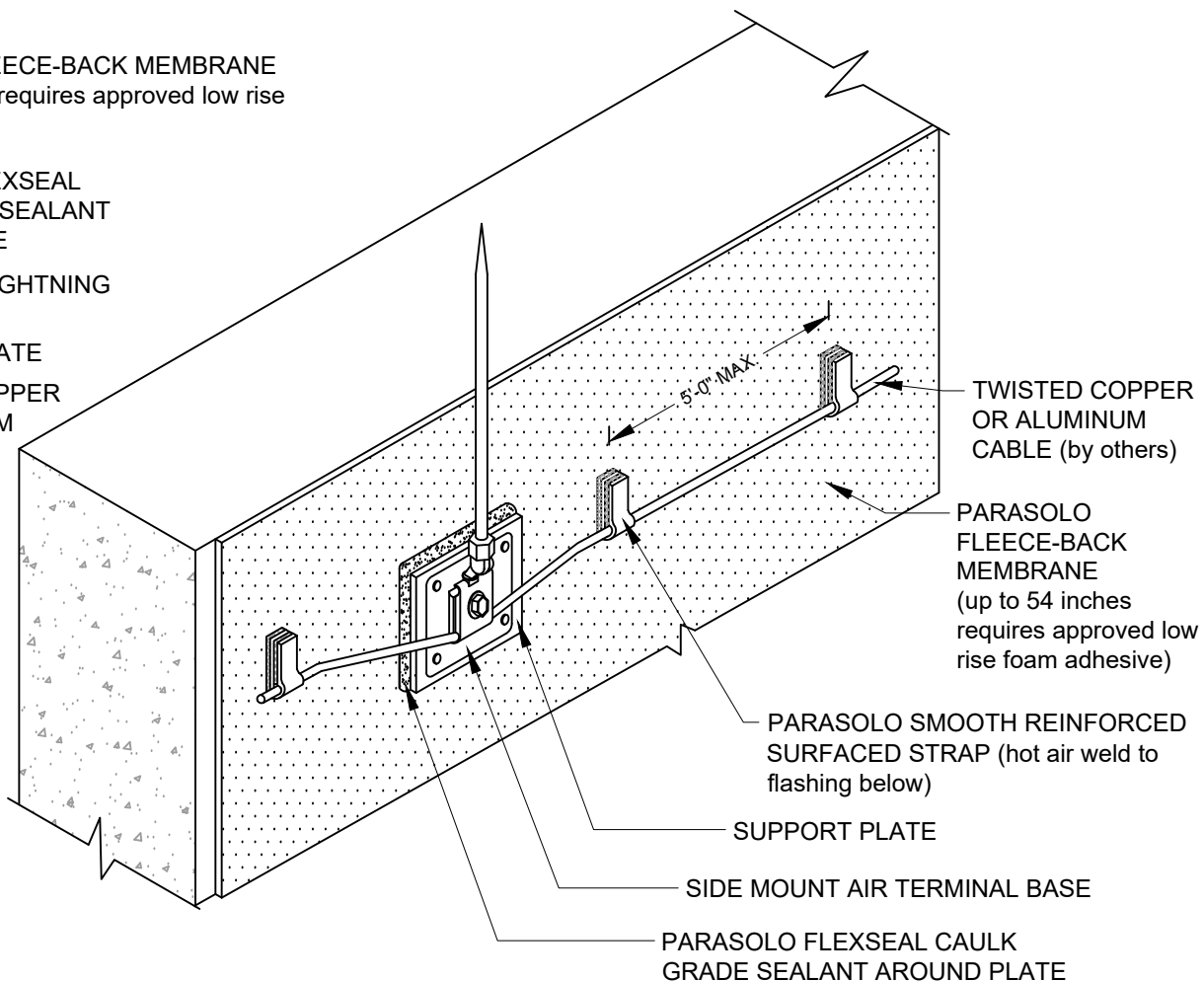

### NOTES:

1. DAMAGE TO PARASOLO MEMBRANE IS EXCLUDED FROM GURANTEE COVERAGE.
2. THE PARASOLO PATCHES SHOULD BE INSTALLED BY A SIPLAST SELECT CONTRACTOR.
3. THE INSTALLATION OF THE LIGHTNING PROTECTION SYSTEM SHOULD FOLLOW THE SPECIFICATIONS OF THE LIGHTNING PROTECTION SYSTEM MANUFACTURER.
4. REQUIREMENTS AND RECOMMENDATIONS DETAILED IN CURRENT SIPLAST SPECIFICATIONS SHALL APPLY IN ADDITION TO THE ABOVE DRAWING.

CAUTION: SIPLAST RECOMMENDS THAT ALL PRACTICES PERTAINING TO INDUSTRY STANDARD TORCH SAFETY REQUIREMENTS AND GUIDELINES BE FOLLOWED. THIS INCLUDES PERFORMING A FIRE WATCH FOLLOWING ANY TORCH APPLICATIONS. ALWAYS HAVE APPROVED FIRE EXTINGUISHING EQUIPMENT NEARBY WHEN USING A TORCH.

Scale: NTS

REF: LIGHTNING PROTECTION TERMINAL - WALL MOUNT - PARASOLO - P20 - INSULATED

**Detail Number:**  
DE-SP-37-10f



14911 Quorum Drive, Suite 600 - Dallas, Texas - 75254 (800) 922-8800

[www.siplast.com](http://www.siplast.com)

Rev: 06.06.2023