

# INSIDE CORNER REINFORCEMENT - FIELD FABRICATED DETAIL

## PARASOLO ROOF MEMBRANE - INSULATED (ALL SYSTEMS)

LEGEND	
	HEAT WELD

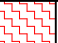
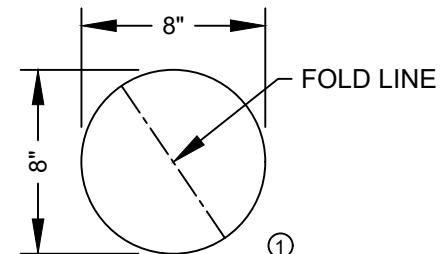
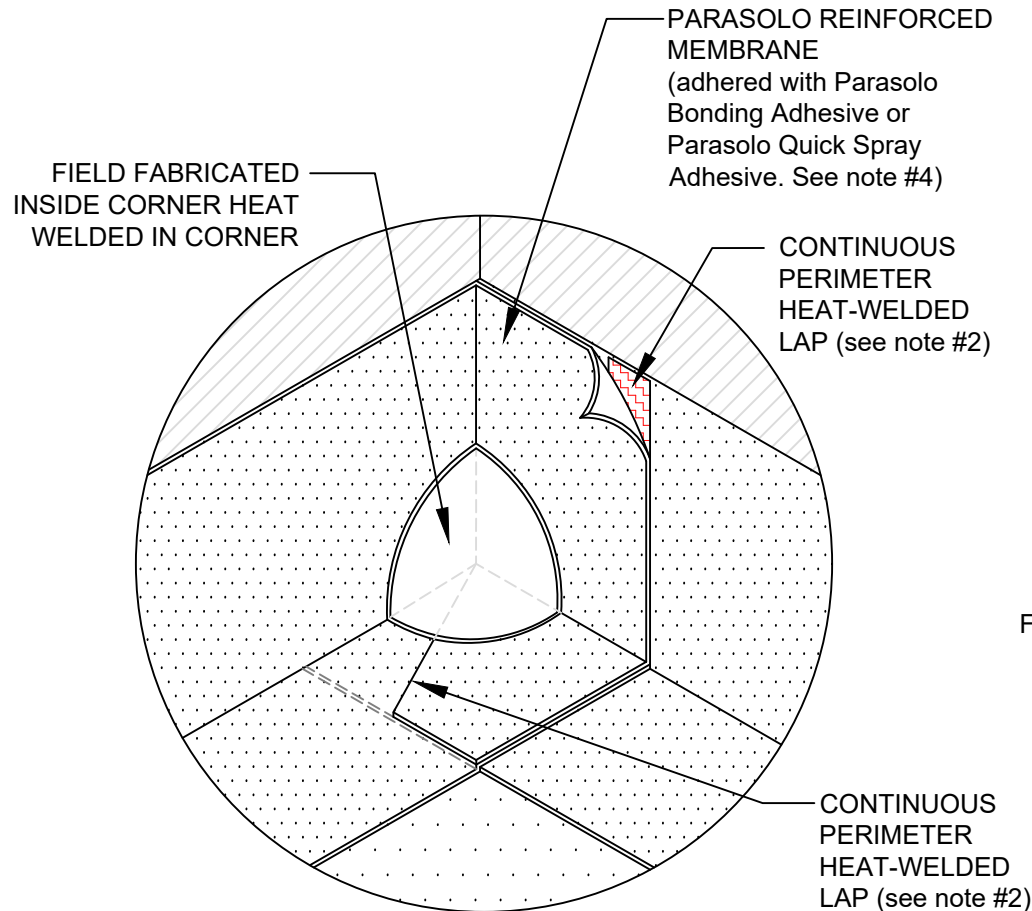

CUT A SECTION OF NON-REINFORCED PARASOLO MEMBRANE. FOLD ALONG LINE AS INDICATED.

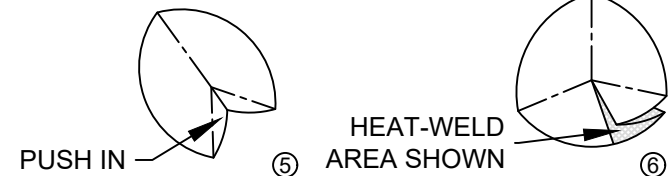
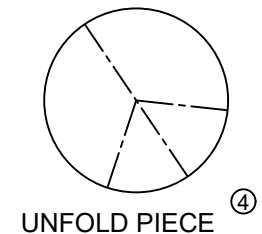
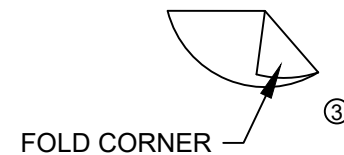
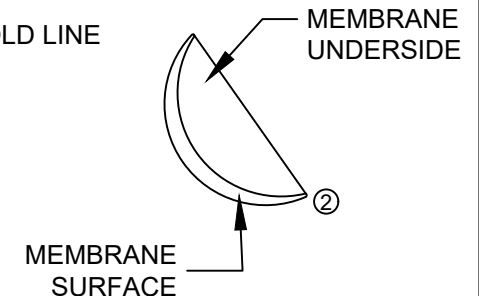

### NOTES:

1. INSIDE CORNERS SHOULD BE FIELD-FABRICATED USING UNREINFORCED SMOOTH MEMBRANE.
2. FOR HEAT-WELDING LAPS USE 1" MINIMUM WELD TO 1-1/2" MAXIMUM WELD.
3. REQUIREMENTS AND RECOMMENDATIONS DETAILED IN CURRENT SIPLAST SPECIFICATIONS SHALL APPLY IN ADDITION TO THE ABOVE DRAWING
4. PARASOLO BONDING ADHESIVE CAN BE USED UP TO A MAXIMUM FLASHING HEIGHT OF 54 INCHES. ADDITIONAL TERMINATION IS REQUIRED FOR FLASHING HEIGHTS ABOVE 54 INCHES WHEN PARASOLO BONDING ADHESIVE IS USED. CONTACT THE SIPLAST TECHINAL DEPARTMENT FOR ADDITIONAL INFORMATION.

Scale: NTS

REF: INSIDE CORNER REINFORCED - FIELD FABRICATED - PARASOLO - INSULATED

Detail Number:  
DE-SP-36-15c



14911 Quorum Drive, Suite 600 - Dallas, Texas - 75254 (800) 922-8800

[www.siplast.com](http://www.siplast.com)

Rev: 06.08.2023