

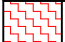

PARAFAST[®] RHINO BOND[®] ASSEMBLY DETAIL

PARASOLO ROOF MEMBRANE - INSULATED (HEAT INDUCTION SYSTEM)

LEGEND	
	HEAT WELD
	SEALANT
	ADHESIVE

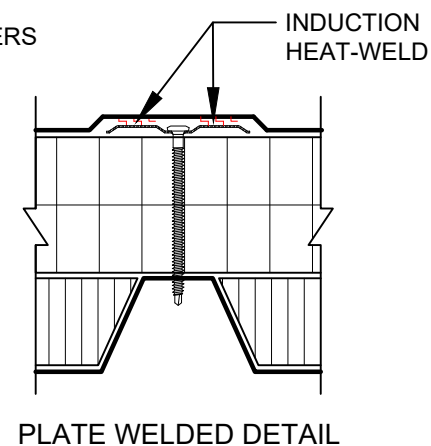
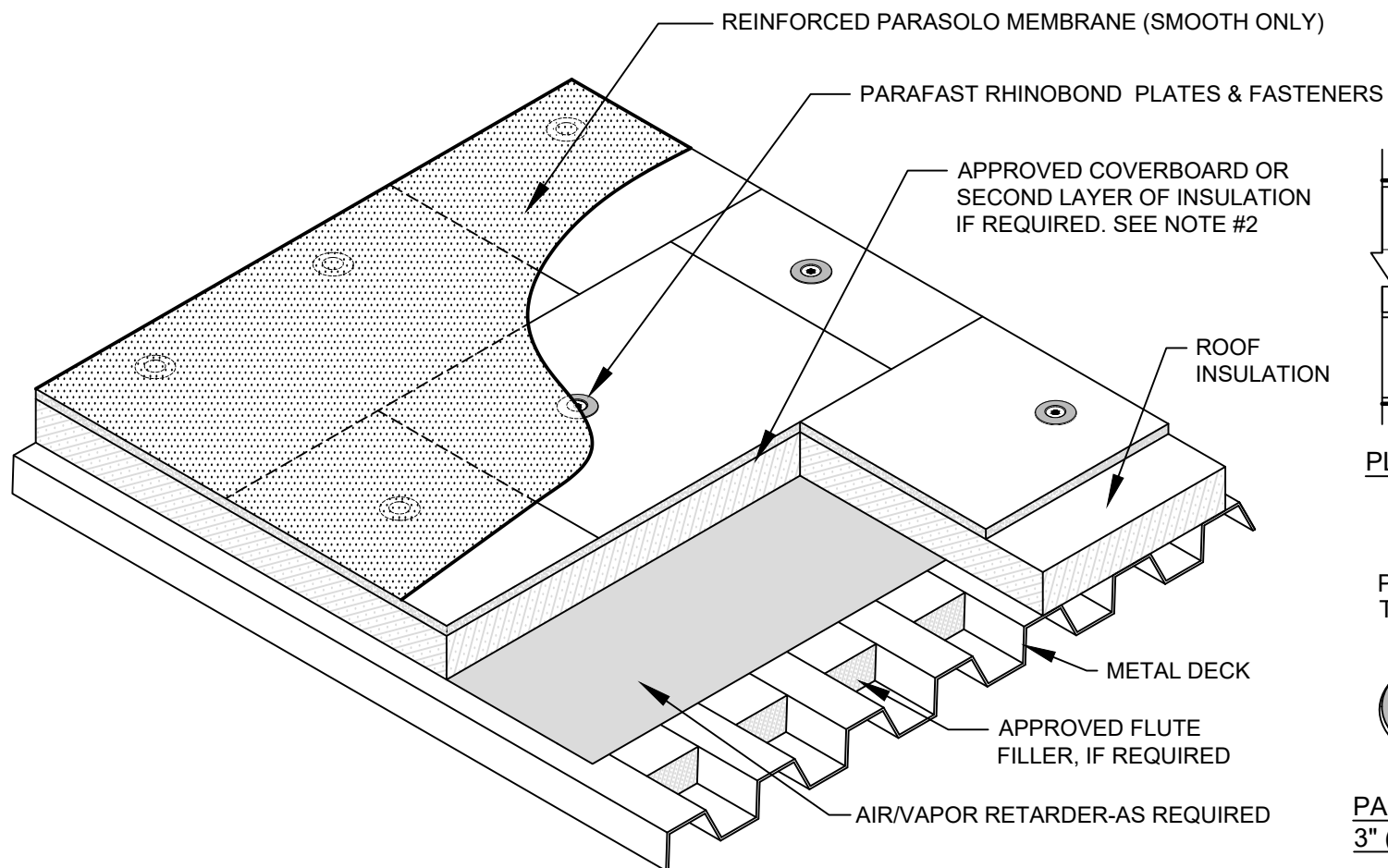

PVC = BLACK PLATE
TPO = GOLD PLATE

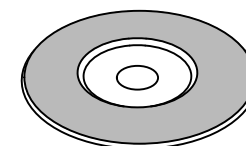

PARAFAST RHINO BOND
3" (76 mm) PLATE

NOTES:

1. REFER TO THE PARAFAST RHINO BOND ATTACHMENT TABLES FOR DETAILED INSTALLATION REQUIREMENTS REGARDING DECK TYPE, PLATE & FASTENER TYPE, AND MIN. EMBEDMENT.
2. TOP LAYER OF INSULATION DOES NOT HAVE TO BE STAGGERED IF BASE LAYER IS STAGGERED.

Scale: NTS

REF: PARAFAST RHINO BOND ASSEMBLY - PARASOLO - INSULATED



14911 Quorum Drive, Suite 600 - Dallas, Texas - 75254 (800) 922-8800

www.siplast.com

Detail Number:
DE-SP-36-07e

Rev: 06.08.2023