

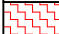

CURB with PARAPRO 123 FLASHING
PARASOLO TPX ROOF MEMBRANE - INSULATED (ALL SYSTEMS)

LEGEND	
	HEAT WELD
	SEALANT

TPX
ONLY

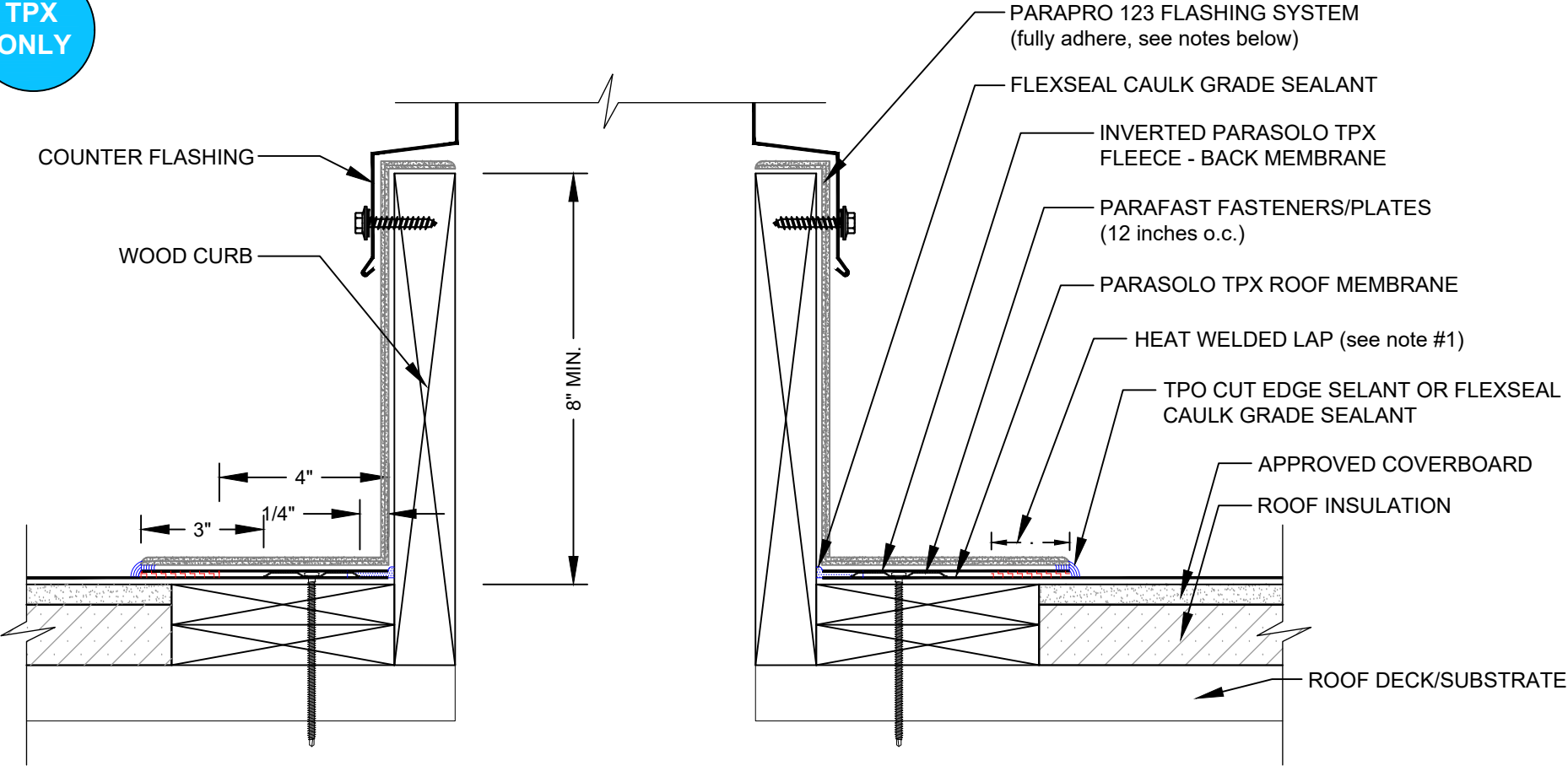

NOTES:

1. FOR HEAT-WELDING LAPS USE 1" MINIMUM TO 1-1/2" MAXIMUM WELD.
2. REFER TO SIPLAST PREPARATION GUIDELINES FOR PROPER SURFACE TREATMENT OF ALL SUBSTRATES PRIOR TO APPLICATION OF PARAPRO MATERIALS.
3. REFER TO SIPLAST FLEECE CUTTING RECOMMENDATIONS FOR CONFIGURATIONS, CUTTING, FOLDING, AND LAPPING TECHNIQUES.
4. REQUIREMENTS AND RECOMMENDATIONS DETAILED IN CURRENT SIPLAST SPECIFICATIONS AND THE PARAPRO 123 FLASHING INSTALLERS GUIDE SHALL APPLY IN ADDITION TO THE ABOVE DRAWING.

Scale: NTS

REF: CURB - PARASOLO TPX - PPRO - INSULATED

Detail Number:
DE-SP-36-01i



14911 Quorum Drive, Suite 600 - Dallas, Texas - 75254 (800) 922-8800

www.siplast.com

Rev: 07.09.2024