

# PARAPET WITH COPING

## SBS SELF-ADHESIVE SYSTEM - INSULATED

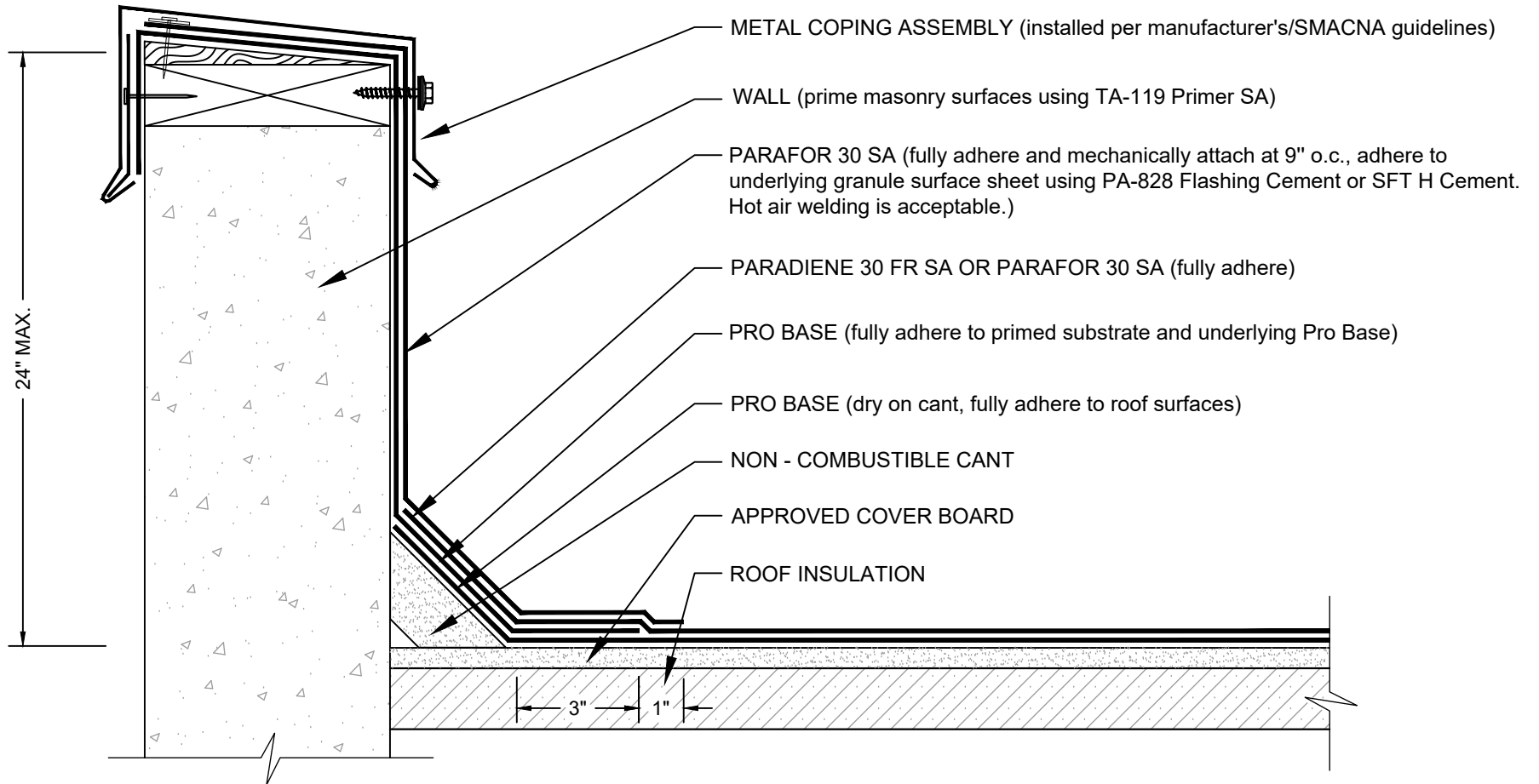

### NOTES:

1. FOR ADHESIVE APPLIED FLASHING APPLY GRANULE SURFACED FLASHING SHEETS IN PA-828 FLASHING CEMENT OR SFT H CEMENT. SFT H CEMENT IS REQUIRED FOR VERTICAL FLASHING SHEETS.
2. REQUIREMENTS AND RECOMMENDATIONS DETAILED IN CURRENT SIPLAST SPECIFICATIONS SHALL APPLY IN ADDITION TO THE ABOVE DRAWING.

CAUTION: SIPLAST RECOMMENDS THAT ALL PRACTICES PERTAINING TO INDUSTRY STANDARD TORCH SAFETY REQUIREMENTS AND GUIDELINES BE FOLLOWED. THIS INCLUDES PERFORMING A FIRE WATCH FOLLOWING ANY TORCH APPLICATIONS. ALWAYS HAVE APPROVED FIRE EXTINGUISHING EQUIPMENT NEARBY WHEN USING A TORCH.

Scale: NTS

REF: PARAPET WITH COPING - SBS SELF-ADHESIVE SYSTEM - INSULATED

**Detail Number:**  
DE-SBS-06-05a



14911 Quorum Drive, Suite 600 - Dallas, Texas - 75254 (800) 922-8800

[www.siplast.com](http://www.siplast.com)

**Rev:** 02.29.2024