

PARAGUARD EXPANSION JOINT (ROOF TO WALL)

PARADIENE 20/30 FR - LWIC

FLEXSEAL CAULK GRADE
SEALANT

REINFORCED LOOP
W/ BATT INSULATION

*SIPLAST WALLcontrol
SYSTEMS, INCLUDING
AIR BARRIER,
FLASHINGS AND
SEALANTS FOR
INTEGRATION WITH
WALLcontrol
STAINLESS STEEL
BUTYL-ADHERED
FLASHING (see note #1)

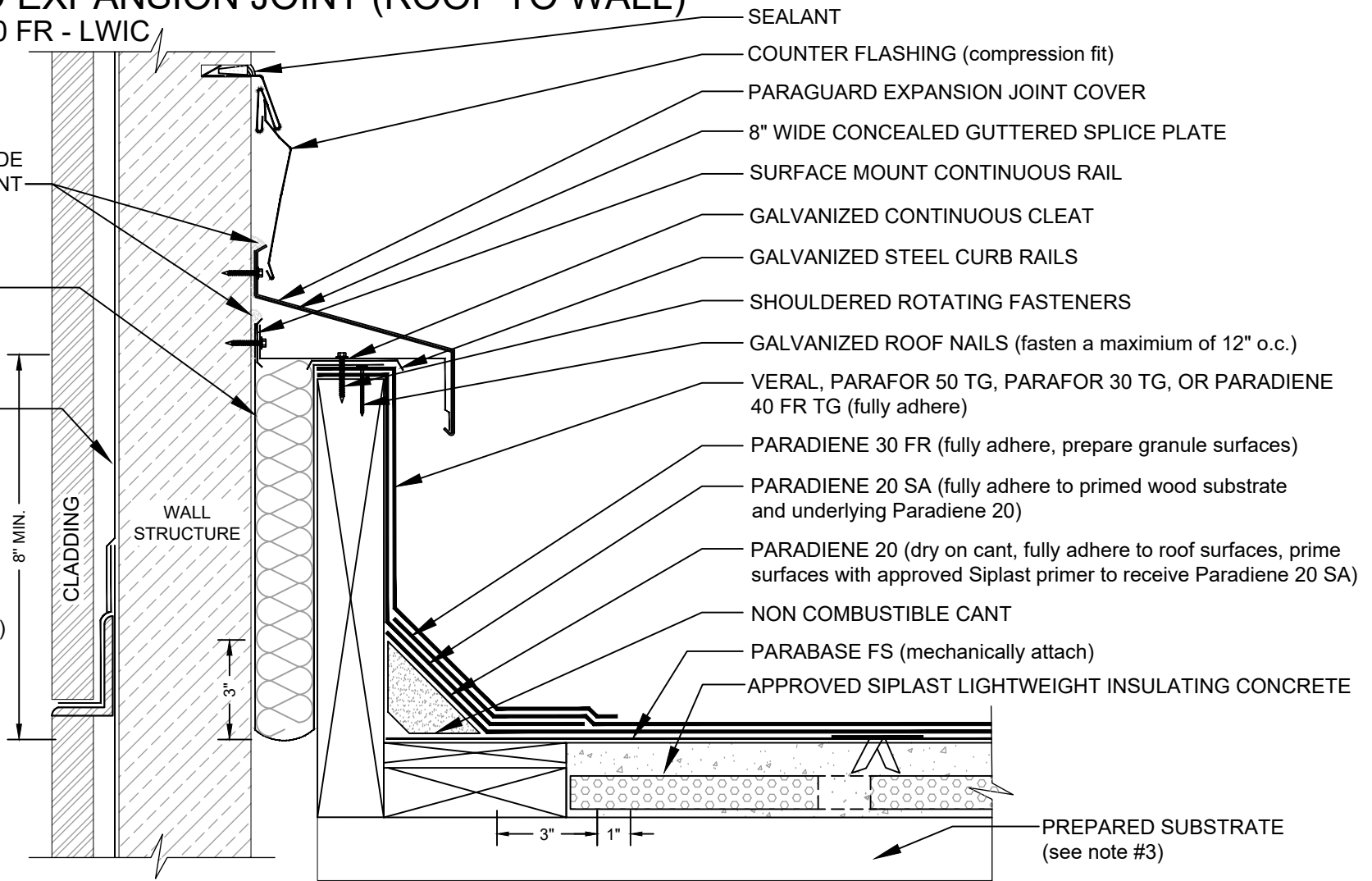

NOTES:

1. THE WALL STRUCTURE AND CLADDING DEPICTED REPRESENTS ONE COMMON VARIANT OF WALL CONSTRUCTION. THE WALL CONSTRUCTION INCLUDING MATERIALS USED AS AN AIR/MOISTURE BARRIER FOR A SPECIFIC PROJECT MAY DIFFER FROM THAT DEPICTED.
 2. REQUIREMENTS AND RECOMMENDATIONS DETAILED IN CURRENT SIPLAST SPECIFICATIONS SHALL APPLY IN ADDITION TO THE ABOVE DRAWING.
 3. REFERENCE THE SIPLAST TECHNICAL GUIDE FOR THE APPROPRIATE SIPLAST LIGHTWEIGHT INSULATING CONCRETE SYSTEM WITH REGARD TO SPECIFIC SUBSTRATE TYPES.
- CAUTION: SIPLAST RECOMMENDS THAT ALL PRACTICES PERTAINING TO INDUSTRY STANDARD TORCH SAFETY REQUIREMENTS AND GUIDELINES BE FOLLOWED. THIS INCLUDES PERFORMING A FIRE WATCH FOLLOWING ANY TORCH APPLICATIONS. ALWAYS HAVE APPROVED FIRE EXTINGUISHING EQUIPMENT NEARBY WHEN USING A TORCH.

Scale: NTS

REF: PARAGUARD EXPANSION JOINT (ROOF TO WALL) - 2030 - LWIC

Detail Number:
DE-SBS-01-06d



14911 Quorum Drive, Suite 600 - Dallas, Texas - 75254 (800) 922-8800

www.siplast.com

Rev: 11.26.2024