

PARAGUARD ROOF DRAIN

PARADIENE 20/30 FR - INSULATED

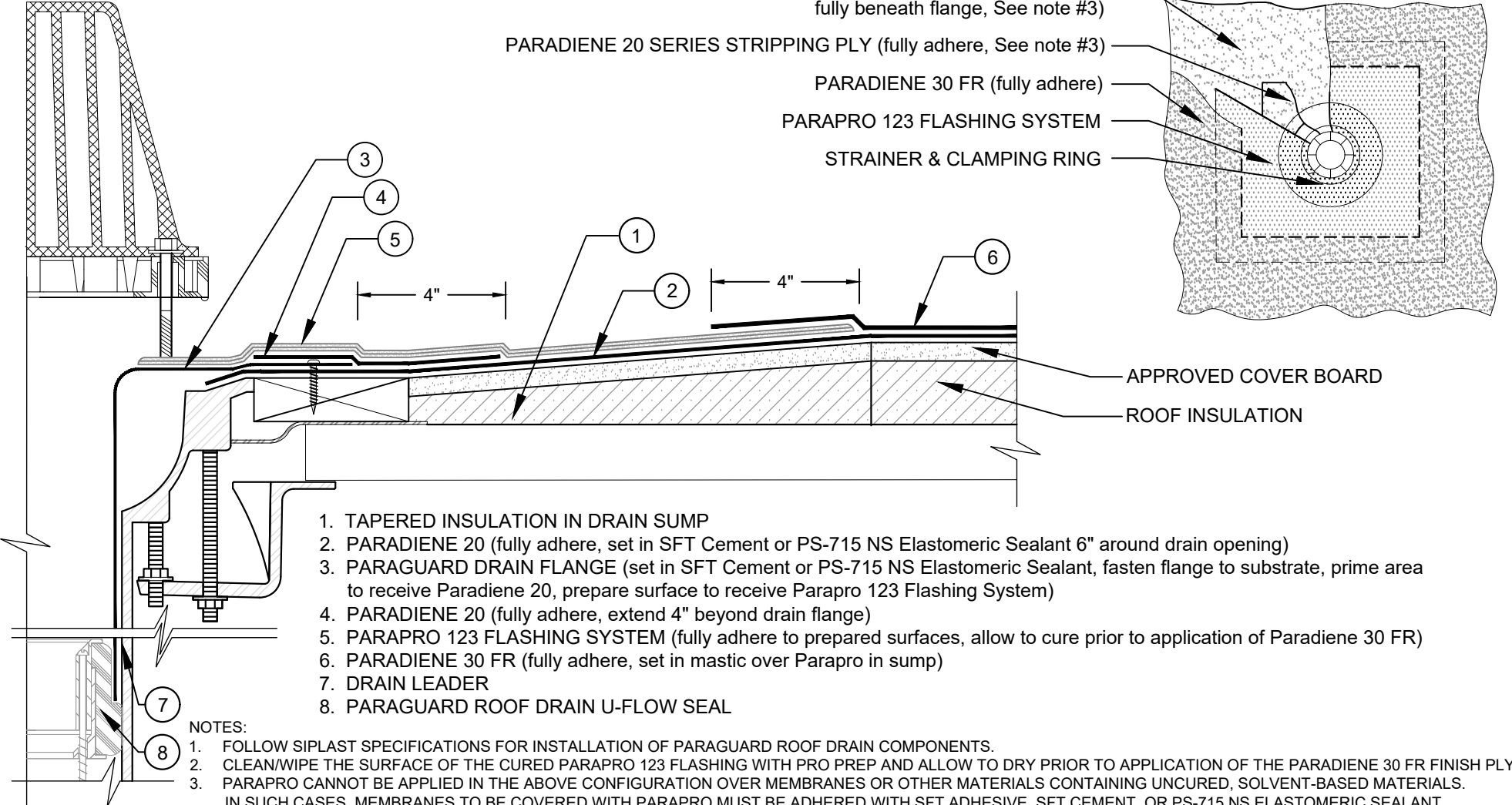

1. TAPERED INSULATION IN DRAIN SUMP

2. PARADIENE 20 (fully adhere, set in SFT Cement or PS-715 NS Elastomeric Sealant 6" around drain opening)

3. PARAGUARD DRAIN FLANGE (set in SFT Cement or PS-715 NS Elastomeric Sealant, fasten flange to substrate, prime area to receive Paradiene 20, prepare surface to receive Parapro 123 Flashing System)

4. PARADIENE 20 (fully adhere, extend 4" beyond drain flange)

5. PARAPRO 123 FLASHING SYSTEM (fully adhere to prepared surfaces, allow to cure prior to application of Paradiene 30 FR)

6. PARADIENE 30 FR (fully adhere, set in mastic over Parapro in sump)

7. DRAIN LEADER

8. PARAGUARD ROOF DRAIN U-FLOW SEAL

NOTES:

1. FOLLOW SIPLAST SPECIFICATIONS FOR INSTALLATION OF PARAGUARD ROOF DRAIN COMPONENTS.

2. CLEAN/WIPE THE SURFACE OF THE CURED PARAPRO 123 FLASHING WITH PRO PREP AND ALLOW TO DRY PRIOR TO APPLICATION OF THE PARADIENE 30 FR FINISH PLY.

3. PARAPRO CANNOT BE APPLIED IN THE ABOVE CONFIGURATION OVER MEMBRANES OR OTHER MATERIALS CONTAINING UNCURED, SOLVENT-BASED MATERIALS. IN SUCH CASES, MEMBRANES TO BE COVERED WITH PARAPRO MUST BE ADHERED WITH SFT ADHESIVE, SFT CEMENT, OR PS-715 NS ELASTOMERIC SEALANT. CONTACT SIPLAST FOR TREATMENT OPTIONS OF CONDITIONS UTILIZING A BASE PLY APPLIED IN SOLVENT BASED ADHESIVE.

4. REQUIREMENTS AND RECOMMENDATIONS DETAILED IN CURRENT SIPLAST SPECIFICATIONS AND THE PARAPRO 123 FLASHING SYSTEM INSTALLERS GUIDE SHALL APPLY IN ADDITION TO THE ABOVE DRAWING.

CAUTION: SIPLAST RECOMMENDS THAT ALL PRACTICES PERTAINING TO INDUSTRY STANDARD TORCH SAFETY REQUIREMENTS AND GUIDELINES BE FOLLOWED. THIS INCLUDES PERFORMING A FIRE WATCH FOLLOWING ANY TORCH APPLICATIONS. ALWAYS HAVE APPROVED FIRE EXTINGUISHING EQUIPMENT NEARBY WHEN USING A TORCH.

Scale: NTS

REF: PARAGUARD DRAIN - 2030 - INSULATED



14911 Quorum Drive, Suite 600 - Dallas, Texas - 75254 (800) 922-8800

www.siplast.com

Detail Number:
DE-SBS-00-02d

Rev: 11.26.2024