

# MECHANICAL HORIZONTAL TO VERTICAL JOINT

## TERAPRO VTS UNREINFORCED

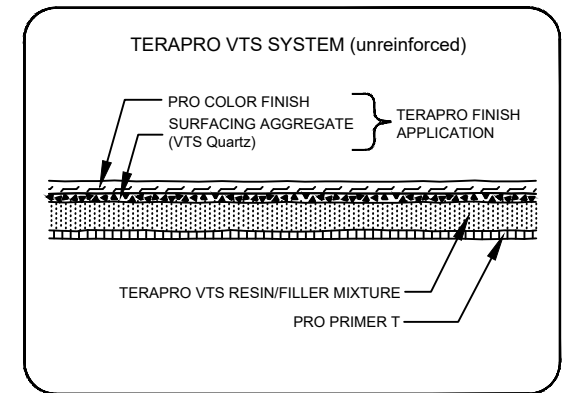
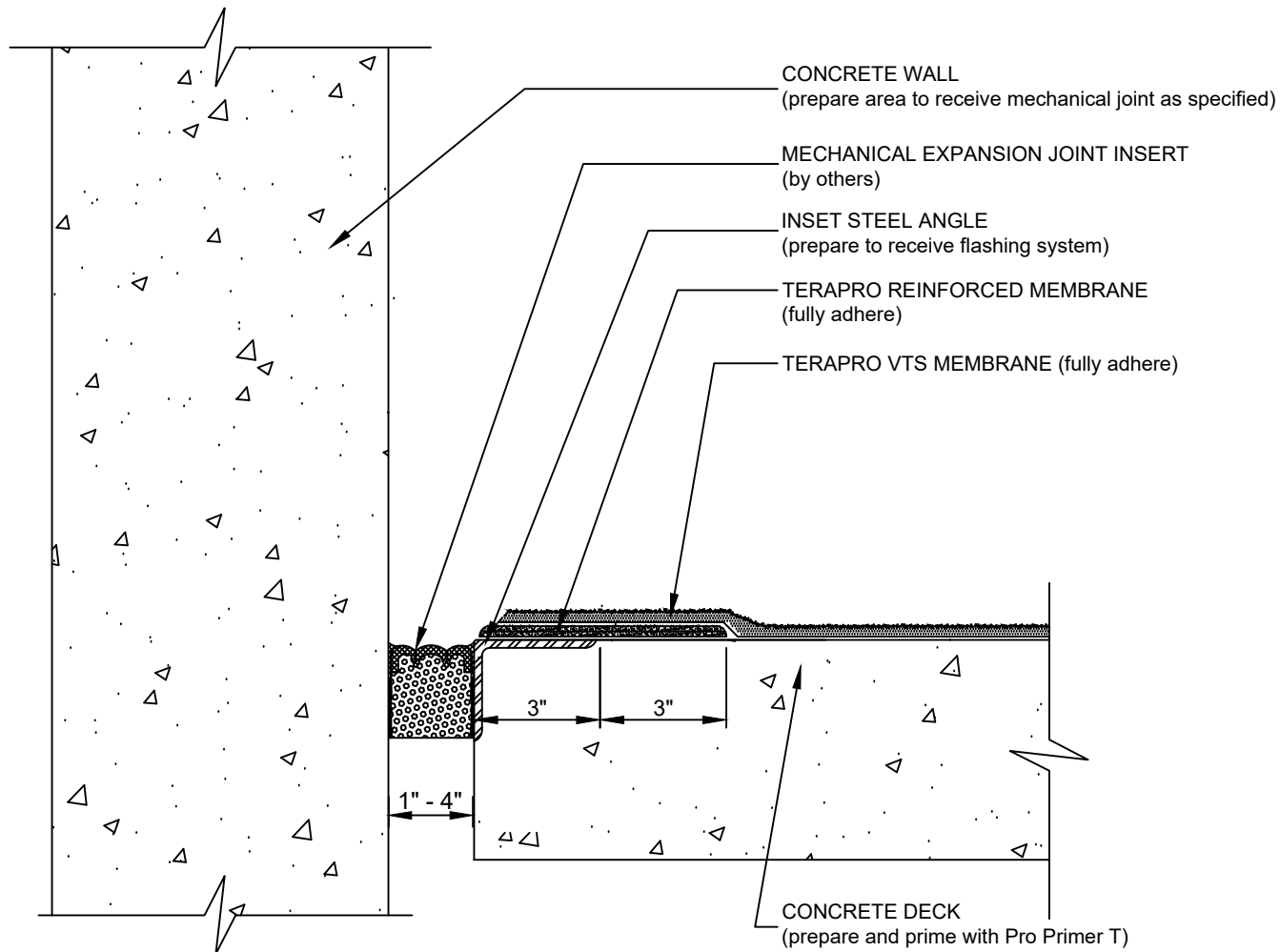

- NOTES:
1. REFER TO THE SPECIFICATIONS OF THE MECHANICAL EXPANSION JOINT MANUFACTURER FOR APPLICABILITY AND INSTALLATION GUIDELINES.
  2. REFER TO SIPLAST PREPARATION GUIDELINES FOR PROPER SURFACE TREATMENT OF ALL MATERIALS PRIOR TO APPLICATION OF TERAPRO MATERIAL. REQUIREMENTS AND RECOMMENDATIONS DETAILED IN TERAPRO VTS INSTALLATION SPECIFICATIONS SHALL APPLY IN ADDITION TO THE ABOVE DRAWING.

N.T.S.