

STANCHION W/ ANCHORED FOOTPLATE

TERAPRO VTS UNREINFORCED

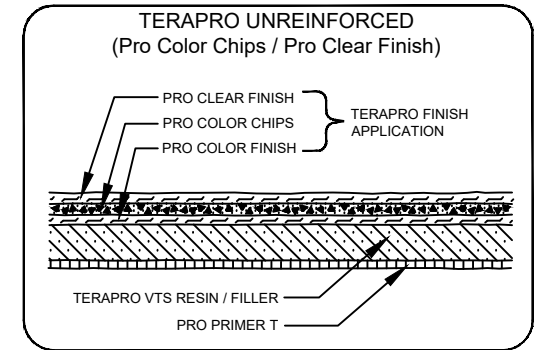
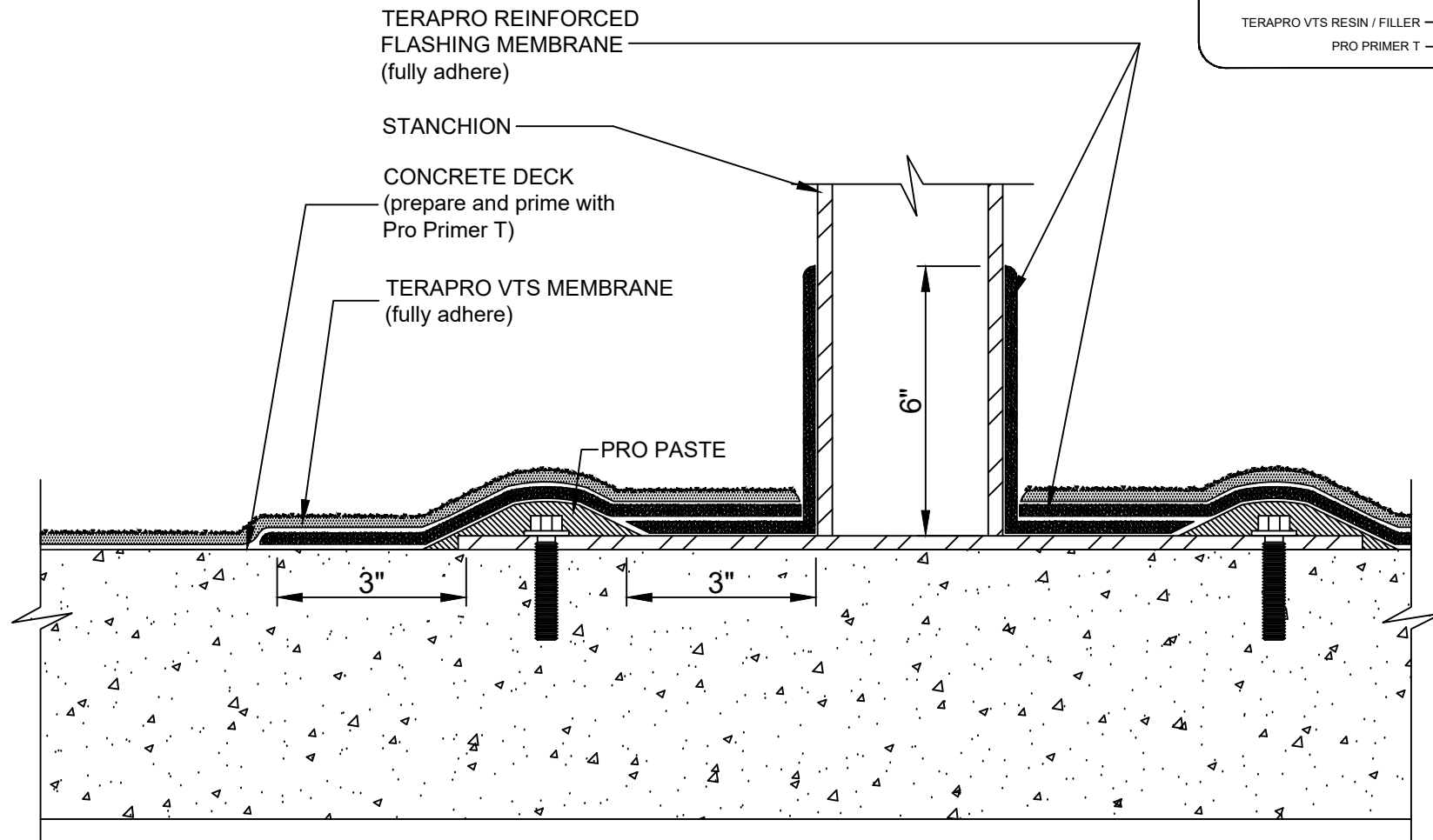

- NOTES:
1. REFER TO SIPLAST PREPARATION GUIDELINES FOR PROPER SURFACE TREATMENT OF ALL MATERIALS PRIOR TO APPLICATION OF TERAPRO MATERIAL.
 2. REQUIREMENTS AND RECOMMENDATIONS DETAILED IN TERAPRO VTS INSTALLATION SPECIFICATIONS SHALL APPLY IN ADDITION TO THE ABOVE DRAWING.

N.T.S.



1000 East Rochelle Boulevard - Irving, Texas - 75062 (800) 922-8800 www.siplast.com

Ref: Stanchion anchored footplate-UNTpro VTS

DE-LWM-31-03p