

TIE-IN WITH SAW CUT TERAPRO PUR - CONCRETE SUBSTRATE

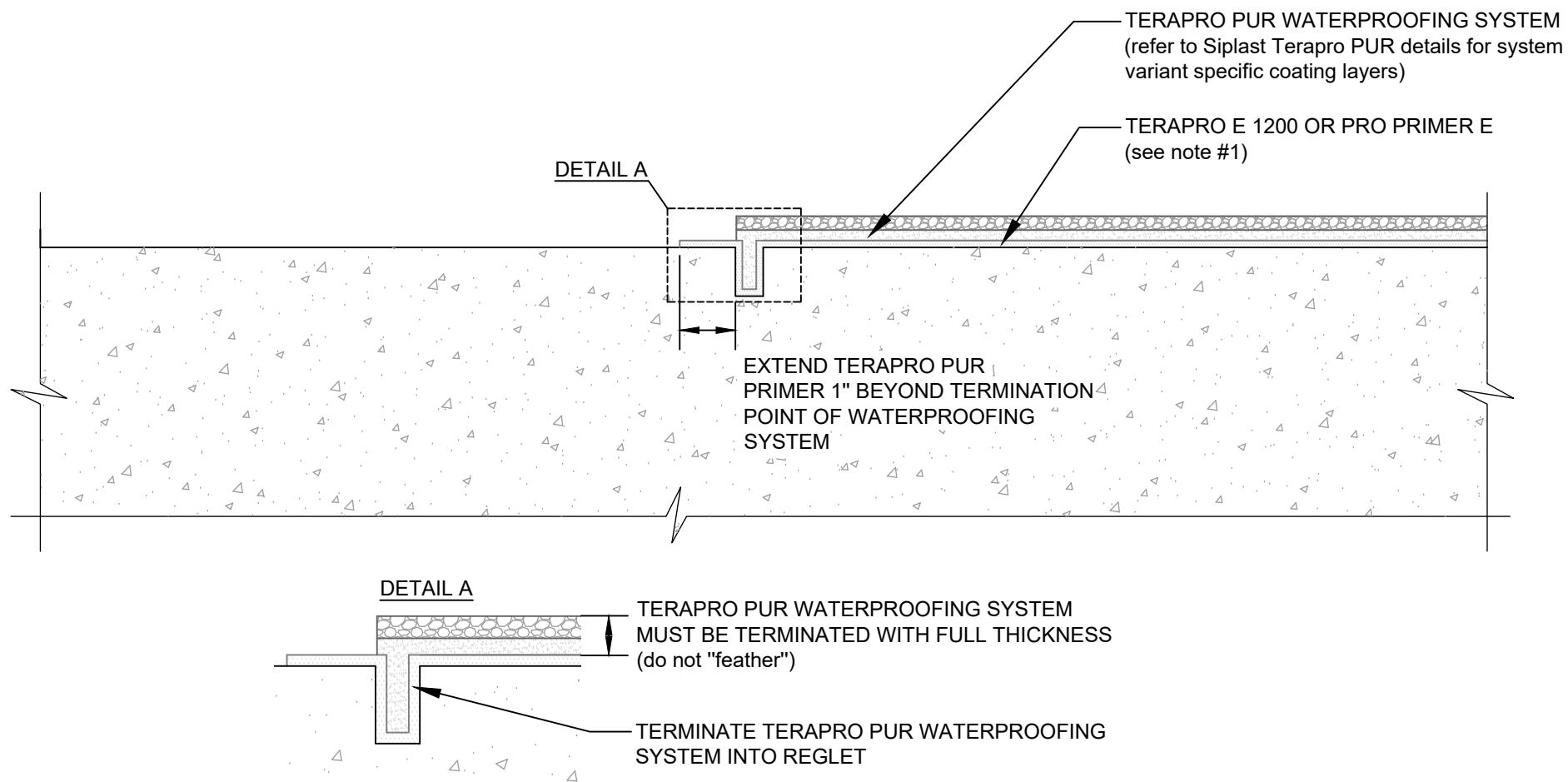

NOTES:

1. TERAPRO E 1200 MAY BE UTILIZED WHEN THE MOISTURE CONTENT OF THE CONCRETE SUBSTRATE IS LESS THAN 75% RH. PRO PRIMER E SHOULD BE UTILIZED WHEN THE MOISTURE CONTENT OF THE CONCRETE SUBSTRATE IS 75% RH OR GREATER. PRIMER SELECTION MAY BE AFFECTED BY OTHER FACTORS INCLUDING BUT NOT LIMITED TO ENVIRONMENTAL CONDITIONS, DESIRED OVERCOATING TIMES, ETC. CONTACT SIPLAST TECHNICAL SERVICES DEPARTMENT FOR ADDITIONAL INFORMATION.
2. THE TERAPRO PUR WATERPROOFING SYSTEM MUST BE TERMINATED WITH FULL THICKNESS (i.e. do not "feather"), METHODS TO ENSURE A FULL THICKNESS TERMINATION INCLUDE, BUT ARE NOT LIMITED TO, USING TAPE MASKING OR A TEMPORARY SHIELD. IF TAPE IS UTILIZED, INSTALLER MUST ENSURE THAT NO RESIDUAL TAPE IS REMAINING AFTER REMOVAL. SUCH A CONDITION LEAVES AN AREA OF UNBONDED MEMBRANE THAT MAY LEAD TO PREMATURE FAILURE OF THE WATERPROOFING SYSTEM.

Scale: NTS

REF: WATERPROOFING TERMINATION - HORIZONTAL SUBSTRATES - TERAPRO PUR - CONCRETE

Detail Number:
DE-LS-69-12c



14911 Quorum Drive, Suite 600 - Dallas, Texas - 75254 (800) 922-8800

www.siplast.com

Rev: 01.23.2025