

ROOF TO WALL EXPANSION JOINT w/RedLINE[®] WATERPROOF EXPANSION JOINT

PARAFLEX LIQUID MEMBRANE - CONCRETE SUBSTRATE

WATERPROOFING CONFIGURATION (shown without overburden)

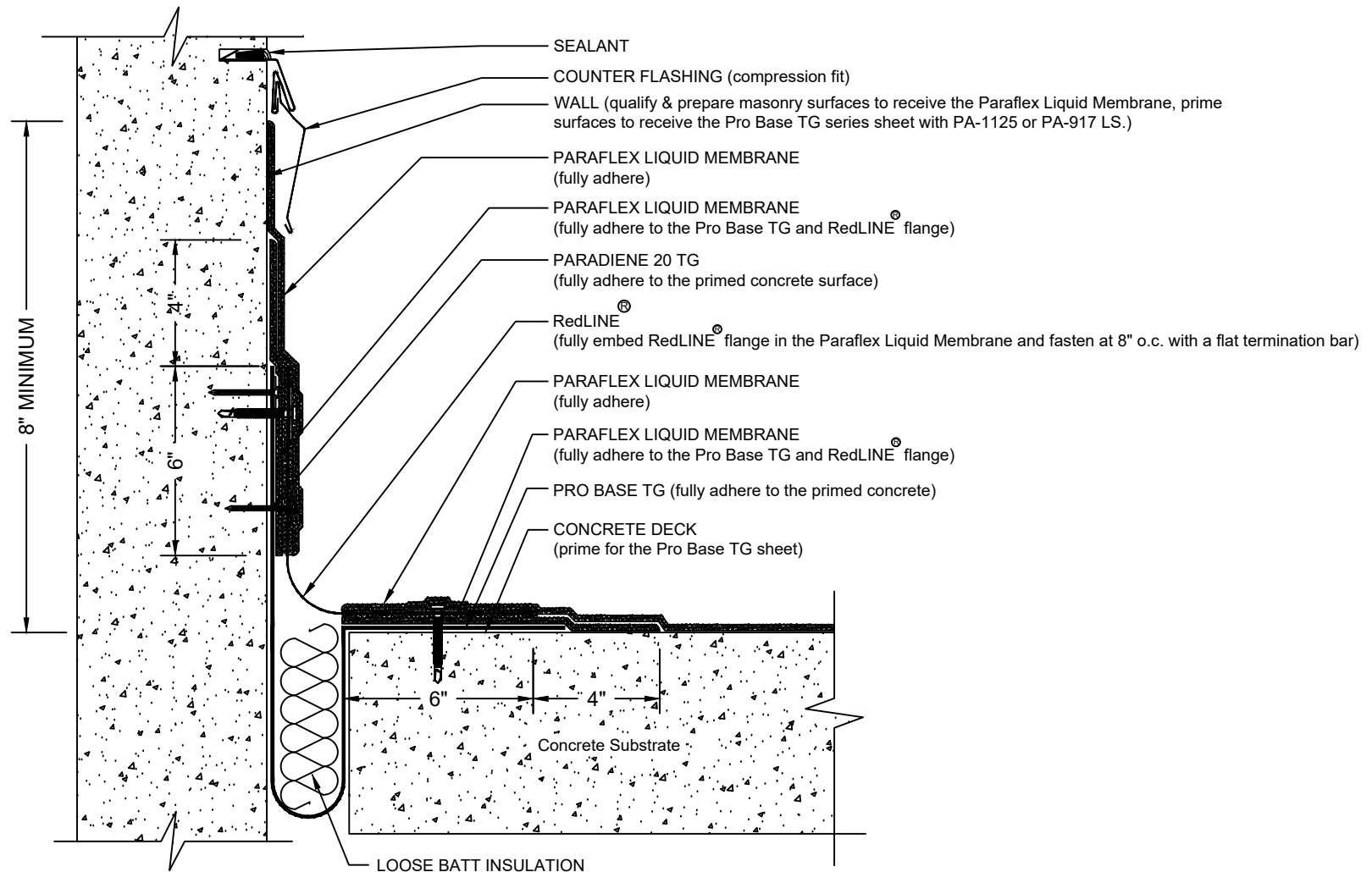

NOTES:

1. REFER TO SIPLAST PREPARATION GUIDELINES FOR PROPER SUBSTRATE TREATMENT OF ALL MATERIALS PRIOR TO APPLICATION OF PRO BASE & PARAFLEX LIQUID MATERIALS.
2. FOLLOW SITURA SPECIFICATIONS FOR SELECTION AND INSTALLATION OF THE APPROPRIATE REDLINE PRODUCT.
3. WHERE PRIMER IS INDICATED TO MAINTAIN PROPER ADHESION, TA-119 PRIMER IS REQUIRED FOR ALL PRO BASE SA SERIES FLASHING REINFORCING AND STRIPPING PLY APPLICATIONS. USE PA-1125 OR PA-917 LS PRIMER FOR ALL OTHER PRO BASE SERIES PRODUCTS THAT ARE NOT SELF-ADHESIVE SHEETS. CONTACT SIPLAST FOR SPECIFIC REQUIREMENTS.
4. PRIME THE BLEEDOUT AT SIDE AND END LAPS OF PRO BASE PLY SHEETS USING PRO PRIMER AC TO MAINTAIN A CONSISTENT AESTHETIC APPEARANCE OF THE FINISHED PARAFLEX SYSTEM.
5. REQUIREMENTS AND RECOMMENDATIONS DETAILED IN CURRENT SIPLAST AND SITURA SPECIFICATIONS SHALL APPLY IN ADDITION TO THE ABOVE DRAWING.
6. RedLINE[®] IS A REGISTERED TRADEMARK BRAND OF SITURA INC.

CAUTION: SIPLAST RECOMMENDS THAT ALL PRACTICES PERTAINING TO NRCA CERTA GUIDELINES BE FOLLOWED WHEN TORCHING METHODS ARE EMPLOYED. THIS INCLUDES PERFORMING A FIRE WATCH FOLLOWING ANY TORCH APPLICATIONS. ALWAYS HAVE APPROVED FIRE-EXTINGUISHING EQUIPMENT NEARBY.

N.T.S



1000 Rochelle Boulevard - Irving, Texas - 75062 (800) 922-8800 www.siplast.com

Ref: Roof to Wall RedLine-Pflex-Concrete - 04.02.19

DE-LRM-26-06j