

WALL FLASHING (MONOLITHIC DECK/WALL)

PARAFLEX LIQUID MEMBRANE - CONCRETE SUBSTRATE

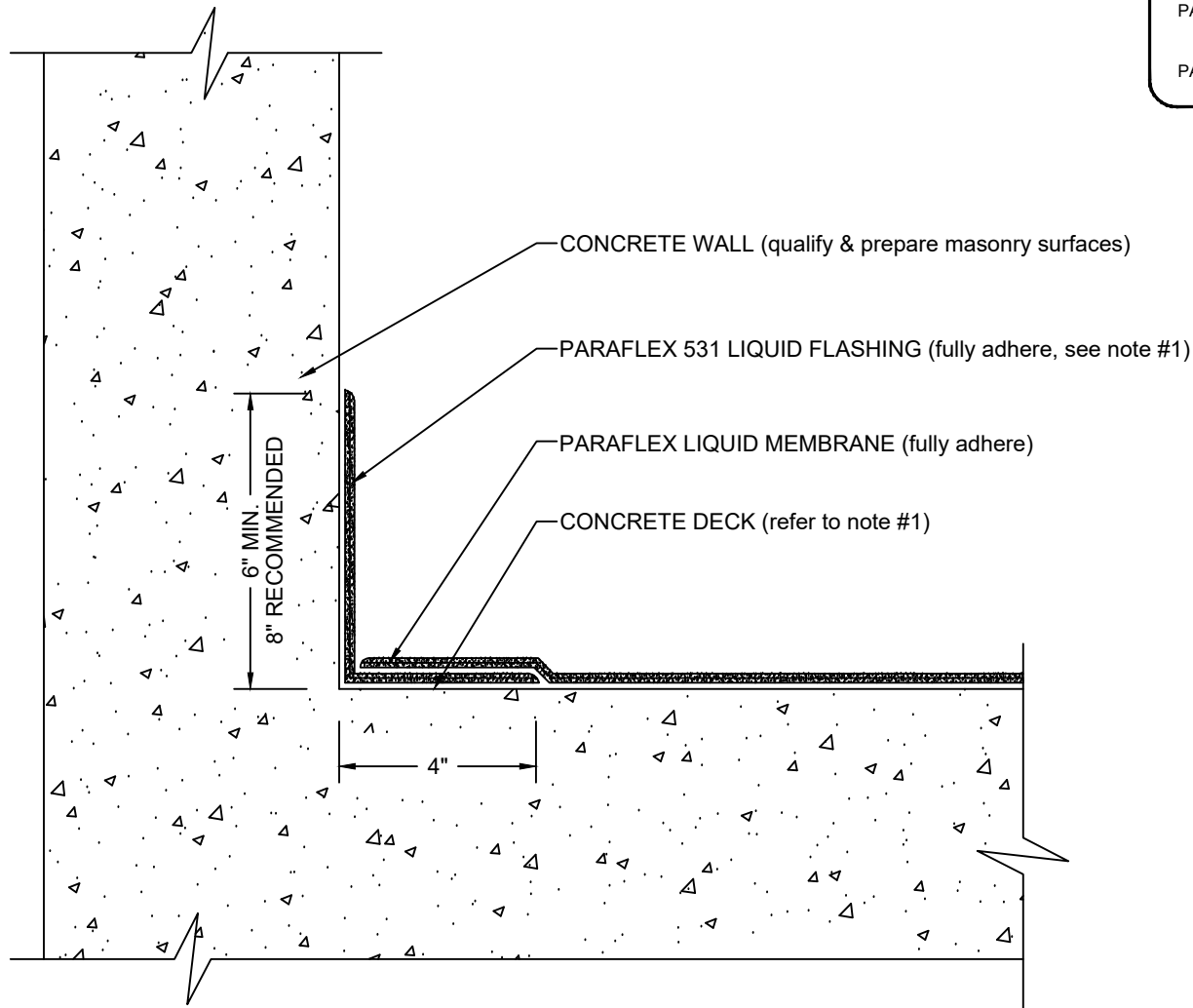

NOTES:

1. REFER TO SIPLAST PREPARATION GUIDELINES FOR PROPER SURFACE PREPARATION OF ALL SUBSTRATES PRIOR TO APPLICATION OF PARAFLEX MATERIALS.
2. REQUIREMENTS AND RECOMMENDATIONS DETAILED IN CURRENT SIPLAST SPECIFICATIONS AND THE PARAFLEX LIQUID MEMBRANE SYSTEM INSTALLER'S GUIDE SHALL APPLY IN ADDITION TO THE ABOVE DRAWING.

N.T.S



1000 Rochelle Boulevard - Irving, Texas - 75062 (800) 922-8800 www.siplast.com

Ref: Wall Flashing - Pflex - Concrete - 12.28.17

DE-LRM-26-05g