

ROOF TO WALL EXPANSION JOINT w/RedLINE® WATERPROOF EXPANSION JOINT  
PARAPRO ROOF MEMBRANE w/STRUCTURAL EPOXY PASTE ADHESIVE - CONCRETE SUBSTRATE  
WATERPROOFING CONFIGURATION (shown without overburden)

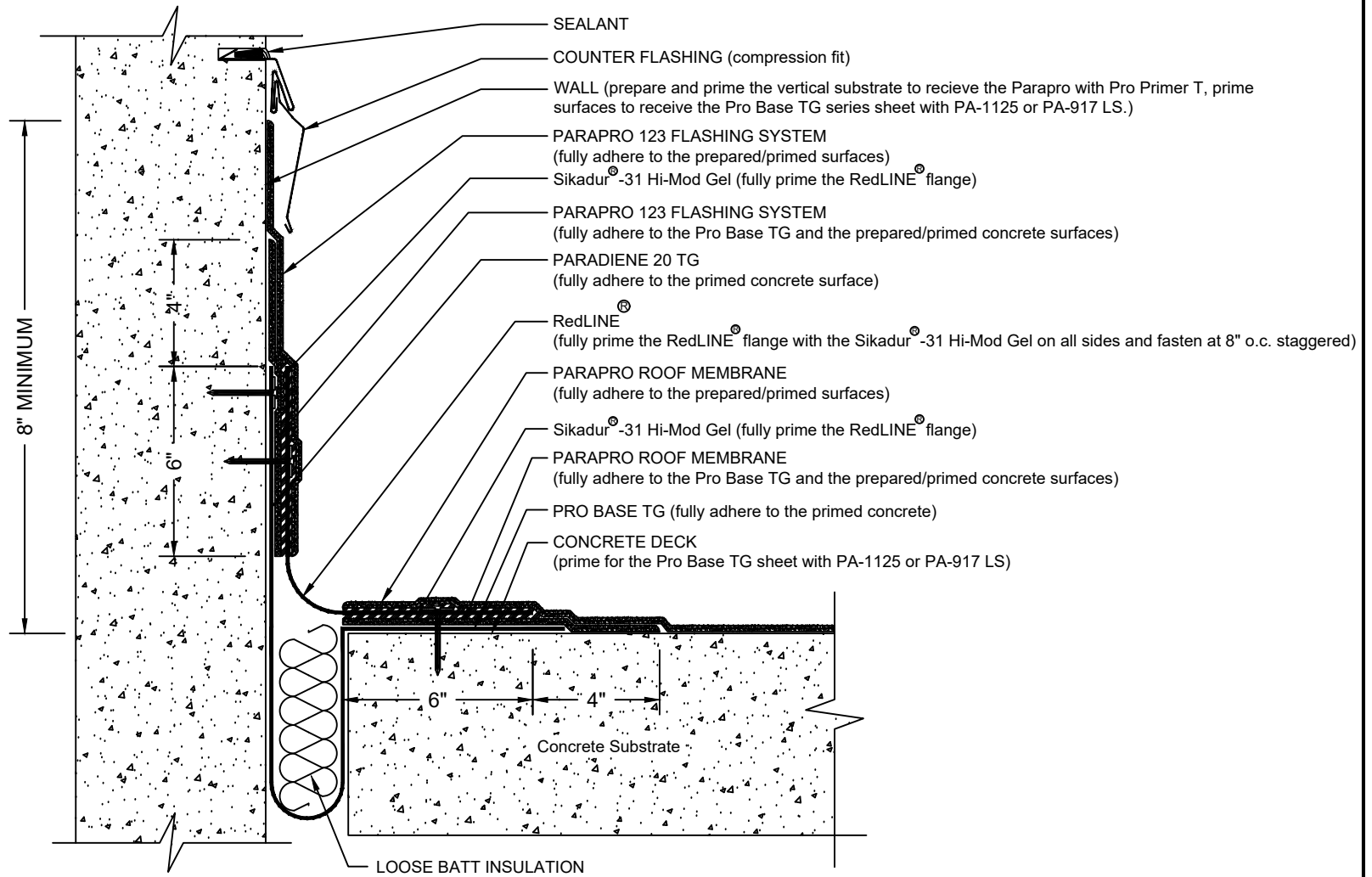

NOTES:

1. REFER TO SIPSIST PREPARATION GUIDELINES FOR PROPER SUBSTRATE TREATMENT OF ALL MATERIALS PRIOR TO APPLICATION OF PRO BASE & PARAPRO MATERIALS.
2. FOLLOW SITURA SPECIFICATIONS FOR SELECTION AND INSTALLATION OF THE APPROPRIATE REDLINE PRODUCT.
3. REQUIREMENTS AND RECOMMENDATIONS DETAILED IN CURRENT SIPSIST AND SITURA SPECIFICATIONS SHALL APPLY IN ADDITION TO THE ABOVE DRAWING.
4. **RedLine IS A REGISTERED TRADEMARK BRAND OF SITURA INC.**

CAUTION: SIPLAST RECOMMENDS THAT ALL PRACTICES PERTAINING TO NRCA CERTA GUIDELINES BE FOLLOWED WHEN TORCHING METHODS ARE EMPLOYED. THIS INCLUDES PERFORMING A FIRE WATCH FOLLOWING ANY TORCH APPLICATIONS. ALWAYS HAVE APPROVED FIRE-EXTINGUISHING EQUIPMENT NEARBY.

N.T.S