

ROOF TO ROOF EXPANSION JOINT w/RedLINE[®] WATERPROOF EXPANSION JOINT

PARAPRO ROOF MEMBRANE w/STRUCTURAL EXPOXY PASTE ADHESIVE - CONCRETE SUBSTRATE

WATERPROOFING CONFIGURATION (shown without overburden)

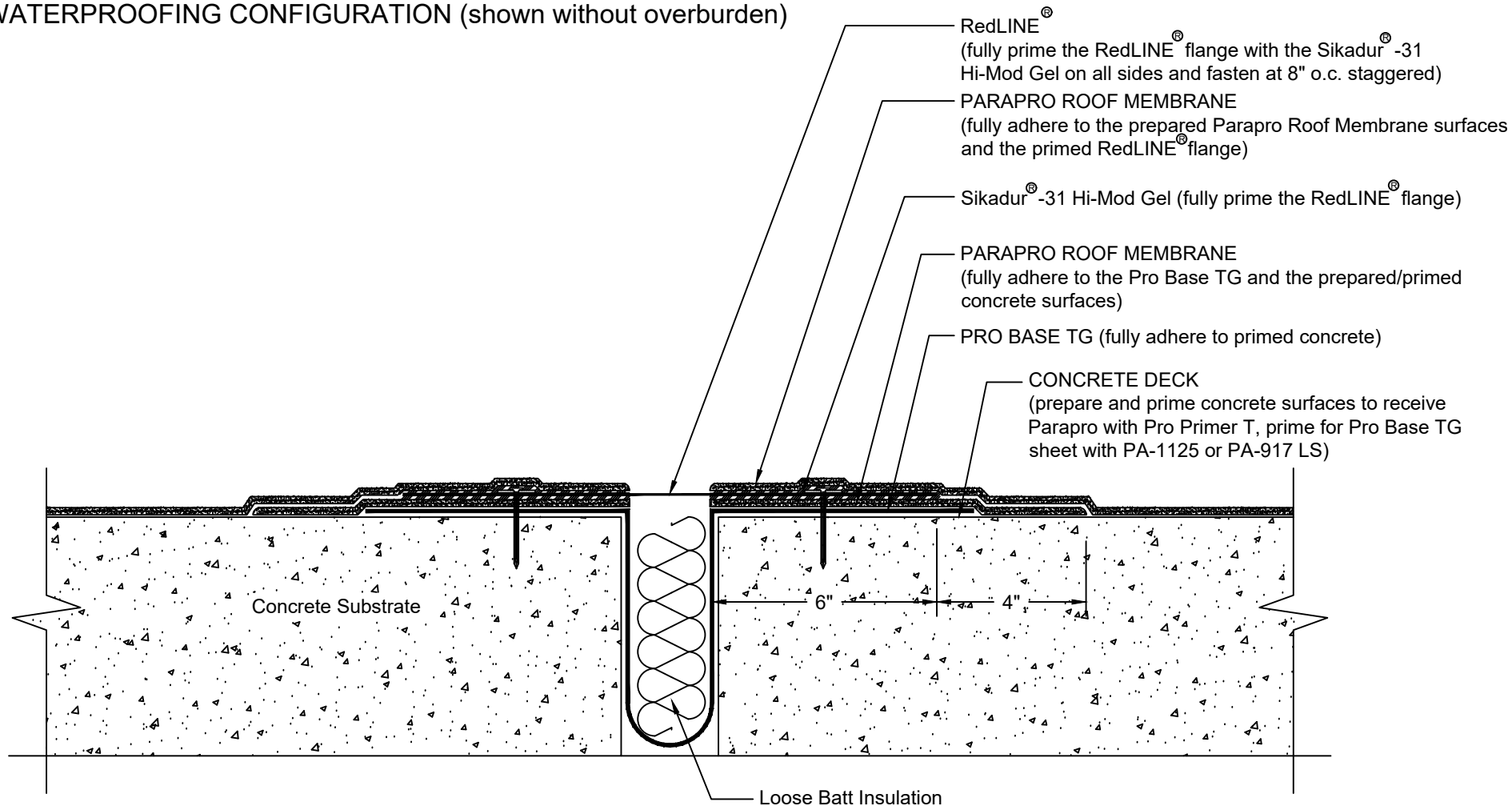

NOTES:

1. REFER TO SIPLAST PREPARATION GUIDELINES FOR PROPER SUBSTRATE TREATMENT OF ALL MATERIALS PRIOR TO APPLICATION OF PRO BASE, PARAPRO & PARAFLEX LIQUID MATERIALS.
2. FOLLOW SITURA SPECIFICATIONS FOR SELECTION AND INSTALLATION OF THE APPROPRIATE RedLINE PRODUCT.
3. REQUIREMENTS AND RECOMMENDATIONS DETAILED IN CURRENT SIPLAST AND SITURA SPECIFICATIONS SHALL APPLY IN ADDITION TO THE ABOVE DRAWING.
4. **RedLINE IS A REGISTERED TRADEMARK BRAND OF SITURA INC.**

CAUTION: SIPLAST RECOMMENDS THAT ALL PRACTICES PERTAINING TO NRCA CERTA GUIDELINES BE FOLLOWED WHEN TORCHING METHODS ARE EMPLOYED. THIS INCLUDES PERFORMING A FIRE WATCH FOLLOWING ANY TORCH APPLICATIONS. ALWAYS HAVE APPROVED FIRE-EXTINGUISHING EQUIPMENT NEARBY.

N.T.S



1000 Rochelle Boulevard - Irving, Texas - 75062 (800) 922-8800 www.siplast.com

Ref: Roof to Roof RedLine - Ppro - Conc 02.06.19 DE-LRM-17-06i