

# PENETRATION (SBS GRANULE SURFACE FLASHING)

## PA-750 HOT RUBBERIZED ASPHALT - CONCRETE SUBSTRATE

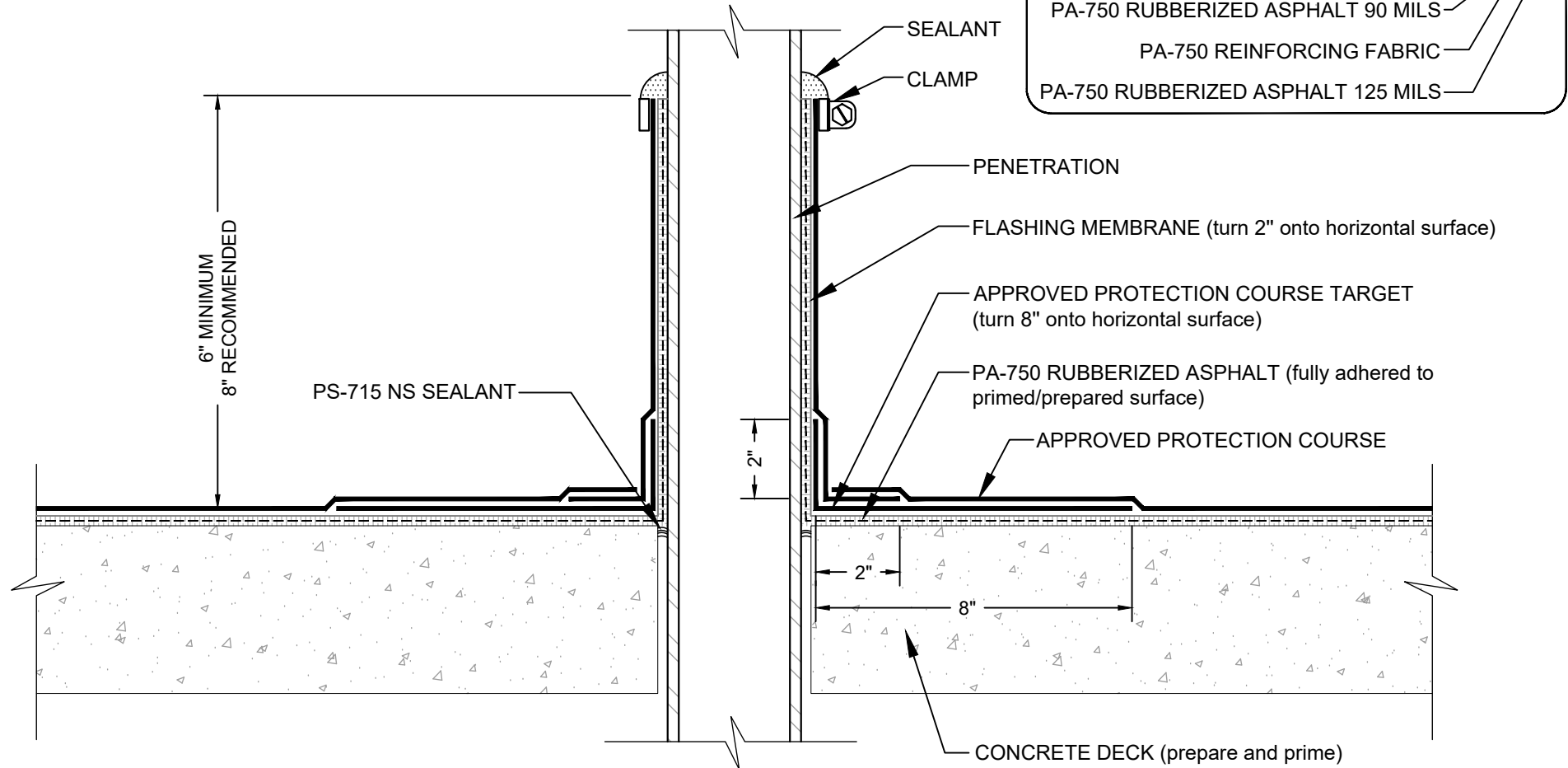

### NOTES:

1. ONE OF THE FOLLOWING PRIMERS: PA-1125 OR PA-917 PRIMER IS REQUIRED WHERE PRIMER IS INDICATED. CONTACT SIPLAST FOR SPECIFIC REQUIREMENTS.
2. REQUIREMENTS AND RECOMMENDATIONS DETAILED IN CURRENT SIPLAST SPECIFICATIONS, AND THE PA-750 HOT APPLIED RUBBERIZED ASPHALT SYSTEM INSTALLER'S GUIDE SHALL APPLY IN ADDITION TO THE ABOVE DRAWING.
3. CONSULT PA-750 HOT APPLIED RUBBERIZED ASPHALT SYSTEM SPECIFICATION PLATES FOR OVERBURDEN / PROTECTION SYSTEM OPTIONS.

Scale: NTS

REF: PENETRATION - SBS GRANULE SURFACE FLASHING - PA-750 - CONCRETE - PARAPRO

**Detail Number:**  
DE-HRA-40-03c



14911 Quorum Drive, Suite 600 - Dallas, Texas - 75254 (800) 922-8800

[www.siplast.com](http://www.siplast.com)

**Rev:** 01.22.2025