

# PARATECH SYSTEM

## PARATECH CAP-TORCH/BASE-HOT ASPHALT - PARABASE FS - LWIC/GYPSUM

\* click on the links below for more information\*

- [Specification](#)
- [Details](#)
- [Product Data Sheets](#)

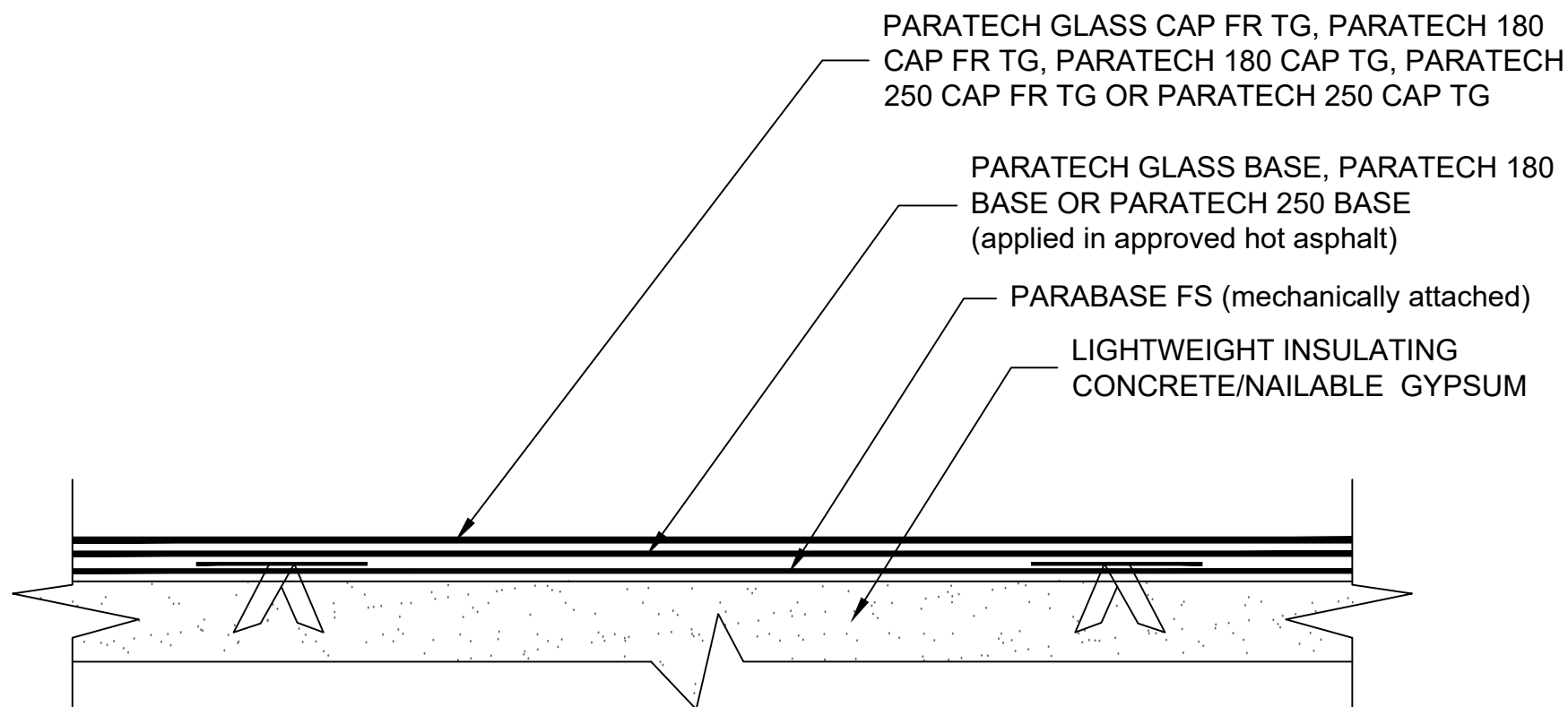

NOTES: 1. REQUIREMENTS AND RECOMMENDATIONS DETAILED IN SIPLAST SPECIFICATIONS SHALL APPLY IN ADDITION TO THE ABOVE DRAWING.

CAUTION: SIPLAST RECOMMENDS THAT ALL PRACTICES PERTAINING TO NRCA CERTA GUIDELINES BE FOLLOWED WHEN TORCHING METHODS ARE EMPLOYED. THIS INCLUDES PERFORMING A FIRE WATCH FOLLOWING ANY TORCH APPLICATIONS. ALWAYS HAVE APPROVED FIRE-EXTINGUISHING EQUIPMENT NEARBY.

N.T.S



14911 Quorum Drive, Suite 600 - Dallas, Texas - 75254 (800) 922-8800 [www.siplast.com](http://www.siplast.com)

Ref: Paratech Cap TG - Base Hot - Pbase - LWIC

Rev: 05.20.22