

PARASOLO ROOF MEMBRANE SYSTEMS

HYBRID SYSTEM

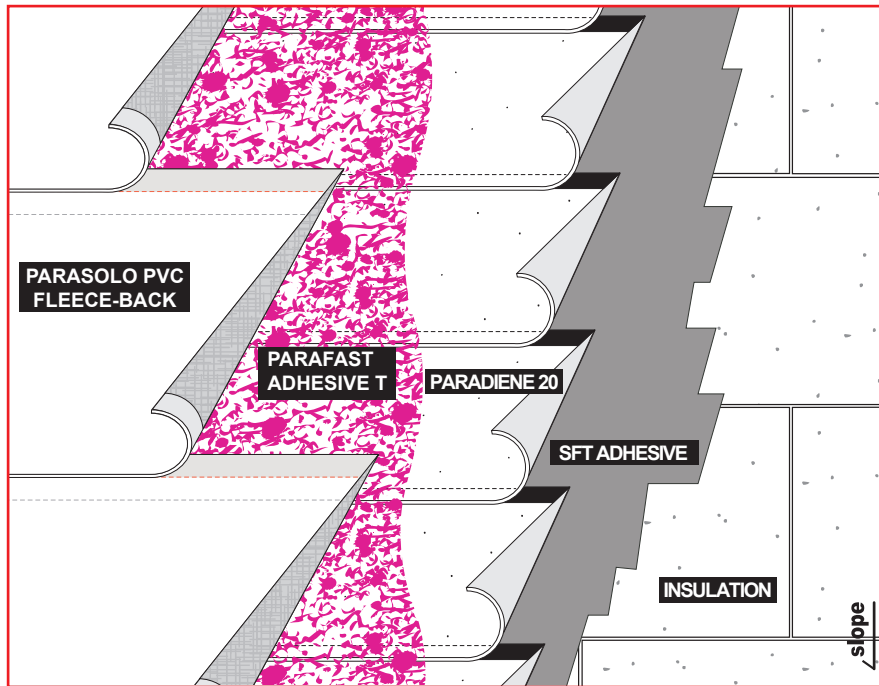

SLOPE	0" - 1" per ft.*
MATERIALS	per 100 sq. ft.
INSULATION	
SFT ADHESIVE	1 ½ - 2 ½ gal
PARADIENE 20	62 lb
PARAFAST ADHESIVE T	
PARASOLO PVC FLEECE-BACK	

* Contact Siplast for higher slope requirements.

n.t.s.

Specification: SPFANI20A-ALL - All thicknesses - Fleece-Back

Requirements and recommendations detailed in the Siplast catalog and Siplast long form specifications shall apply in addition to the following recommendations and specifications.

Application

1. Install insulation panels according to manufacturer's recommendations and FM Global requirements, if applicable. The edges of insulation panels should be in moderate contact without forcing and cut to fit neatly against adjoining surfaces. The insulation layer should present a smooth surface to accept the roof membrane.
2. Beginning at the low point of the roof, lay one ply of the Paradiene 20 in a full coating of SFT Adhesive, lapping sides and ends a minimum of 3 inches. Offset end laps a minimum of 3 feet.
3. Lay one ply of Parasolo Fleece-Back membrane in a "spatter pattern" of Parafast T Adhesive without wrinkles or buckles, keeping adhesive away from the lap of the adjoining course of Parasolo. Apply the Parafast Adhesive T in a "spatter pattern" over the substrate to yield a heavily textured, even coating of approximately 1/4- inch to 1/2- inch nominal thickness height on the peaks of the spattered adhesive. Allow the adhesive to rise and apply the roof membrane before the adhesive begins to "skin" over. Lap Parasolo membrane at sides a minimum of 3 inches. Butt adjacent sheets at end joints.
4. Weld Parasolo Fleece-Back membrane side laps using approved welding equipment and in accordance with heat-welding guidelines.
5. Seam the end joints between adjacent sheets by heat welding an 8 inch wide Parasolo PVC smooth reinforced membrane flashing strip.

Ref. #: Parasolo Fleeceback-Parafast Adh T - P20-SFT - Rigid
Rev: 01.30.20



1000 Rochelle Boulevard Irving, Texas 75062 (800) 922-8800 FAX (469) 995-2206