

# PARASOLO ROOF MEMBRANE SYSTEMS

## HYBRID SYSTEM

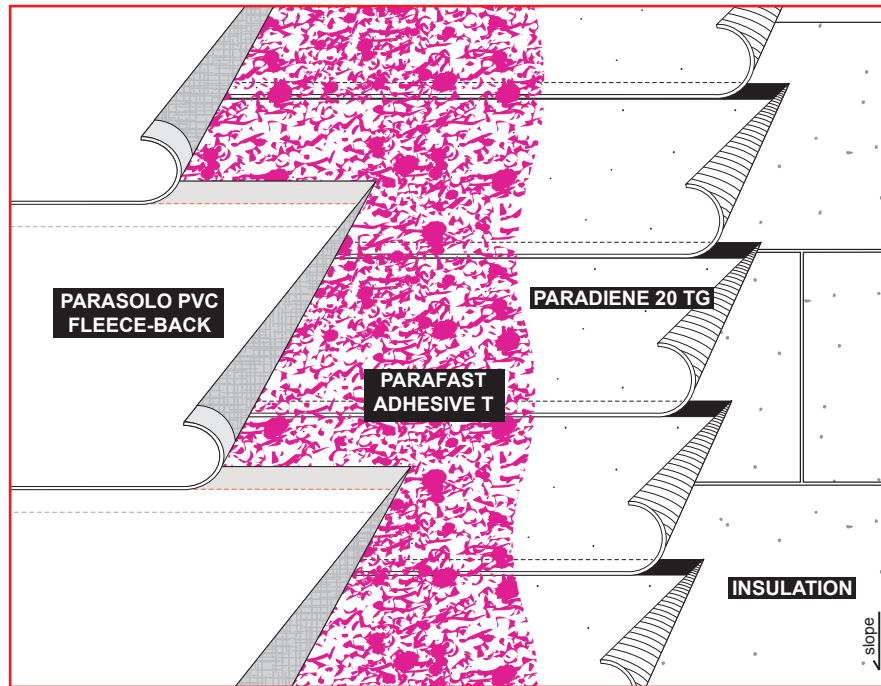

SLOPE	0" - 1" per ft.*
MATERIALS	per 100 sq. ft.
INSULATION	
PARADIENE 20 TG	76 lb
PARAFAST ADHESIVE T	
PARASOLO PVC FLEECE-BACK	

\* Contact Siplast for higher slope requirements.

n.t.s.

**Specification: SPFA20IT-ALL - All thicknesses - Fleece-Back**

**Requirements and recommendations detailed in the Siplast catalog and Siplast long form specifications shall apply in addition to the following recommendations and specifications.**

### Application

1. Install insulation panels according to manufacturer's recommendations and FM Global requirements, if applicable. The edges of insulation panels should be in moderate contact without forcing and cut to fit neatly against adjoining surfaces. The insulation layer should present a smooth surface to accept the roof membrane.
2. Beginning at the low point of the roof, fully torch one ply of the Paradiene 20 TG to the insulation surface, lapping sides and ends a minimum of 3 inches. Offset end laps a minimum of 3 feet.
3. Lay one ply of Parasolo Fleece-Back membrane in a "spatter pattern" of Parafast T Adhesive without wrinkles or buckles, keeping adhesive away from the lap of the adjoining course of Parasolo. Apply the Parafast Adhesive T in a "spatter pattern" over the substrate to yield a heavily textured, even coating of approximately 1/4- inch to 1/2- inch nominal thickness height on the peaks of the spattered adhesive. Allow the adhesive to rise and apply the roof membrane before the adhesive begins to "skin" over. Lap Parasolo membrane at sides a minimum of 3 inches. Butt adjacent sheets at end joints.
4. Weld Parasolo Fleece-Back membrane side laps using approved welding equipment and in accordance with heat-welding guidelines.
5. Seam the end joints between adjacent sheets by heat welding an 8 inch wide Parasolo PVC smooth reinforced membrane flashing strip.

**Caution:** Siplast recommends that all practices pertaining to NRCA CERTA guidelines be followed when torching methods are employed. This includes performing a fire watch following any torch applications. Always have approved fire-extinguishing equipment nearby.

Ref. #: Parasolo Fleece-Back - Parafast Adh T - P20TG - Rigid  
Rev: 01.30.20



1000 Rochelle Boulevard Irving, Texas 75062 (800) 922-8800 FAX (469) 995-2206