

PROJECT:

CLICK ON THE LINKS BELOW FOR MORE INFORMATION

- [PARASOLO PVC SPECIFICATION](#)
- [PARASOLO TPX SPECIFICATION](#)
- [DETAILS](#)
- [PRODUCT DATA SHEETS](#)

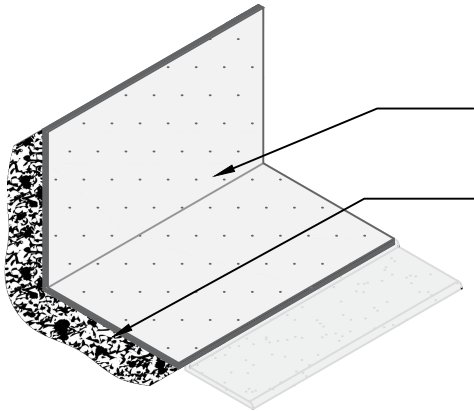

FLASHING ASSEMBLY

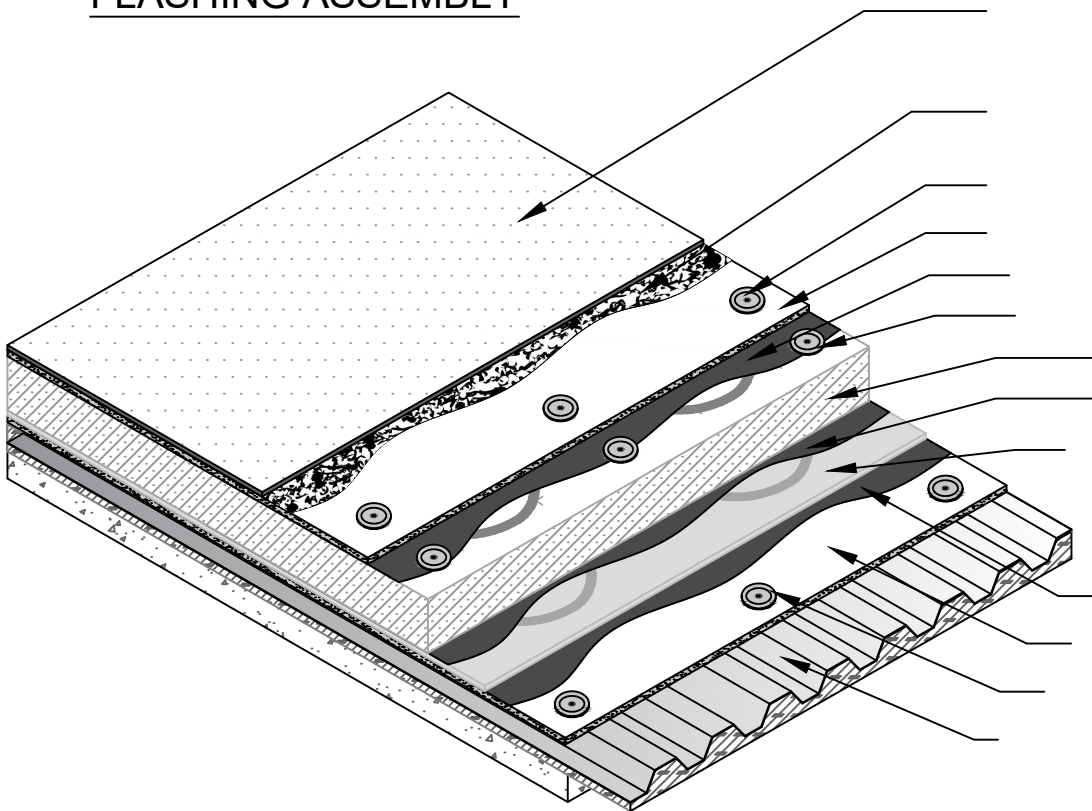

ROOF ASSEMBLY

1. SIPLAST STANDARD SPECIFICATIONS AND REQUIREMENTS SHALL APPLY IN ADDITION TO THIS DRAWING.
2. SIPLAST RECOMMENDS THAT ALL PRACTICES PERTAINING TO INDUSTRY STANDARD TORCH SAFETY REQUIREMENTS AND GUIDELINES BE FOLLOWED. THIS INCLUDES PERFORMING A FIRE WATCH FOLLOWING ANY TORCH APPLICATIONS. ALWAYS HAVE APPROVED FIRE EXTINGUISHING EQUIPMENT NEARBY WHEN USING A TORCH.

USE ADOBE READER TO TURN OFF/ON LAYERS THAT DO NOT APPLY

Scale: NTS

PARASOLO ADHERED - INSULATED SUBSTRATE

Detail Number:
DD - 6203



14911 Quorum Drive, Suite 600 - Dallas, Texas - 75254 (800)
922-8800

www.siplast.com

Rev: 07.14.23