

PROJECT:

\*CLICK ON THE LINKS BELOW FOR MORE INFORMATION\*

- [SPECIFICATION](#)
- [DETAILS](#)
- [PRODUCT DATA SHEETS](#)

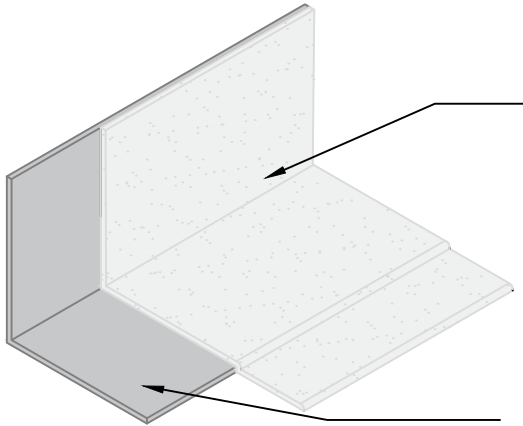

## FLASHING ASSEMBLY

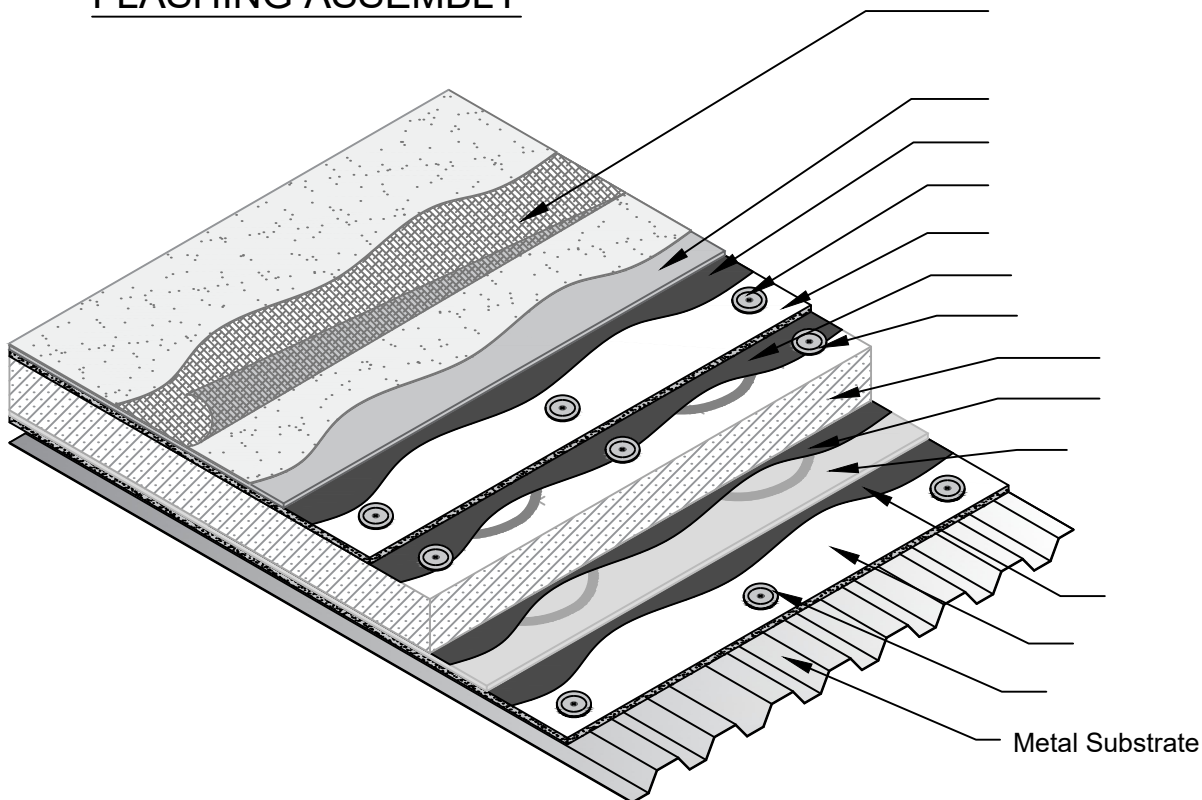

## ROOF ASSEMBLY

1. SIPLAST STANDARD SPECIFICATIONS AND REQUIREMENTS SHALL APPLY IN ADDITION TO THIS DRAWING.
2. SIPLAST RECOMMENDS THAT ALL PRACTICES PERTAINING TO INDUSTRY STANDARD TORCH SAFETY REQUIREMENTS AND GUIDELINES BE FOLLOWED. THIS INCLUDES PERFORMING A FIRE WATCH FOLLOWING ANY TORCH APPLICATIONS. ALWAYS HAVE APPROVED FIRE EXTINGUISHING EQUIPMENT NEARBY WHEN USING A TORCH.
3. \*WHEN PRIMER IS REQUIRED FOR APPLICATION OF SIPLAST SA VAPOR RETARDER, USE TA-119 PRIMER OR TA-325 PRIMER.

**\*USE ADOBE READER TO TURN OFF/ON LAYERS THAT DO NOT APPLY\***

Scale: NTS

LIQUID APPLIED - INSULATED - METAL DECK

**Detail Number:**  
**DD - 3201**



14911 Quorum Drive, Suite 600 - Dallas, Texas - 75254 (800)  
922-8800

[www.siplast.com](http://www.siplast.com)

**Rev:** 12.12.23