

# STAGGERED INSULATION BOARD LAYOUT

## INSULATION (ALL SIPLAST ROOF SYSTEMS)

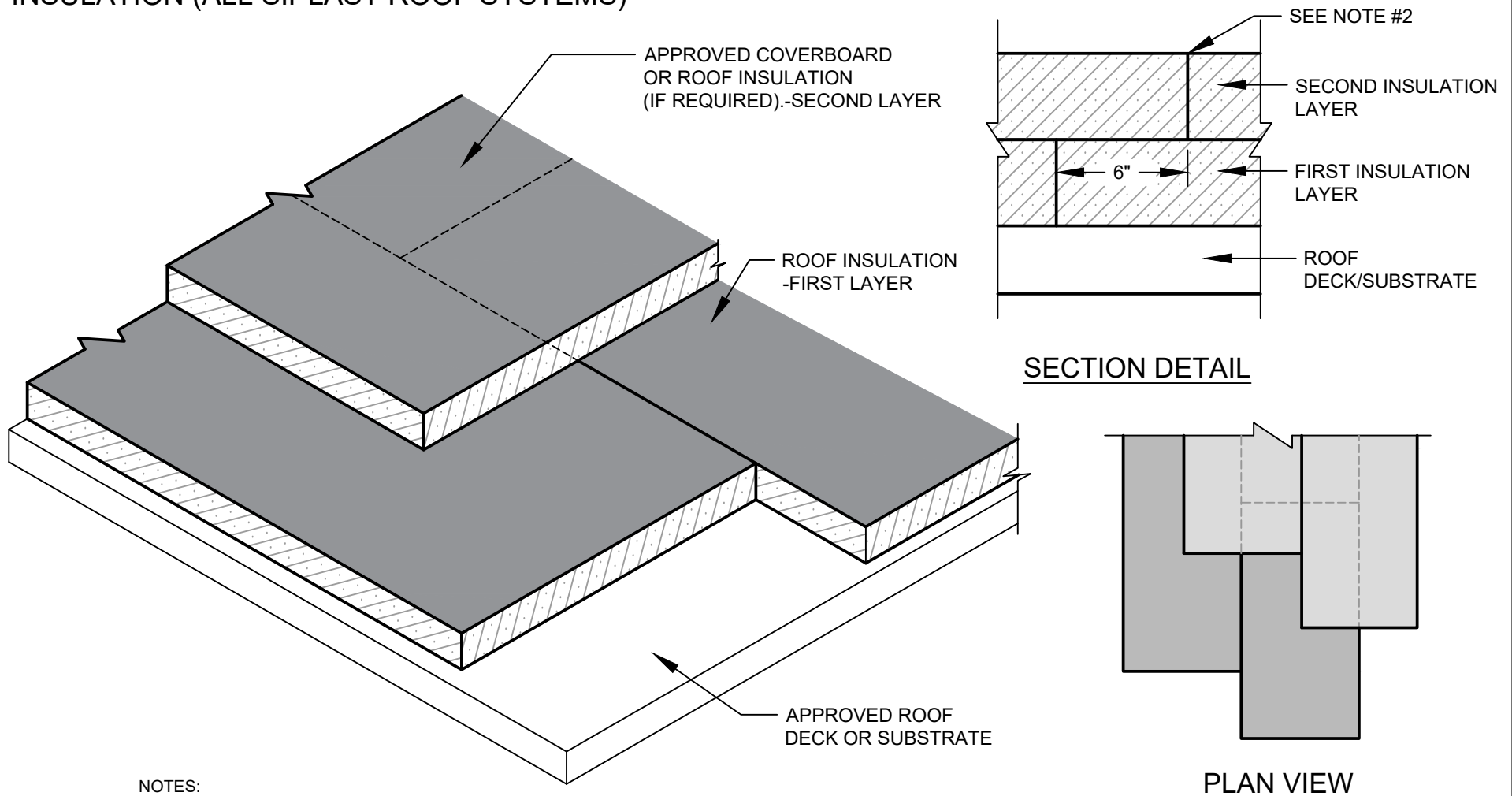

### NOTES:

1. REFER TO SIPLAST DESIGN & APPLICATION GUIDELINES FOR DETAILED INSTALLATION REQUIREMENTS.
2. INSULATION BOARDS INSTALLED IN SINGLE OR MULTIPLE LAYERS MUST HAVE THE JOINTS BETWEEN THE BOARDS STAGGERED IN ALL DIRECTIONS A MINIMUM OF 6" (152 mm) BETWEEN LAYERS.
3. INSULATION BOARDS INSTALLED OVER STEEL DECKING MUST HAVE BOARDS PLACED PERPENDICULAR TO DECK FLUTES WITH EDGES OVER FLUTE SURFACE FOR BEARING SUPPORT.

Scale: NTS

INSULATION BOARD LAYOUT

Detail Number:  
DE-6200



14911 Quorum Drive, Suite 600 - Dallas, Texas - 75254 (800) 922-8800

[www.siplast.com](http://www.siplast.com)

Rev: 06.08.2023