

# FIELD-WRAPPED PIPE PENETRATION PARASOLO ROOF MEMBRANE - INSULATED (ALL SYSTEMS)

LEGEND	
	HEAT WELD
	SEALANT

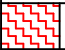
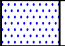
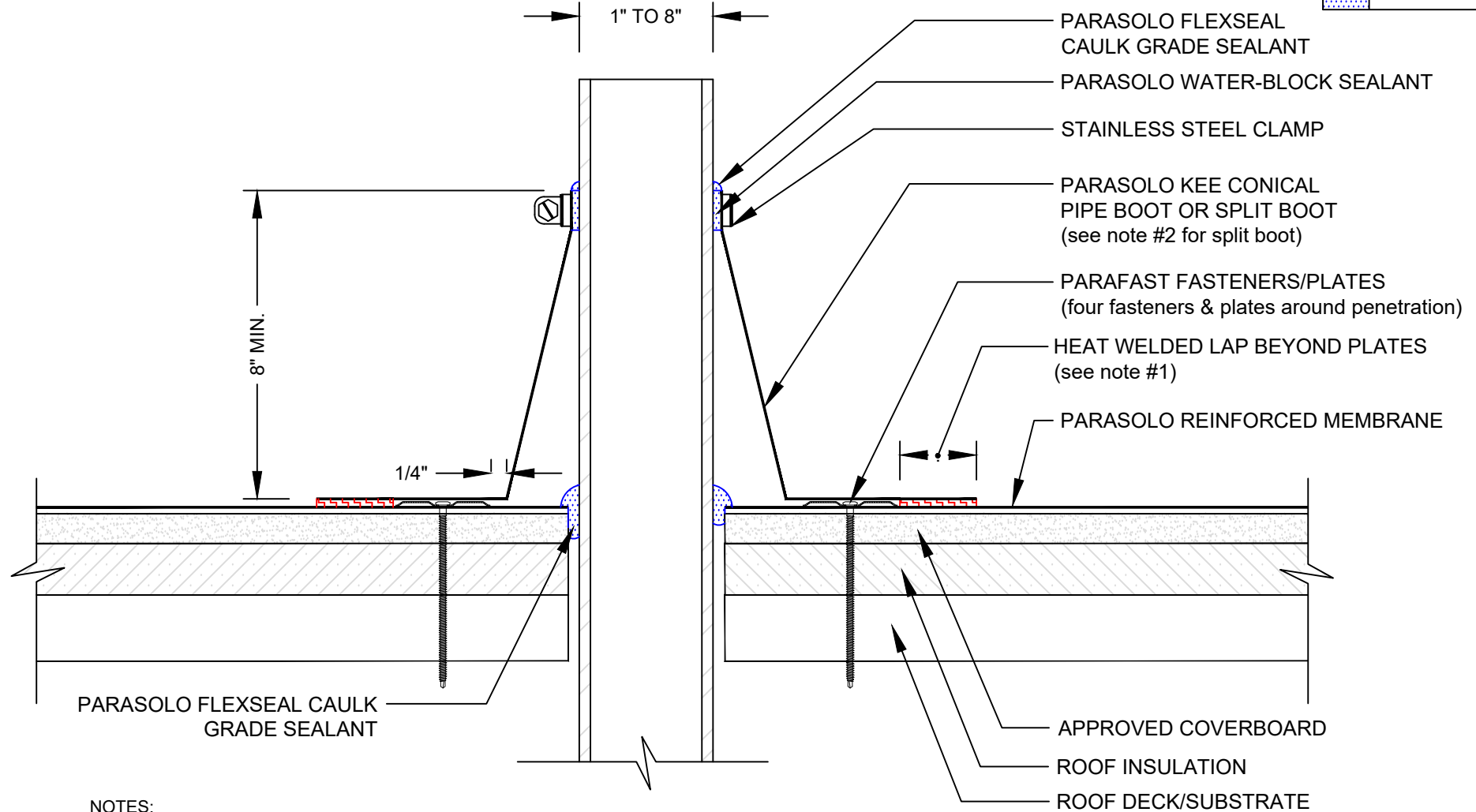

## NOTES:

1. FOR HEAT-WELDED LAP USE 1" MINIMUM TO 1-1/2" MAXIMUM WELD.
2. IF PLATES AND FASTENERS ENCROACH INTO THE SEAM AREA OF THE POCKET, A TARGET MUST BE ADDED FIRST TO COVER FASTENERS.
3. REQUIREMENTS AND RECOMMENDATIONS DETAILED IN CURRENT SIPLAST SPECIFICATIONS SHALL APPLY IN ADDITION TO THE ABOVE DRAWING.

Scale: NTS

REF: FIELD WRAPPED PIPE PENETRATION - PARASOLO - INSULATED

Detail Number:  
DE-6238



14911 Quorum Drive, Suite 600 - Dallas, Texas - 75254 (800) 922-8800

[www.siplast.com](http://www.siplast.com)

Rev: 06.08.2023