

WALL FLASHING (MONOLITHIC WALL/DECK)

TERAPRO 220/250 SURFACING SYSTEM - CONCRETE SUBSTRATE

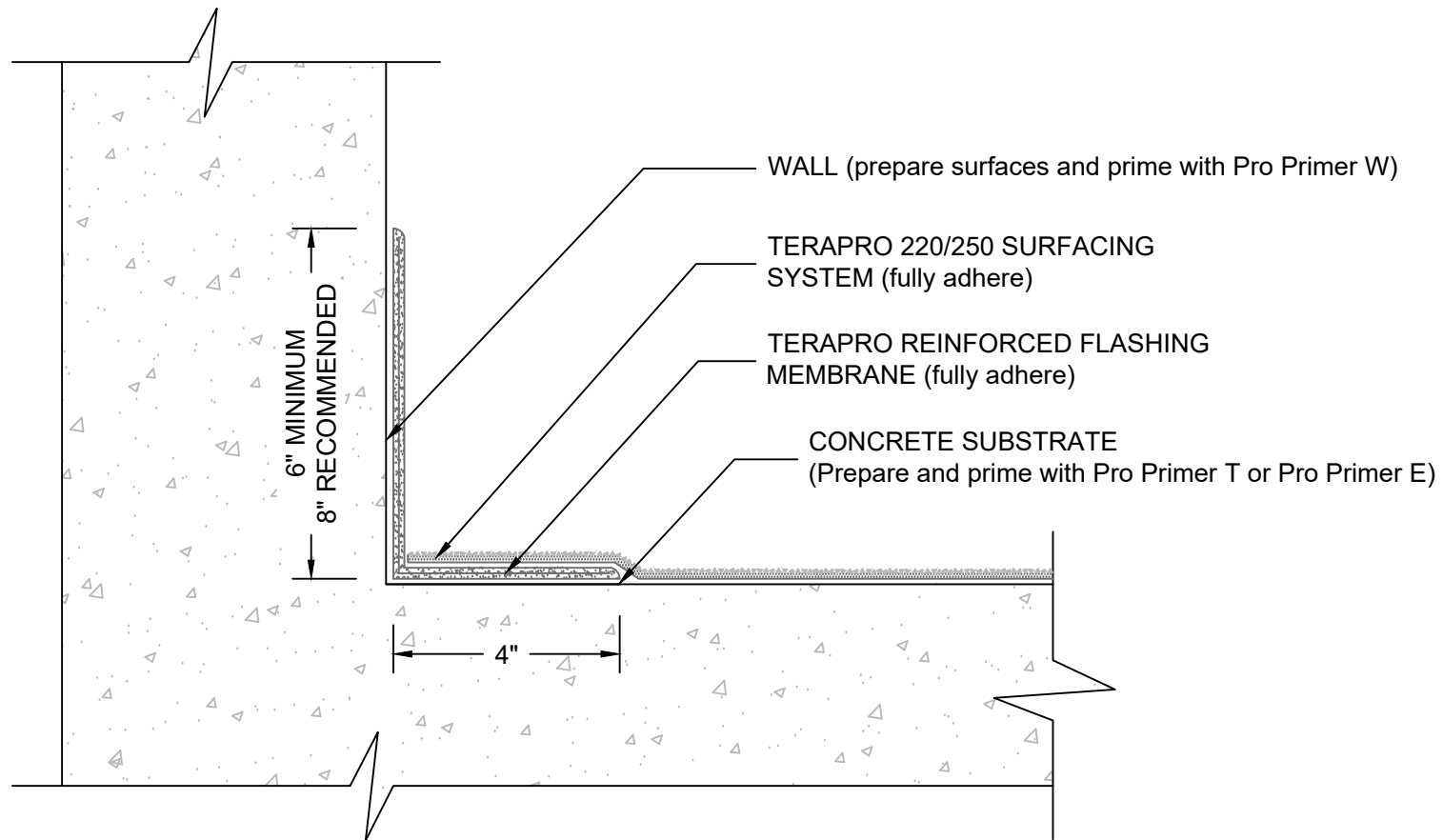

NOTES:

1. REFER TO SIPLAST PREPARATION GUIDELINES FOR PROPER SURFACE TREATMENT OF ALL MATERIALS PRIOR TO APPLICATION OF TERAPRO SURFACING MATERIALS.
2. REQUIREMENTS AND RECOMMENDATIONS DETAILED IN TERAPRO 220/250 SURFACING SYSTEM SPECIFICATIONS SHALL APPLY IN ADDITION TO THE ABOVE DRAWING.

N.T.S