

# SUMPED ROOF DRAIN WITH PARAFLEX 531 LIQUID FLASHING

## PARADIENE 20/30 FR - RIGID INSULATION

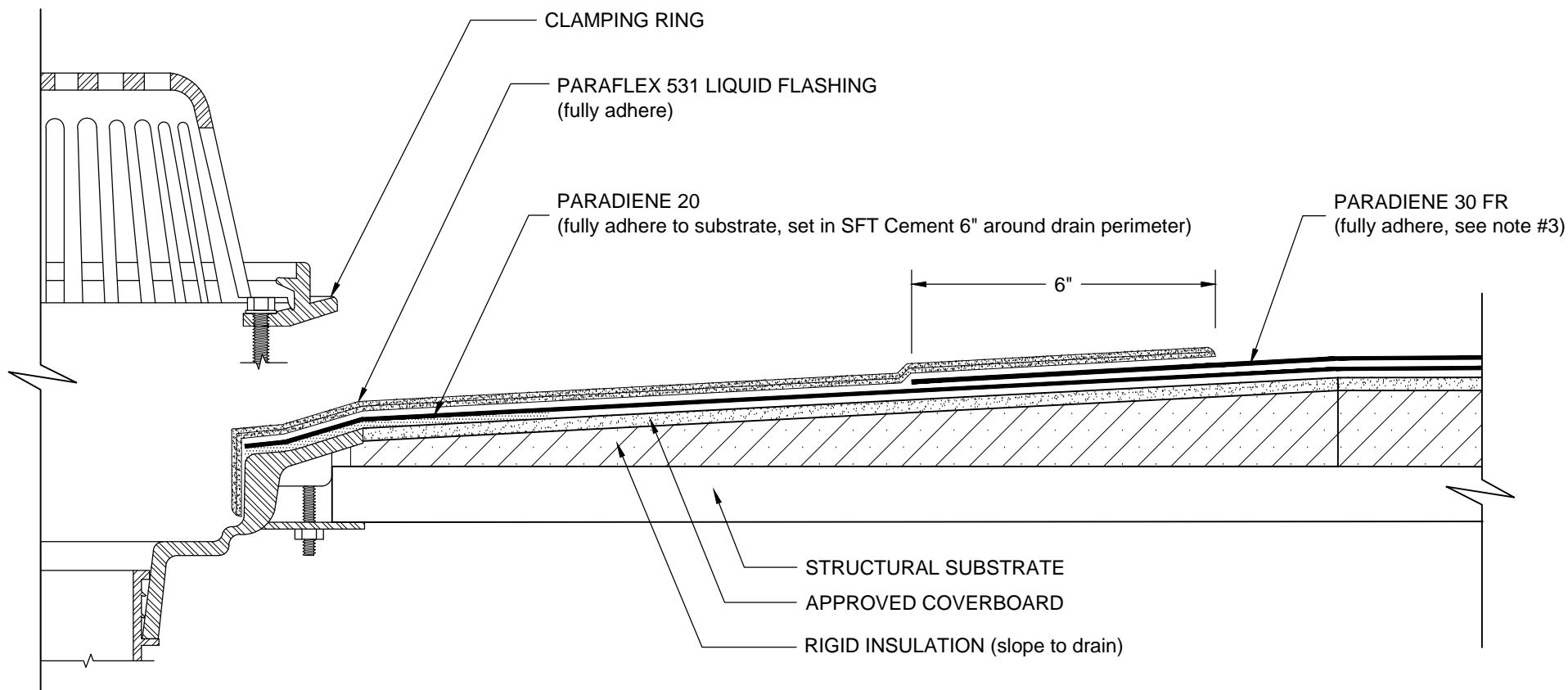

### NOTES:

1. CLEAN/WIPE THE SURFACE OF THE CURED PARAFLEX 531 LIQUID FLASHING WITH PRO PREP CC AND ALLOW TO DRY PRIOR TO LAPPING SUBSEQUENT SHEETS.
2. ROOF DRAIN COMPONENTS AND INSTALLATION SPECIFICATIONS ARE SUPPLIED BY THE DRAIN MANUFACTURER.
3. PARAFLEX CANNOT BE APPLIED IN THE ABOVE CONFIGURATION OVER MEMBRANES APPLIED IN SOLVENT-BASED ADHESIVES. CONTACT SIPLAST FOR FURTHER INFORMATION.
4. PRIME THE PARADIENE SHEETS USING PRO PRIMER AC TO MAINTAIN A CONSISTENT AESTHETIC APPEARANCE OF THE FINISHED PARAFLEX SYSTEM.
5. REQUIREMENTS AND RECOMMENDATIONS DETAILED IN CURRENT SIPLAST SPECIFICATIONS AND THE PARAFLEX 531 LIQUID FLASHING INSTALLERS GUIDE SHALL APPLY IN ADDITION TO THE ABOVE DRAWING.

CAUTION: SIPLAST RECOMMENDS THAT ALL PRACTICES PERTAINING TO NRCA CERTA GUIDELINES BE FOLLOWED WHEN TORCHING METHODS ARE EMPLOYED. THIS INCLUDES PERFORMING A FIRE WATCH FOLLOWING ANY TORCH APPLICATIONS. ALWAYS HAVE APPROVED FIRE-EXTINGUISHING EQUIPMENT NEARBY.

N.T.S



1000 Rochelle Boulevard - Irving, Texas - 75062 (800) 922-8800 [www.siplast.com](http://www.siplast.com)

Ref: Sumped Drain w/Pflex - 2030 - Rigid

Rev: 2.8.18