

ROOF VENT

PARADIENE 20TS/30 FR TG - INSULCEL RT

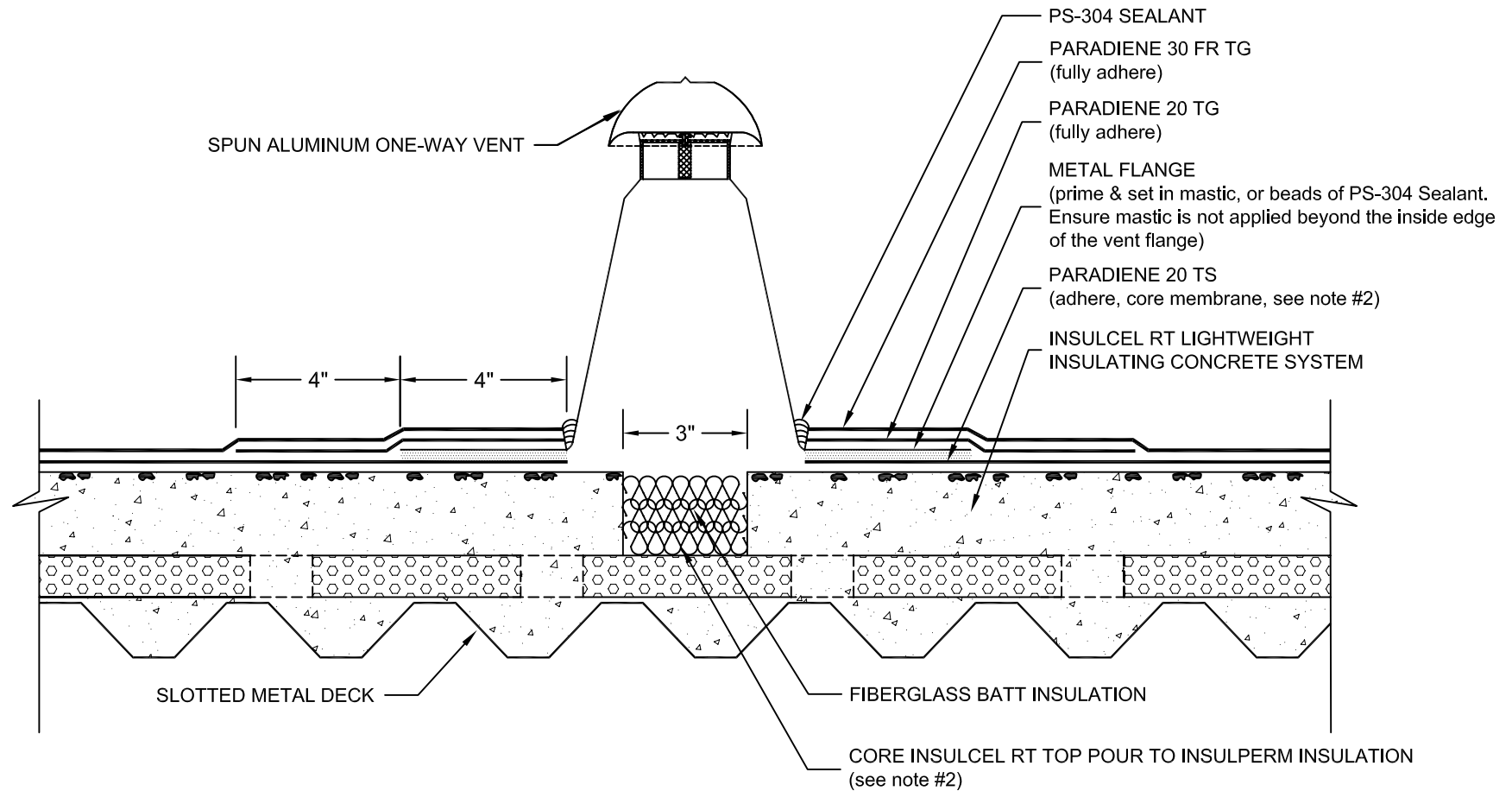

- NOTES:
1. ONE WAY VENTS SHOULD BE PREFABRICATED FROM SPUN ALUMINUM. PLASTIC VENTS ARE NOT ACCEPTABLE.
 2. THE INSTALLATION OF THE TOPSIDE VENTS MUST BE COMPLETED DAILY, IMMEDIATELY FOLLOWING THE APPLICATION OF THE PARADIENE 20 TS SHEET, AND IN ACCORDANCE WITH THE MOST RECENT VERSION OF THE TECHNICAL BULLETIN FOR VENTING SIPLAST ROOF MEMBRANE AND ROOF INSULATION SYSTEMS.
 3. WHERE PRIMER IS INDICATED TO MAINTAIN PROPER ADHESION, TA-119 PRIMER IS REQUIRED FOR ALL PARADIENE 20 SA FLASHING REINFORCING AND STRIPPING PLY APPLICATIONS. USE PA-1125 OR PA-917 LS FOR ALL NON-PARADIENE 20 SA APPLICATIONS. CONTACT SIPLAST FOR SPECIFIC REQUIREMENTS.
 4. REQUIREMENTS AND RECOMMENDATIONS DETAILED IN SIPLAST SPECIFICATIONS SHALL APPLY IN ADDITION TO THE ABOVE DRAWING.

CAUTION: SIPLAST RECOMMENDS THAT ALL PRACTICES PERTAINING TO NRCA CERTA GUIDELINES BE FOLLOWED WHEN TORCHING METHODS ARE EMPLOYED. THIS INCLUDES PERFORMING A FIRE WATCH FOLLOWING ANY TORCH APPLICATIONS. ALWAYS HAVE APPROVED FIRE-EXTINGUISHING EQUIPMENT NEARBY.

N.T.S.



1000 East Rochelle Boulevard - Irving, Texas - 75062 (800) 922-8800 www.siplast.com

Ref: Roof Vent-20TS30 insulcel RT

Rev: 03.24.11