

# ROOF TO WALL EXPANSION JOINT w/FlamLINE® WATERPROOF EXPANSION JOINT PARAPRO ROOF MEMBRANE / PRO BASE TG - RIGID INSULATION

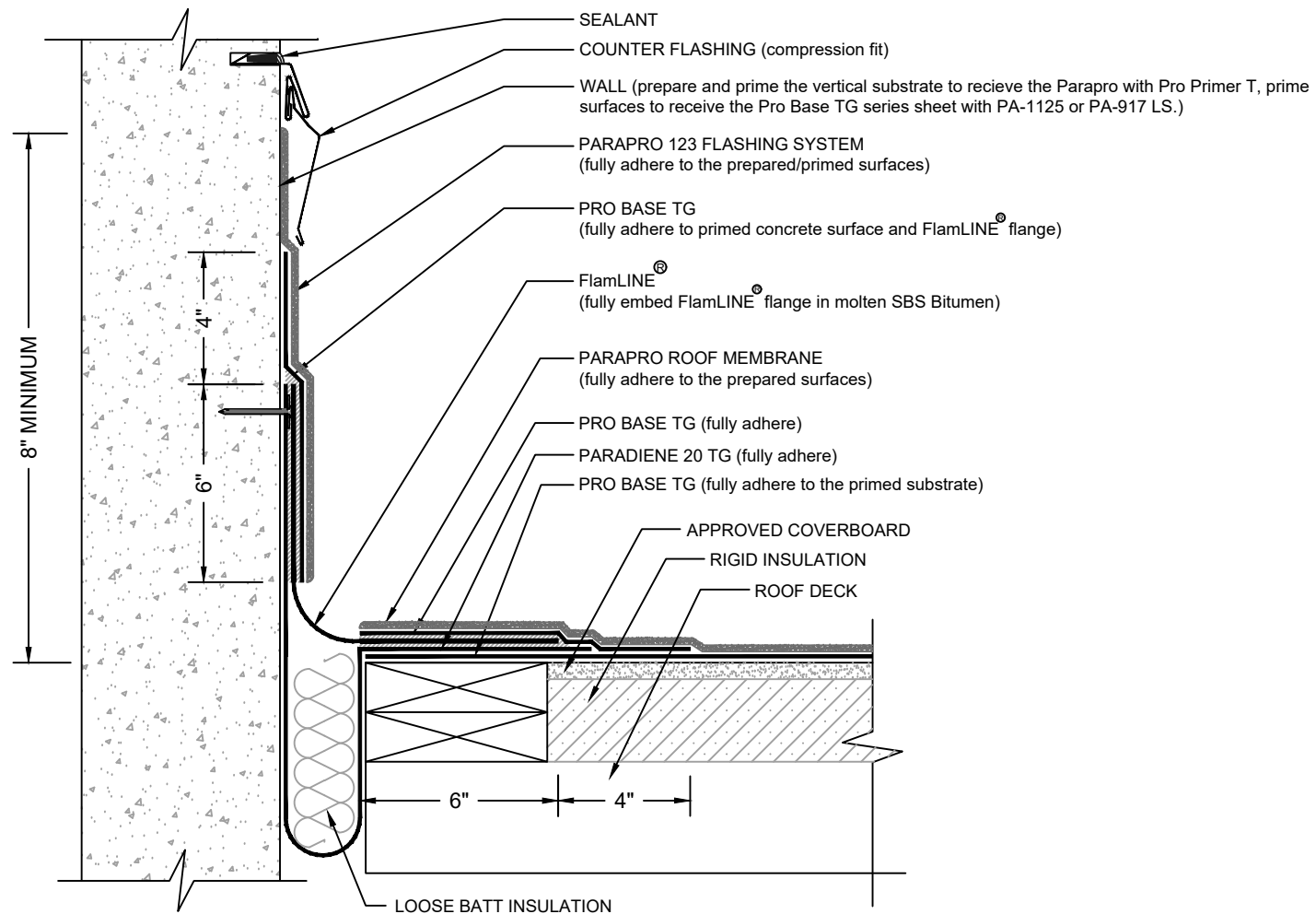

## NOTES:

1. REFER TO SIPLAST PREPARATION GUIDELINES FOR PROPER SUBSTRATE TREATMENT OF ALL MATERIALS PRIOR TO APPLICATION OF PRO BASE & PARAPRO MATERIALS.
2. FOLLOW SITURA SPECIFICATIONS FOR SELECTION AND INSTALLATION OF THE APPROPRIATE FLAMLINER PRODUCT.
3. WHERE PRIMER IS INDICATED TO MAINTAIN PROPER ADHESION, TA-119 PRIMER IS REQUIRED FOR ALL PARADIENE 20 SA FLASHING REINFORCING AND STRIPPING PLY APPLICATIONS. USE PA-1125 OR PA-917 LS PRIMER FOR ALL OTHER PARADIENE 20 SERIES PRODUCTS THAT ARE NOT SELF-ADHESIVE SHEETS. CONTACT SIPLAST FOR SPECIFIC REQUIREMENTS.
4. THE CARPENTRY AND METAL WORK SHOWN DEPICTS SHOP FABRICATION AND JOB-SITE ASSEMBLY. THESE COMPONENTS SHOULD BE DESIGNED/FABRICATED/INSTALLED ACCORDING TO GENERALLY ACCEPTED INDUSTRY PRACTICES, STANDARDS, AND APPROVALS.
5. REQUIREMENTS AND RECOMMENDATIONS DETAILED IN CURRENT SIPLAST AND SITURA SPECIFICATIONS SHALL APPLY IN ADDITION TO THE ABOVE DRAWING.
6. **FlamLINE® IS A REGISTERED TRADEMARK BRAND OF SITURA INC.**

CAUTION: SIPLAST RECOMMENDS THAT ALL PRACTICES PERTAINING TO NRCA CERTA GUIDELINES BE FOLLOWED WHEN TORCHING METHODS ARE EMPLOYED. THIS INCLUDES PERFORMING A FIRE WATCH FOLLOWING ANY TORCH APPLICATIONS. ALWAYS HAVE APPROVED FIRE-EXTINGUISHING EQUIPMENT NEARBY.

N.T.S



1000 Rochelle Boulevard - Irving, Texas - 75062 (800) 922-8800 www.siplast.com

Ref: Roof to Wall FlamLine - Ppro - ProBaseTG - Rigid

Rev: 04.02.19