

ROOF TO WALL EXPANSION JOINT w/FlamLINE® WATERPROOF EXPANSION JOINT PARADIENE 30 FR TG / PARADIENE 20 TG - RIGID INSULATION

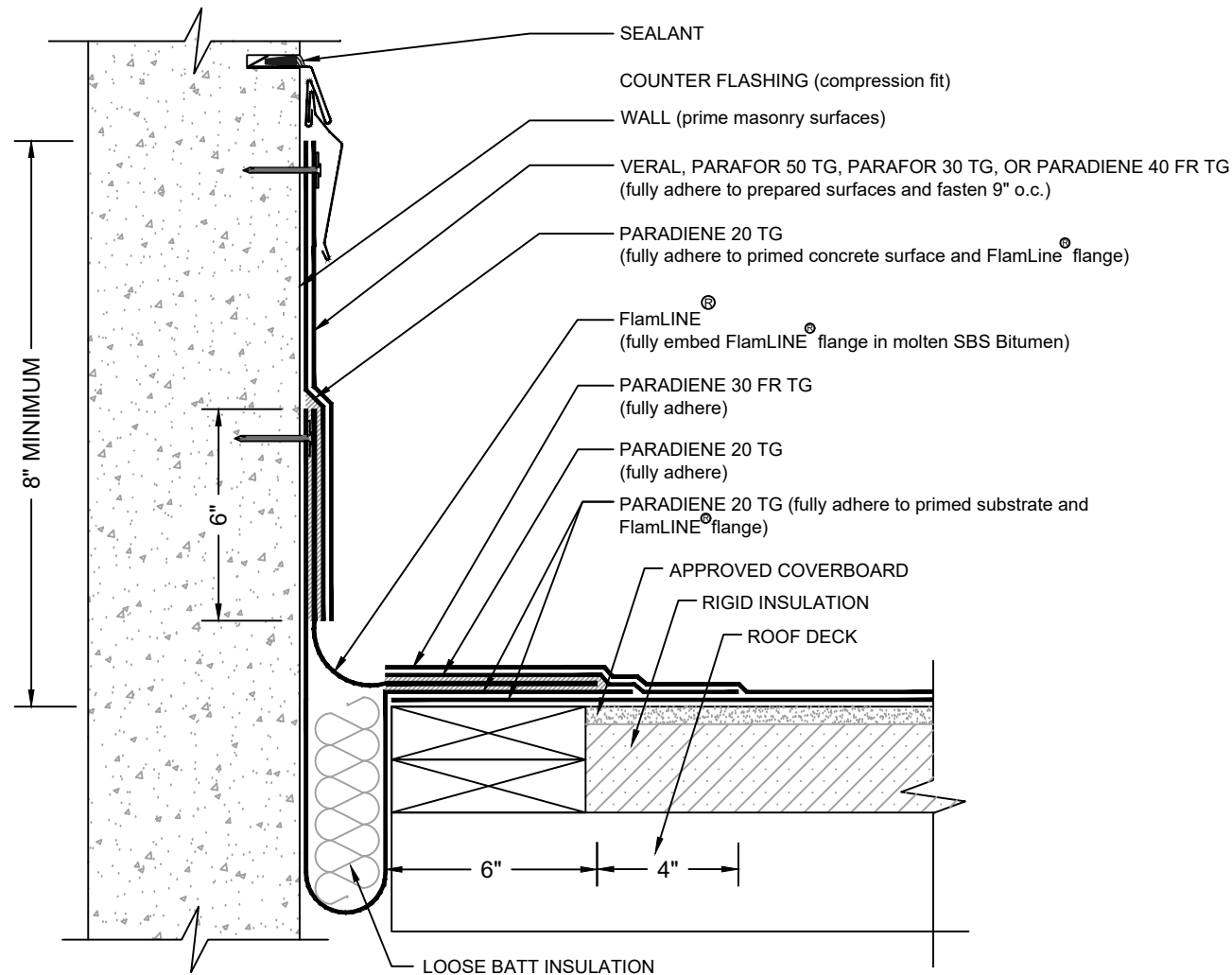

NOTES:

1. REFER TO SIPLAST PREPARATION GUIDELINES FOR PROPER SUBSTRATE TREATMENT OF ALL MATERIALS PRIOR TO APPLICATION OF PARADIENE MATERIALS.
2. FOLLOW SITURA SPECIFICATIONS FOR SELECTION AND INSTALLATION OF THE APPROPRIATE FLAMLINER PRODUCT.
3. WHERE PRIMER IS INDICATED TO MAINTAIN PROPER ADHESION, TA-119 PRIMER IS REQUIRED FOR ALL PARADIENE 20 SA FLASHING REINFORCING AND STRIPPING PLY APPLICATIONS. USE PA-1125 OR PA-917 LS PRIMER FOR ALL OTHER PARADIENE 20 SERIES PRODUCTS THAT ARE NOT SELF-ADHESIVE SHEETS. CONTACT SIPLAST FOR SPECIFIC REQUIREMENTS.
4. THE CARPENTRY AND METAL WORK SHOWN DEPICTS SHOP FABRICATION AND JOB-SITE ASSEMBLY. THESE COMPONENTS SHOULD BE DESIGNED/FABRICATED/INSTALLED ACCORDING TO GENERALLY ACCEPTED INDUSTRY PRACTICES, STANDARDS, AND APPROVALS.
5. REQUIREMENTS AND RECOMMENDATIONS DETAILED IN CURRENT SIPLAST AND SITURA SPECIFICATIONS SHALL APPLY IN ADDITION TO THE ABOVE DRAWING.
6. FlamLINE IS A REGISTERED TRADEMARK BRAND OF SITURA INC.

CAUTION: SIPLAST RECOMMENDS THAT ALL PRACTICES PERTAINING TO NRCA CERTA GUIDELINES BE FOLLOWED WHEN TORCHING METHODS ARE EMPLOYED. THIS INCLUDES PERFORMING A FIRE WATCH FOLLOWING ANY TORCH APPLICATIONS. ALWAYS HAVE APPROVED FIRE-EXTINGUISHING EQUIPMENT NEARBY.

N.T.S



1000 Rochelle Boulevard - Irving, Texas - 75062 (800) 922-8800 www.siplast.com

Ref: Roof to Wall FlamLine -2030T - Rigid

Rev: 02.07.19