

RIDGE DETAIL

PARASOLO ROOF MEMBRANE - INSULATED (ALL SYSTEMS)

| LEGEND | |
|---|-----------|
|  | HEAT WELD |

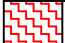
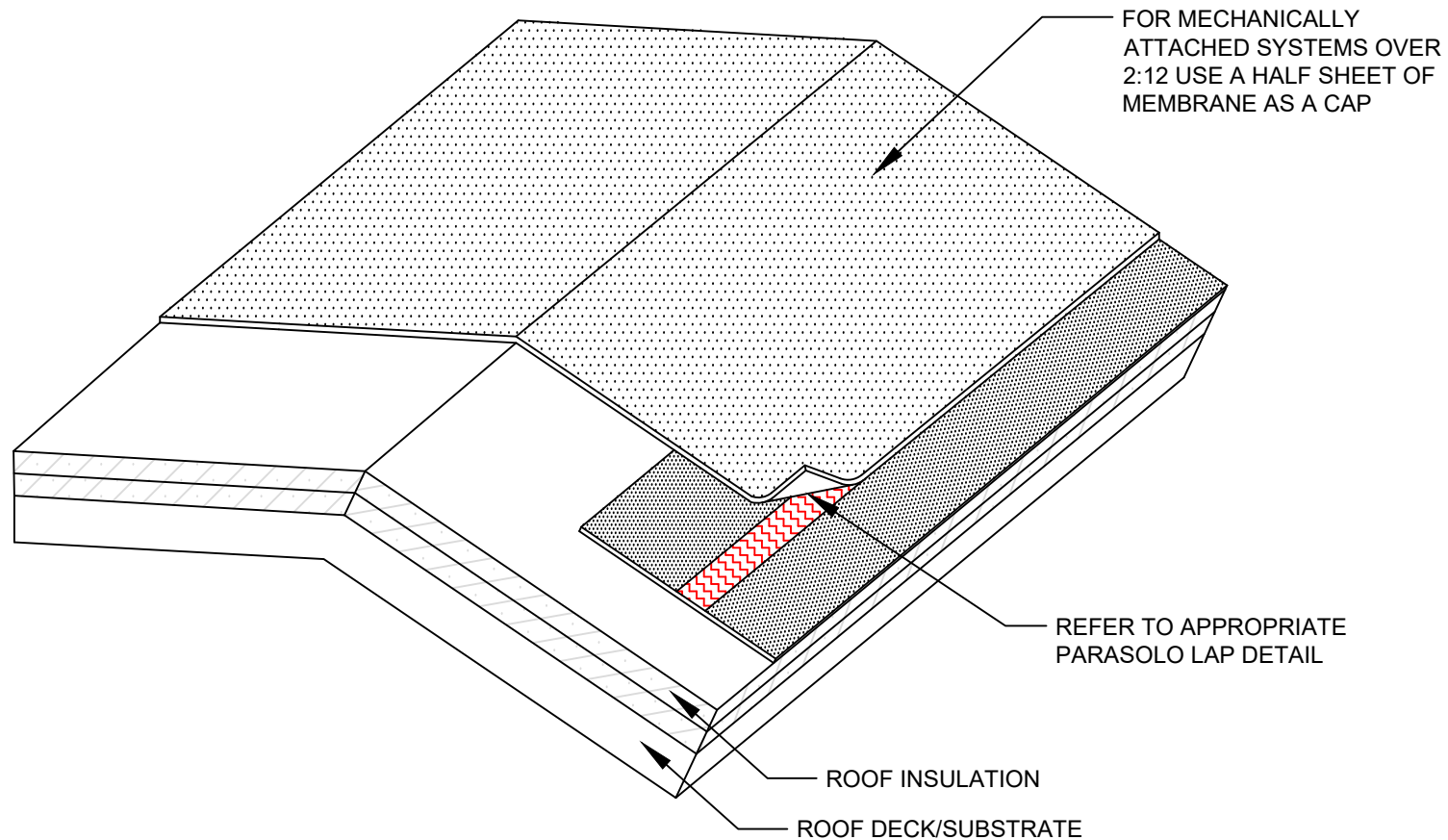

NOTES:

1. FOR HEAT-WELDING LAPS USE 1" MINIMUM WELD TO 1-1/2" MAXIMUM WELD.

Scale: NTS

REF: RIDGE DETAIL - PARASOLO - INSULATED

Detail Number:
DE-6216



14911 Quorum Drive, Suite 600 - Dallas, Texas - 75254 (800) 922-8800

www.siplast.com

Rev: 06.08.2023