

PARAPET WITH PLYWOOD SHEATHING AND PARAFLEX 531 LIQUID FLASHING

TERANAP - CONCRETE SUBSTRATE

SHOWN WITHOUT OVERBURDEN COMPONENTS

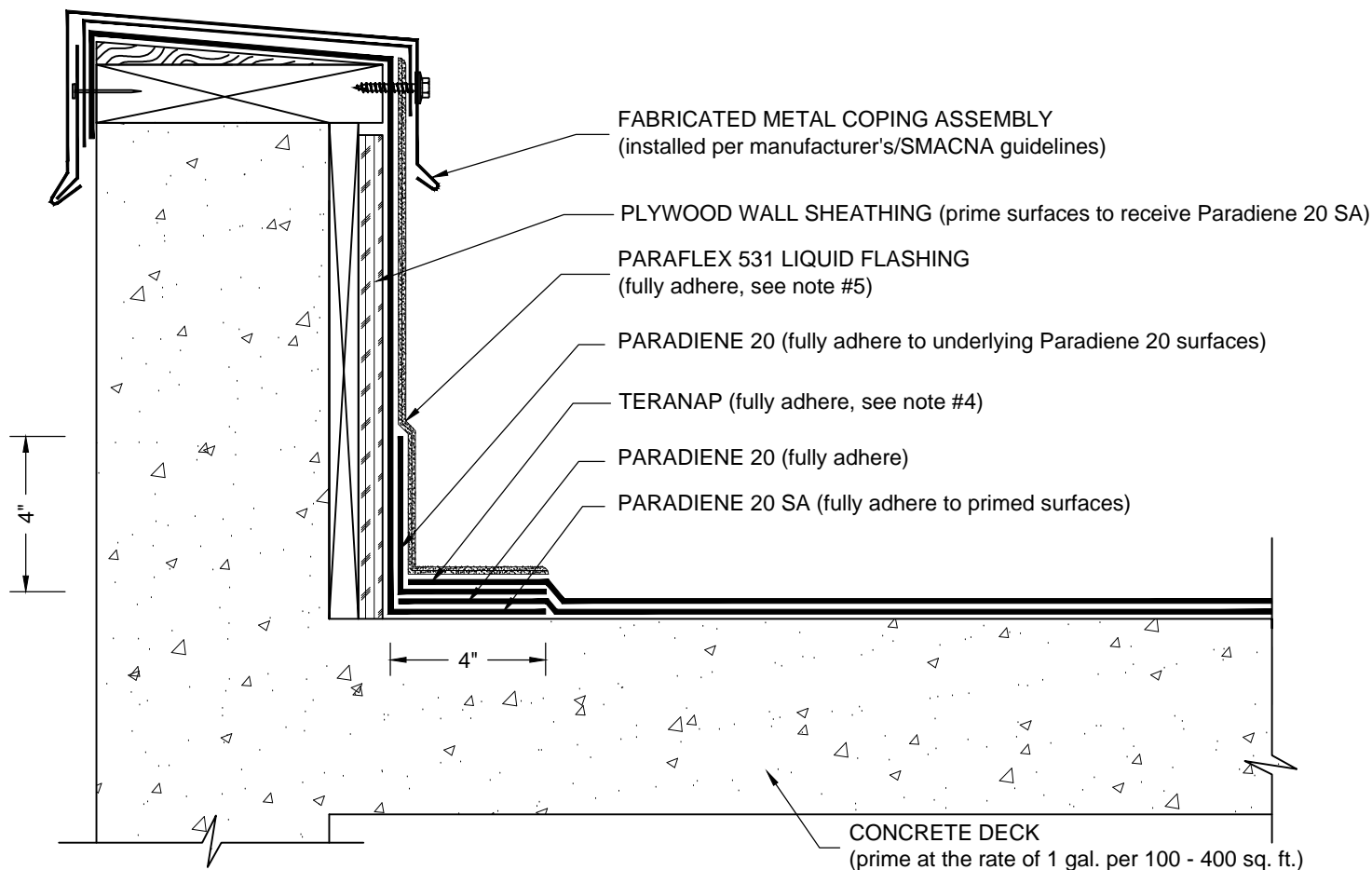

NOTES:

1. BEFORE APPLICATION OF PARAFLEX 531 LIQUID FLASHING, PS-715 NS ELASTOMERIC SEALANT SHOULD BE USED TO FILL VOIDS WHERE ROOFING MEMBRANES TERMINATE AT PENETRATIONS.
2. REFER TO SIPLAST PREPARATION GUIDELINES FOR PROPER SURFACE TREATMENT OF ALL MATERIALS PRIOR TO APPLICATION OF PARAFLEX FLASHING MATERIALS.
3. DISSIMILAR METAL TYPES SUBJECT TO ELECTROLYTIC REACTION SHOULD BE PHYSICALLY SEPARATED.
4. PARAFLEX 531 LIQUID FLASHING CANNOT BE APPLIED TO A TERANAP FILM SURFACE MEMBRANE. ON PROJECTS WHERE A TERANAP FILM SURFACE MEMBRANE IS USED FOR FIELD AND FLASHING APPLICATIONS, INSTALL A TARGET SHEET OF PARADIENE 20 TG, PARAFOR 50 TG OR TERANAP 1M SAND OVER THE TERANAP 1M FILM IN ALL AREAS TO RECEIVE DIRECT APPLICATION OF PARAFLEX 531 LIQUID FLASHING.
5. PARAFLEX CANNOT BE APPLIED IN THE ABOVE CONFIGURATION OVER MEMBRANES OR OTHER MATERIALS CONTAINING UNCURED, SOLVENT-BASED MATERIALS. CONTACT SIPLAST FOR FURTHER INFORMATION.
6. WHERE PRIMER IS INDICATED TO MAINTAIN PROPER ADHESION, TA-119 PRIMER IS REQUIRED FOR ALL PARADIENE 20 SA FLASHING REINFORCING AND STRIPPING PLY APPLICATIONS. USE PA-1125 OR PA-917 LS PRIMER FOR ALL OTHER PARADIENE 20 SERIES PRODUCTS THAT ARE NOT SELF-ADHESIVE SHEETS. CONTACT SIPLAST FOR SPECIFIC REQUIREMENTS.
7. PRIME THE PARADIENE/TERANAP 1M SAND SHEETS USING PRO PRIMER AC TO MAINTAIN A CONSISTENT AESTHETIC APPEARANCE OF THE FINISHED PARAFLEX SYSTEM.
8. CONSULT TERANAP SPECIFICATION PLATES FOR OVERBURDEN/PROTECTION SYSTEM OPTIONS.
9. REQUIREMENTS AND RECOMMENDATIONS DETAILED IN CURRENT SIPLAST SPECIFICATIONS AND THE PARAFLEX 531 LIQUID FLASHING INSTALLERS GUIDE SHALL APPLY IN ADDITION TO THE ABOVE DRAWING.

CAUTION: SIPLAST RECOMMENDS THAT ALL PRACTICES PERTAINING TO NRCA CERTA GUIDELINES BE FOLLOWED WHEN TORCHING METHODS ARE EMPLOYED. THIS INCLUDES PERFORMING A FIRE WATCH FOLLOWING ANY TORCH APPLICATIONS. ALWAYS HAVE APPROVED FIRE-EXTINGUISHING EQUIPMENT NEARBY.

N.T.S



1000 Rochelle Boulevard - Irving, Texas - 75062 (800) 922-8800 www.siplast.com

Ref: Parapet Plywood - Teranap - Concrete - Pflex

Rev: 2.9.18