

# HEAT WELDED WALKWAY INSTALLATION WITH PARASOLO FLASHING

## PARASOLO FLEECE BACK MEMBRANE

LEGEND



HEAT WELD

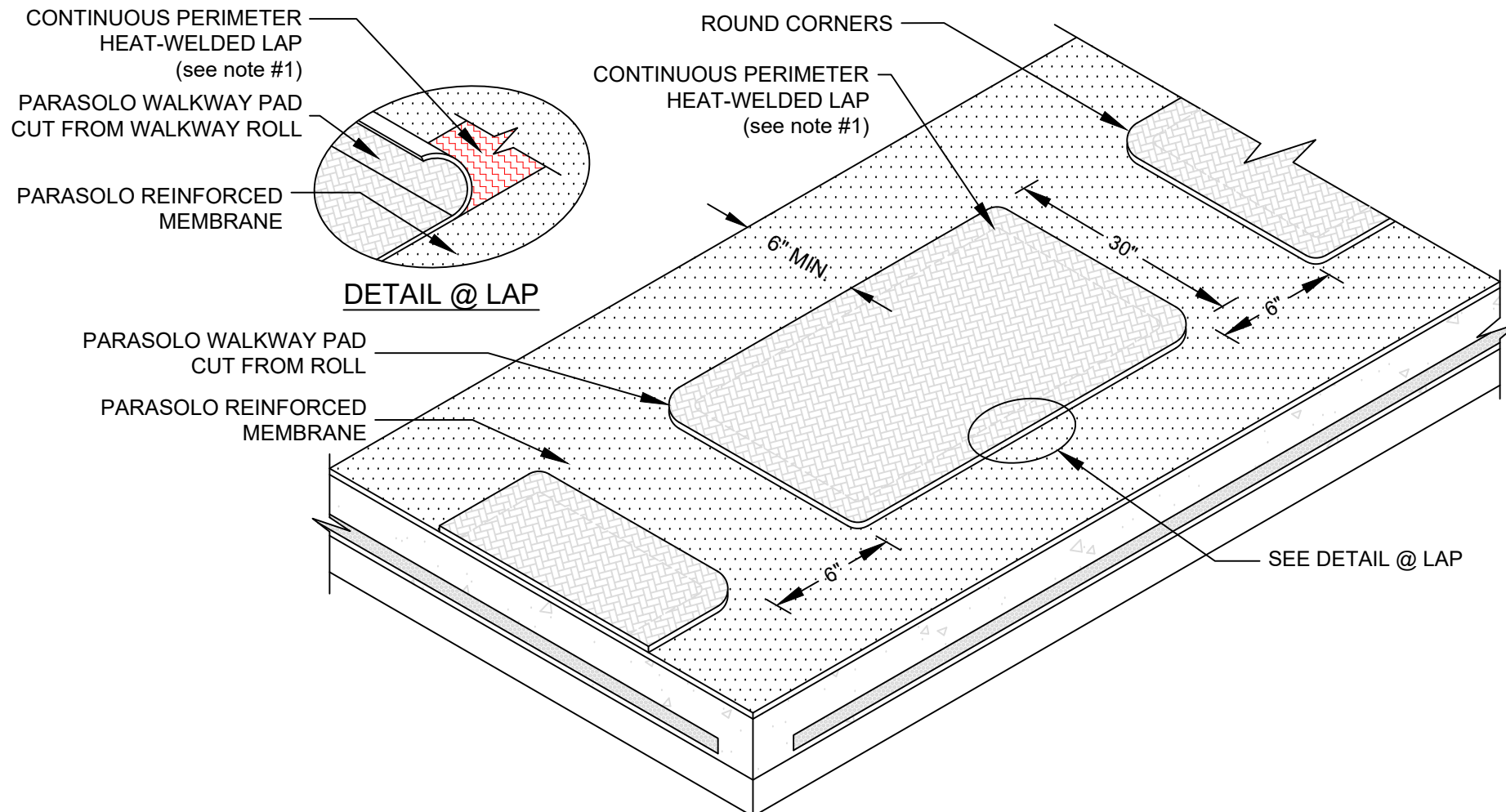

### NOTES:

1. FOR HEAT-WELDING LAPS USE 1" MINIMUM WELD TO 1-1/2" MAXIMUM WELD.
2. DO NOT CROSS ROOF MEMBRANE SEAMS WITH WALKWAY PADS, KEEP PADS A MINIMUM OF 6" AWAY FROM SEAMS.
3. REQUIRED AT ALL ROOF ACCESS POINTS.
4. REQUIREMENTS AND RECOMMENDATIONS DETAILED IN CURRENT SIPLAST SPECIFICATIONS SHALL APPLY IN ADDITION TO THE ABOVE DRAWING.

Scale: NTS

REF: HEAT-WELDED WALKWAY - PARASOLO - INSULCEL

Detail Number:  
DE-6848



14911 Quorum Drive, Suite 600 - Dallas, Texas - 75254 (800) 922-8800

[www.siplast.com](http://www.siplast.com)

Rev: 06.15.2023