

CONCRETE DYNAMIC CRACK

PARAPRO ROOF MEMBRANE - CONCRETE SUBSTRATE

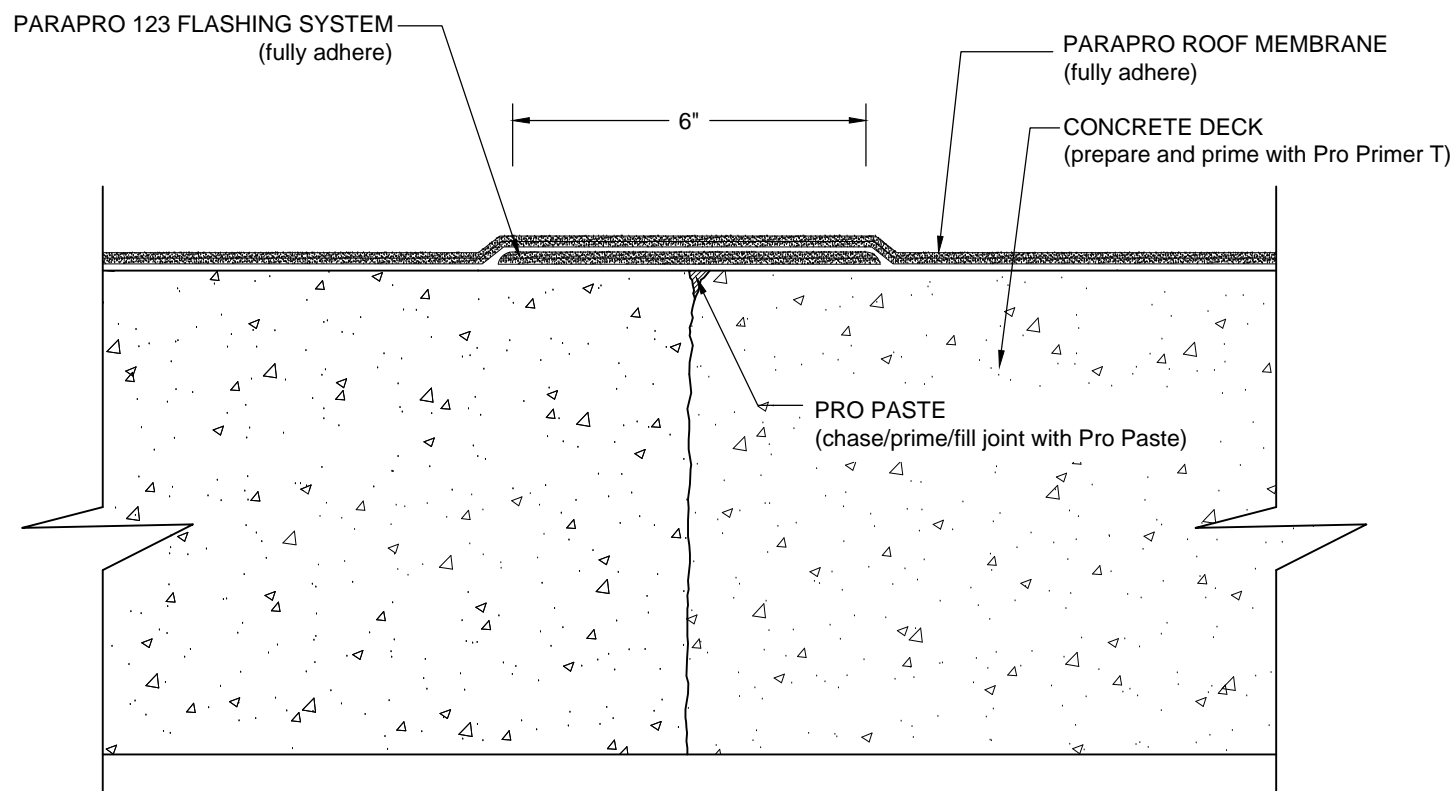

NOTES:

1. REFER TO SIPLAST PREPARATION GUIDELINES FOR PROPER SURFACE TREATMENT OF ALL MATERIALS PRIOR TO APPLICATION OF PARAPRO MATERIALS.
2. REQUIREMENTS AND RECOMMENDATIONS DETAILED IN CURRENT SIPLAST SPECIFICATIONS AND THE PARAPRO ROOF SYSTEM INSTALLER'S GUIDE SHALL APPLY IN ADDITION TO THE ABOVE DRAWING.
3. SIPLAST RECOMMENDATIONS FOR CRACK PREPARATION/TREATMENT ARE INTENDED TO PROVIDE METHODS ON A BEST-EFFORT BASIS.

N.T.S



1000 Rochelle Boulevard - Irving, Texas - 75062 (800) 922-8800 www.siplast.com

Ref: Dynamic Crack - Ppro - Concrete

Rev: 12.8.18