

DRAIN WITH INTERPLY PARAPRO FLASHING

PARADIENE 20TS/30 FR TG - INSULCEL RT

INSULCEL RT LIGHTWEIGHT INSULATING
CONCRETE SYSTEM (slope to drain)

PARADIENE 20 TS (adhere)

PARAPRO 123 FLASHING SYSTEM (extend a minimum 8"
beyond outermost edge of drain)

PARADIENE 20 TG (fully adhere, extend 4" beyond
Parapro)

MASTIC (set all roof layers above Parapro Flashing
in mastic 6" around drain perimeter)

PARADIENE 30 FR TG

STRAINER & CLAMPING RING

OVERHEAD VIEW

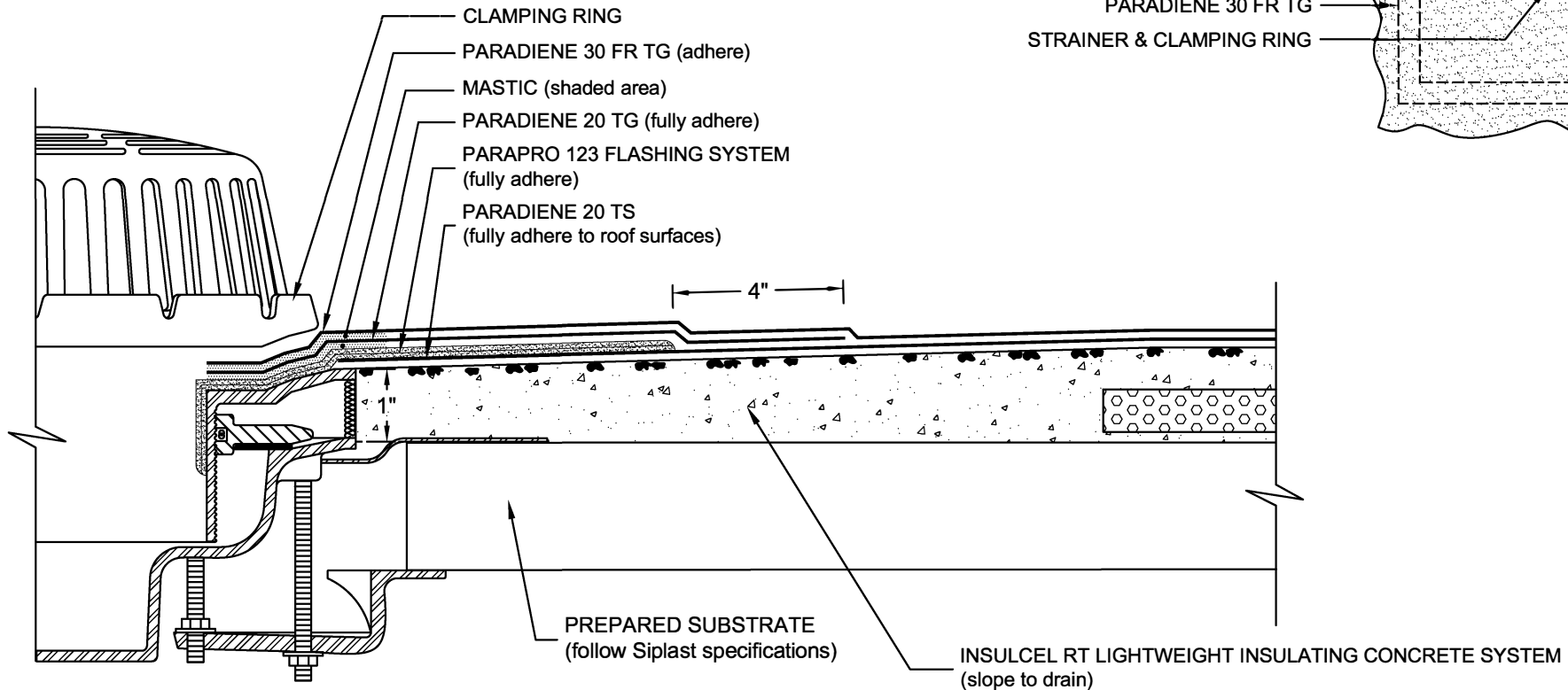

- NOTES:
1. PA-1021 PLASTIC CEMENT IS REQUIRED WHERE MASTIC IS INDICATED.
 2. ROOF DRAIN COMPONENTS AND INSTALLATION GUIDELINES ARE SUPPLIED BY THE DRAIN MANUFACTURER.
 3. REFER TO SIPLAST PREPARATION GUIDELINES FOR PROPER SURFACE TREATMENT OF ALL MATERIALS PRIOR TO APPLICATION OF PARAPRO FLASHING.
 4. REQUIREMENTS AND RECOMMENDATIONS DETAILED IN THE CURRENT SIPLAST SPECIFICATIONS AND PARAPRO INSTALLER'S GUIDE SHALL APPLY IN ADDITION TO THE ABOVE DRAWING.
 5. REFER TO SIPLAST FLEECE CUTTING RECOMMENDATIONS FOR CONFIGURATIONS, CUTTING, FOLDING, AND LAPPING TECHNIQUES.

CAUTION: SIPLAST RECOMMENDS THAT ALL PRACTICES PERTAINING TO NRCA CERTA GUIDELINES BE FOLLOWED WHEN TORCHING METHODS ARE EMPLOYED. THIS INCLUDES PERFORMING A FIRE WATCH FOLLOWING ANY TORCH APPLICATIONS. ALWAYS HAVE APPROVED FIRE-EXTINGUISHING EQUIPMENT NEARBY.

N.T.S.