

DRAIN WITH INTERPLY PARAPRO FLASHING

PARASOLO HYBRID SYSTEM - INSULATED

**Note: This detail applies to PVC
and PVC KEE systems only**

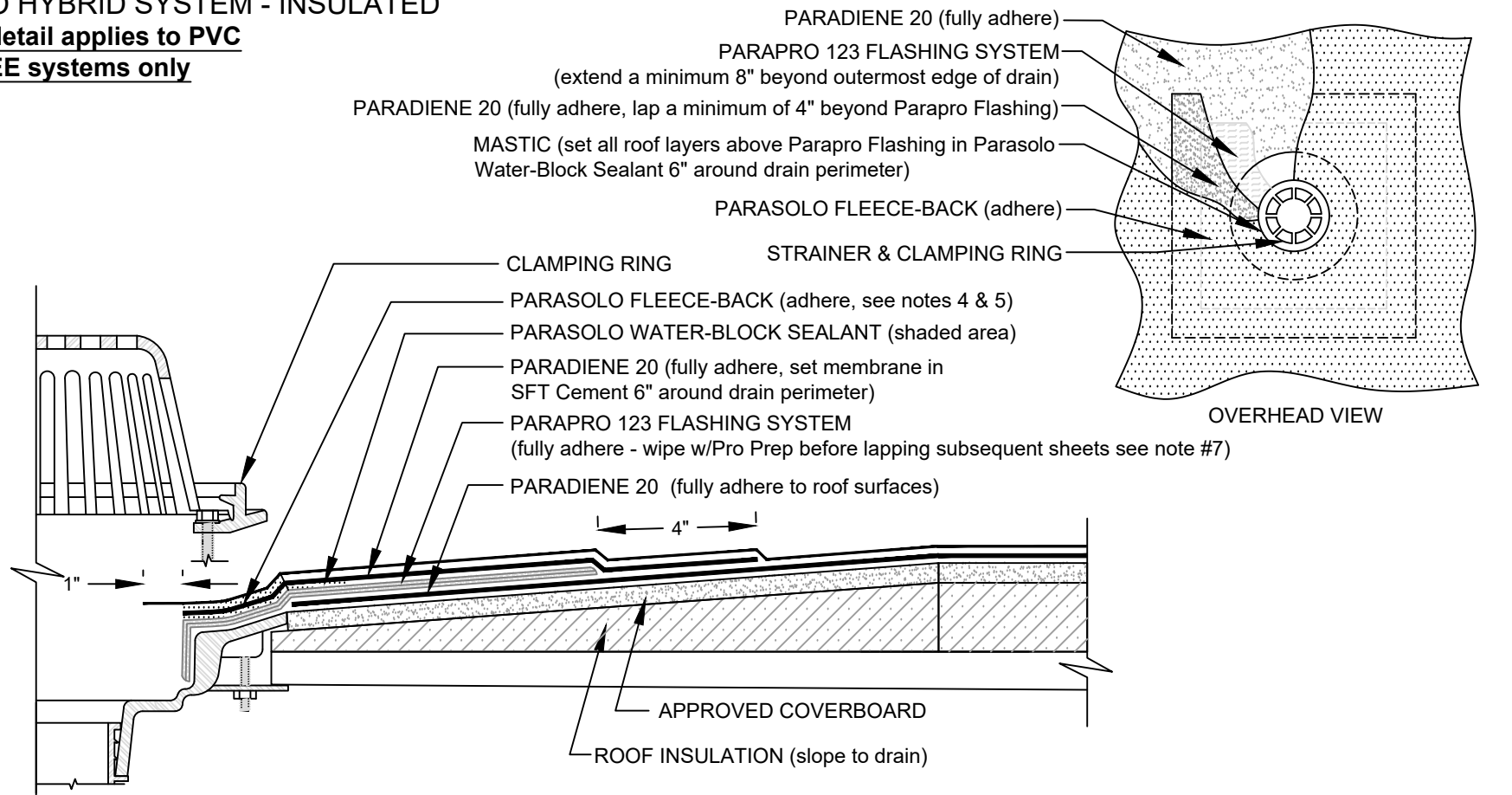

NOTES:

1. CLEAN/WIPE THE SURFACE OF THE CURED PARAPRO 123 FLASHING WITH PRO PREP AND ALLOW TO DRY PRIOR TO APPLICATION OF THE PARADIENE 20 STRIPPING PLY.
2. REFER TO SIPLAST PREPARATION GUIDELINES FOR PROPER SURFACE TREATMENT OF ALL MATERIALS PRIOR TO APPLICATION OF PARAPRO FLASHING MATERIALS.
3. REFER TO SIPLAST FLEECE CUTTING RECOMMENDATIONS FOR CONFIGURATIONS, CUTTING, FOLDING, AND LAPPING TECHNIQUES.
4. SET PARASOLO MEMBRANE IN PARASOLO WATER-BLOCK SEALANT. SET MEMBRANE IN FULL BED (USE FULL TUBE) OF THE SPECIFIED WATER BLOCK SEALANT OVER THE DRAIN FLANGE PRIOR TO SECUREMENT OF CLAMPING RING.
5. MEMBRANE MUST EXTEND MINIMUM 1" BEYOND THE BOLT HOLES. THE CLAMPING RING BOLTS MUST PENETRATE THE MEMBRANE.
6. REQUIREMENTS AND RECOMMENDATIONS DETAILED IN THE CURRENT SIPLAST SPECIFICATIONS SHALL APPLY IN ADDITION TO THE ABOVE DRAWING.

CAUTION: SIPLAST RECOMMENDS THAT ALL PRACTICES PERTAINING TO INDUSTRY STANDARD TORCH SAFETY REQUIREMENTS AND GUIDELINES BE FOLLOWED. THIS INCLUDES PERFORMING A FIRE WATCH FOLLOWING ANY TORCH APPLICATIONS. ALWAYS HAVE APPROVED FIRE EXTINGUISHING EQUIPMENT NEARBY WHEN USING A TORCH.

Scale: NTS

REF: ROOF DRAIN (INTERPLY) - PARASOLO - P20 - INSULATED

Detail Number:
DE-6405



14911 Quorum Drive, Suite 600 - Dallas, Texas - 75254 (800) 922-8800

www.siplast.com

Rev: 06.06.2023