

CURB (SBS MEMBRANE)

PA-750 HOT RUBBERIZED ASPHALT - CONCRETE SUBSTRATE

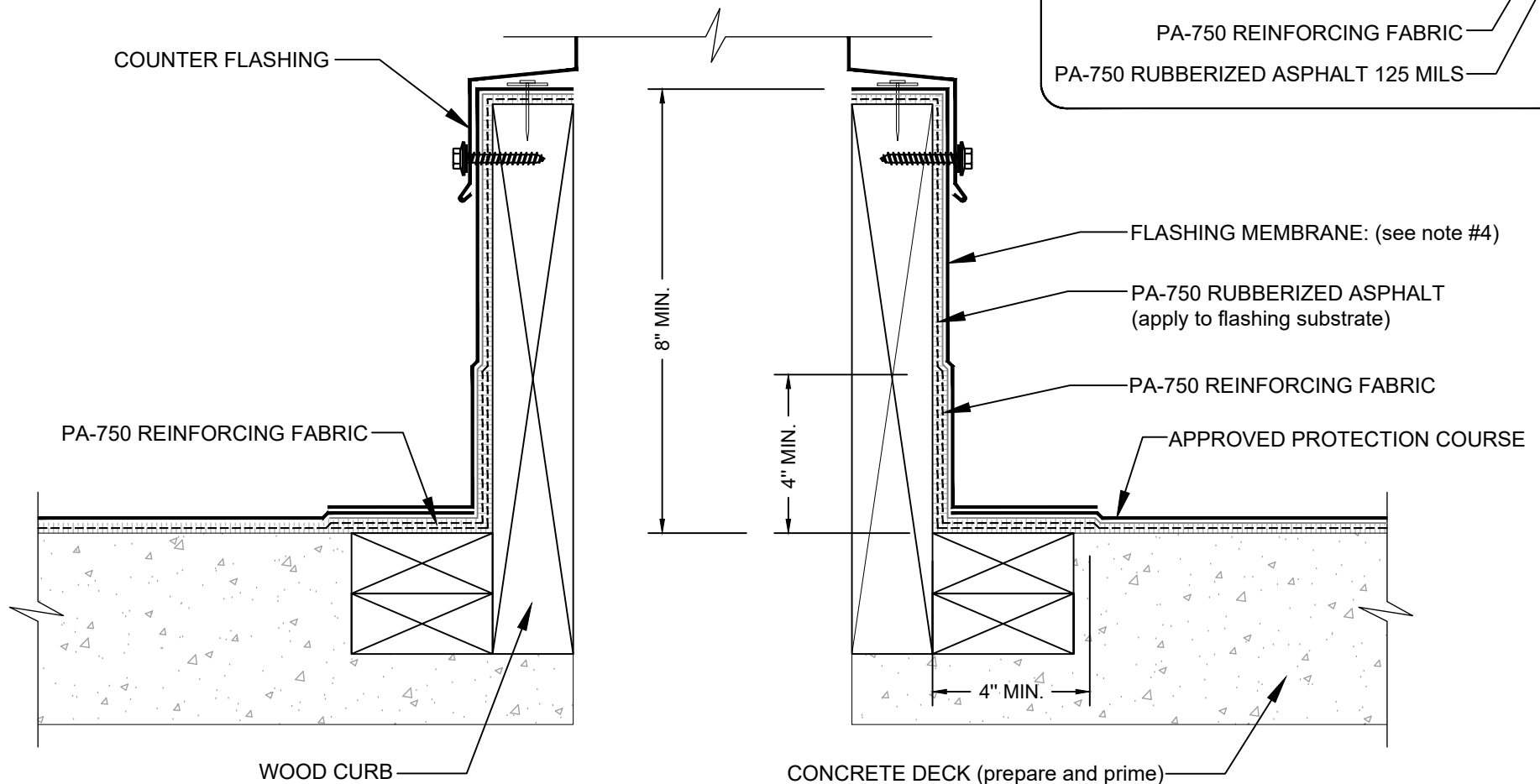

NOTES:

1. REQUIREMENTS AND RECOMMENDATIONS DETAILED IN PA-750 HOT APPLIED RUBBERIZED ASPHALT SYSTEM INSTALLER'S GUIDE SHALL APPLY IN ADDITION TO THE ABOVE DRAWING.
2. ONE OF THE FOLLOWING PRIMERS: PA-1125 OR PA-917 PRIMER IS REQUIRED WHERE PRIMER IS INDICATED. CONTACT SIPLAST FOR SPECIFIC REQUIREMENTS.
3. CONSULT PA-750 HOT APPLIED RUBBERIZED ASPHALT SYSTEM SPECIFICATION PLATES FOR OVERBURDEN/PROTECTION SYSTEM OPTIONS.
4. APPLY FLASHING MEMBRANE IN PA-750 RUBBERIZED ASPHALT TO PREPARED SURFACE AND FASTEN 9" ON CENTER.
5. CONSULT PA-750 HOT APPLIED RUBBERIZED ASPHALT SYSTEM SPECIFICATION PLATES FOR OVERBURDEN / PROTECTION SYSTEM OPTIONS.

Scale: NTS

REF: CURB - PA-750 - CONCRETE



14911 Quorum Drive, Suite 600 - Dallas, Texas - 75254 (800) 922-8800

www.siplast.com

Detail Number:
DE-HRA-40-01c

Rev: 11.21.2024