

EXPANSION JOINT WITH METAL COVER

PARADIENE 20/30 FR - NON VENTED SUBSTRATE

ADHESIVE APPLIED FLASHINGS

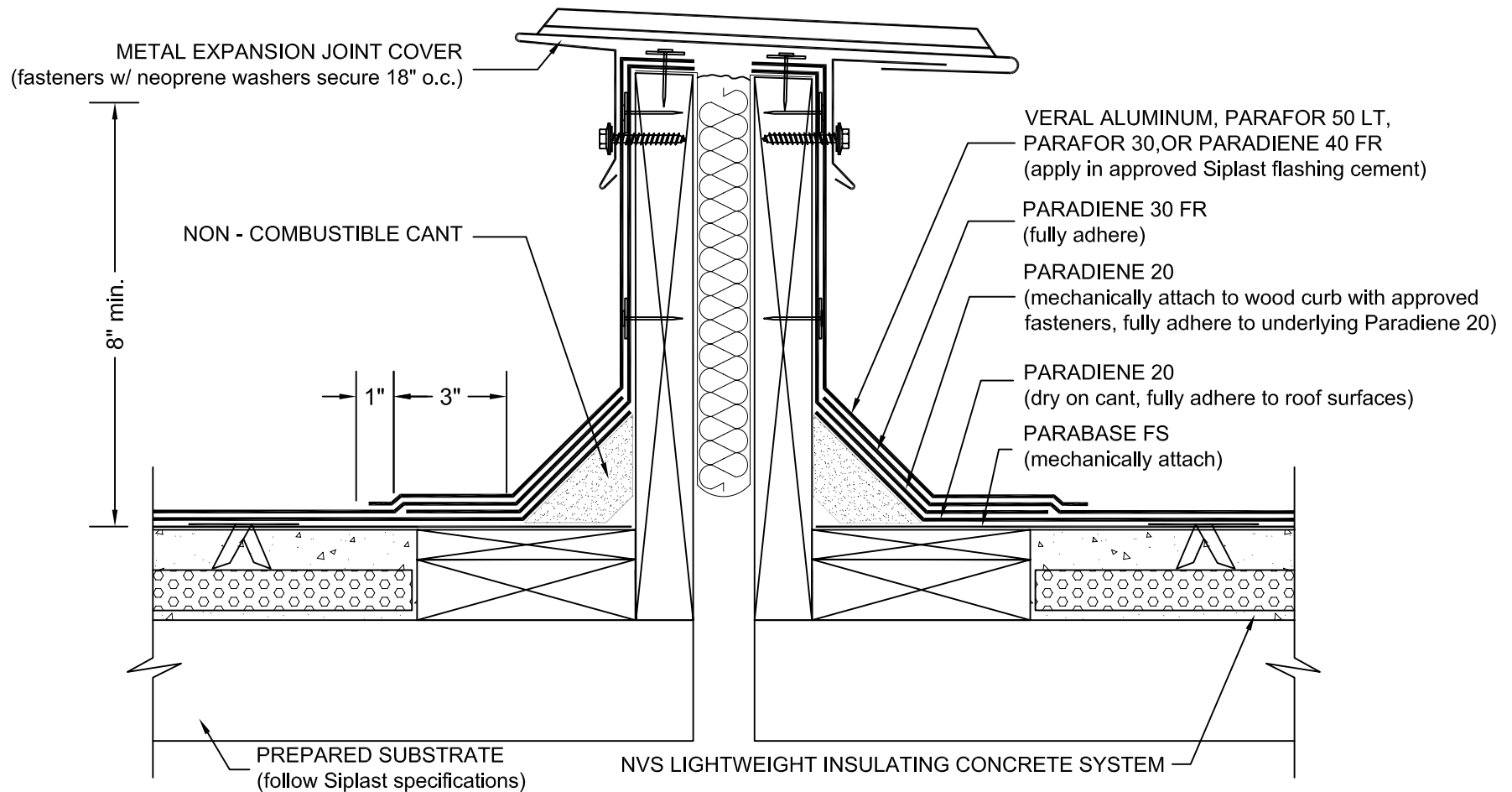

- NOTES: 1. APPLY GRANULE SURFACED FLASHING SHEETS IN PA-828 FLASHING CEMENT OR SFT CEMENT. SFT CEMENT IS REQUIRED FOR VERAL ALUMINUM & STAINLESS STEEL FLASHING SHEETS.
2. THE CARPENTRY AND METAL WORK SHOWN DEPICTS SHOP FABRICATION AND JOB-SITE ASSEMBLY. THESE COMPONENTS SHOULD BE DESIGNED/FABRICATED/INSTALLED ACCORDING TO GENERALLY ACCEPTED INDUSTRY PRACTICES, STANDARDS, AND APPROVALS.
3. DISSIMILAR METAL TYPES SUBJECT TO ELECTROLYTIC REACTION SHOULD BE PHYSICALLY SEPARATED.
4. REQUIREMENTS AND RECOMMENDATIONS DETAILED IN SIPLAST SPECIFICATIONS SHALL APPLY IN ADDITION TO THE ABOVE DRAWING.

N.T.S.



1000 East Rochelle Boulevard - Irving, Texas - 75062

(800) 922-8800

www.siplast.com

Ref: Adh-Metal Exp Jt-2030 nvs

Rev: 10.25.10