

INSULATION

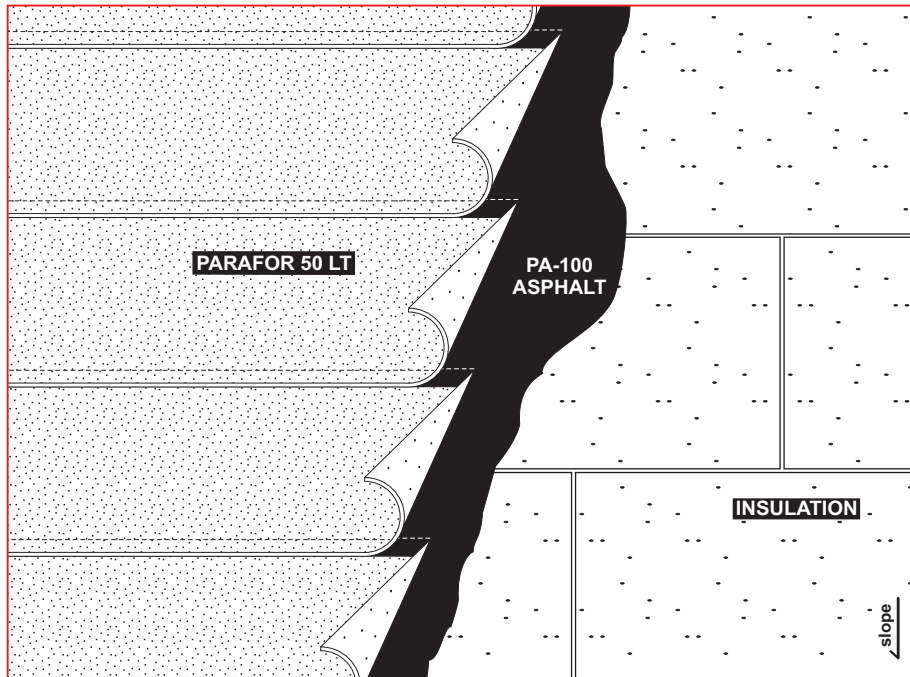

SLOPE $\frac{1}{2}'' - 2\frac{1}{2}''$ PER FOOT*

MATERIALS per 100 sq ft

INSULATION	
PA-100 ASPHALT	25 lb
PARAFOR 50 LT	141 lb

* Contact Siplast for higher or lower slope requirements.

n.t.s.

SPECIFICATION 5000 IH

Requirements and recommendations detailed in the Siplast catalog and Siplast long form specifications shall apply in addition to the following recommendations and specifications.

APPLICATION

1. Install approved insulation panels according to manufacturer's recommendations and FM Global requirements, if applicable. The edges of insulation panels should be in moderate contact without forcing and cut to fit neatly against adjoining surfaces. The insulation layer should present a smooth surface to accept the roof membrane.
2. Beginning at the low point of the roof, fully mop one ply of Parafor 50 LT to the insulation surface using PA-100 Asphalt, lapping sides a minimum of 4 inches and ends a minimum of 6 inches. Offset end laps a minimum of 3 feet.

Notes: The Parafor 50 LT sheets must be back-nailed in all hot asphalt applied specifications.

In certain applications, the sheets may be applied parallel to the slope of the roof. Contact Siplast for requirements.



1000 East Rochelle Boulevard Irving, Texas 75062 (800) 922-8800 FAX (469) 995-2206

Ref. #: P50-h Rigid
Rev. 11.03.10



An Icopal Group Company