

INSULATION

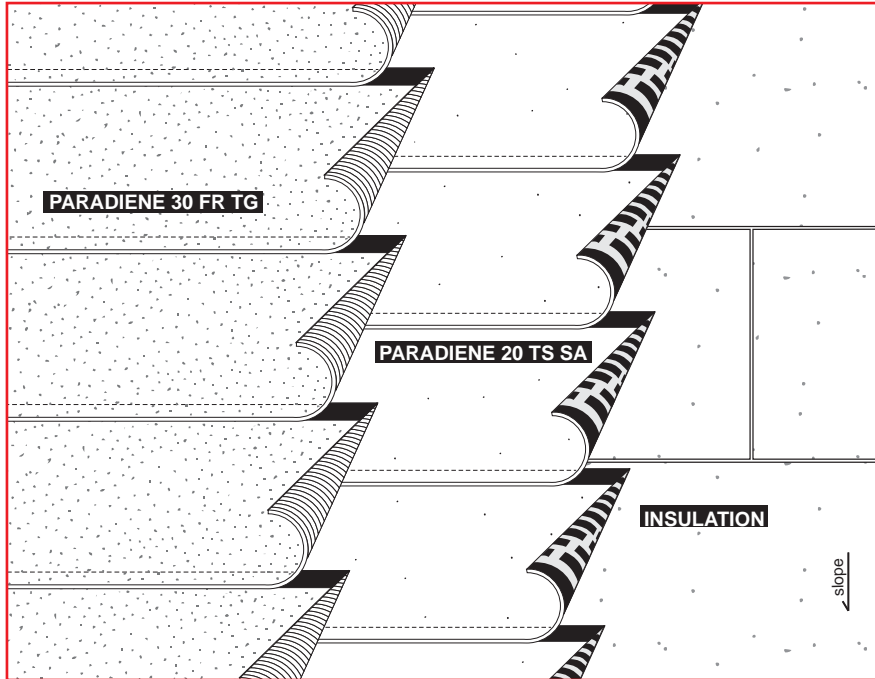

SLOPE	0" - 2 ½ per ft*
MATERIALS	per 100 sq ft
INSULATION	
PARADIENE 20 TS SA	76 lb
PARADIENE 30 FR TG	112 lb

* Contact Siplast for higher slope requirements.

n.t.s.

Specification: 20S30 ISA-T

Requirements and recommendations detailed in the Siplast catalog and Siplast long form specifications shall apply in addition to the following recommendations and specifications.

Application

1. Install insulation panels according to manufacturer's recommendations and FM Global requirements, if applicable. The edges of insulation panels should be in moderate contact without forcing and cut to fit neatly against adjoining surfaces. The insulation layer should present a smooth surface to accept the roof membrane.
2. Beginning at the low point of the roof, adhere the Paradiene 20 TS SA layer to the insulation surface, lapping sides and ends a minimum of 3 inches. End laps require torch or heat welding. Offset end laps a minimum of 3 feet. End joints may also be butted and seamed using a 12-inch band of Paradiene 20 TG.
3. Beginning again at the low point of the roof, fully torch one ply of Paradiene 30 FR TG to the Paradiene 20 TS SA surface, lapping sides and ends a minimum of 3 inches. Offset end laps a minimum of 3 feet. Stagger laps between plies.

Notes: Both layers (Paradiene 20 TS SA and Paradiene 30 FR TG) must be applied in the same day.
Torch prime all granule surfaces to be lapped by adjoining sheets.

Caution: Siplast recommends that all practices pertaining to NRCA CERTA guidelines be followed when torching methods are employed. This includes performing a fire watch following any torch applications. Always have approved fire-extinguishing equipment nearby.

Ref. #: P20-tssa P30-tg Rigid
Date: 11.2.09