

INSULATION

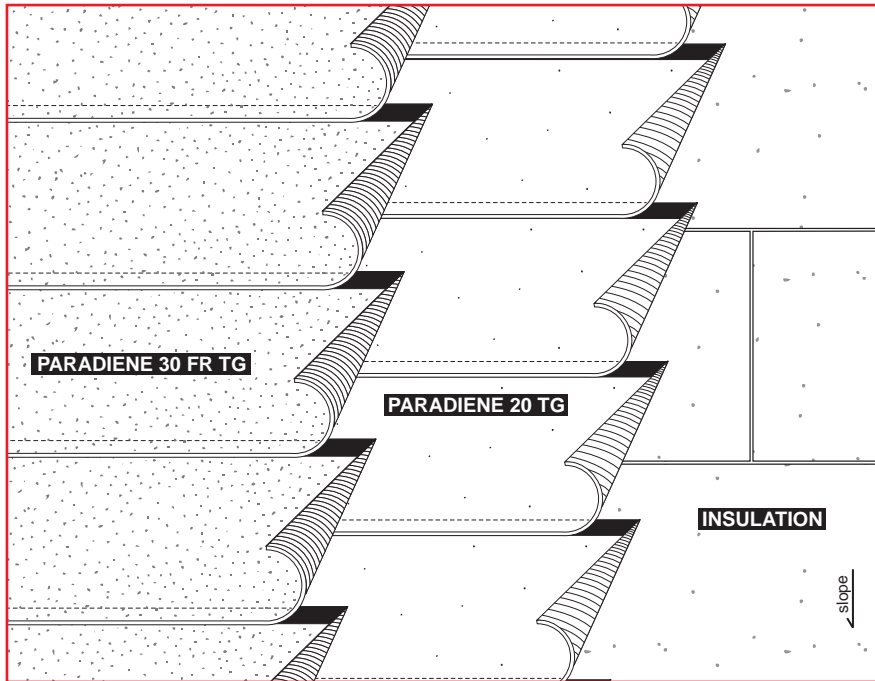

SLOPE 0" - 2 1/2" per ft*

MATERIALS per 100 sq ft

INSULATION
PARADIENE 20 TG 76 lb
PARADIENE 30 FR TG 112 lb

* Contact Siplast for higher slope requirements.

n.t.s.

Specification: 2030 IT

Requirements and recommendations detailed in the Siplast catalog and Siplast long form specifications shall apply in addition to the following recommendations and specifications.

Application

1. Install insulation panels according to manufacturer's recommendations and FM Global requirements, if applicable. The edges of insulation panels should be in moderate contact without forcing and cut to fit neatly against adjoining surfaces. The insulation layer should present a smooth surface to accept the roof membrane.
2. Beginning at the low point of the roof, fully torch one ply of the Paradiene 20 TG to the insulation surface, lapping sides and ends a minimum of 3 inches. Offset end laps a minimum of 3 feet.
3. Beginning again at the low point of the roof, fully torch one ply of Paradiene 30 FR TG to the Paradiene 20 TG surface, lapping sides and ends a minimum of 3 inches. Offset end laps a minimum of 3 feet. Stagger laps between plies.

Note: Torch prime all granule surfaces to be lapped by adjoining sheets.

Caution: Siplast recommends that all practices pertaining to NRCA CERTA guidelines be followed when torching methods are employed. This includes performing a fire watch following any torch applications. Always have approved fire-extinguishing equipment nearby.

Ref. #: P20-tg P30-tg Rigid
 Date: 11.2.09