

INSULATION

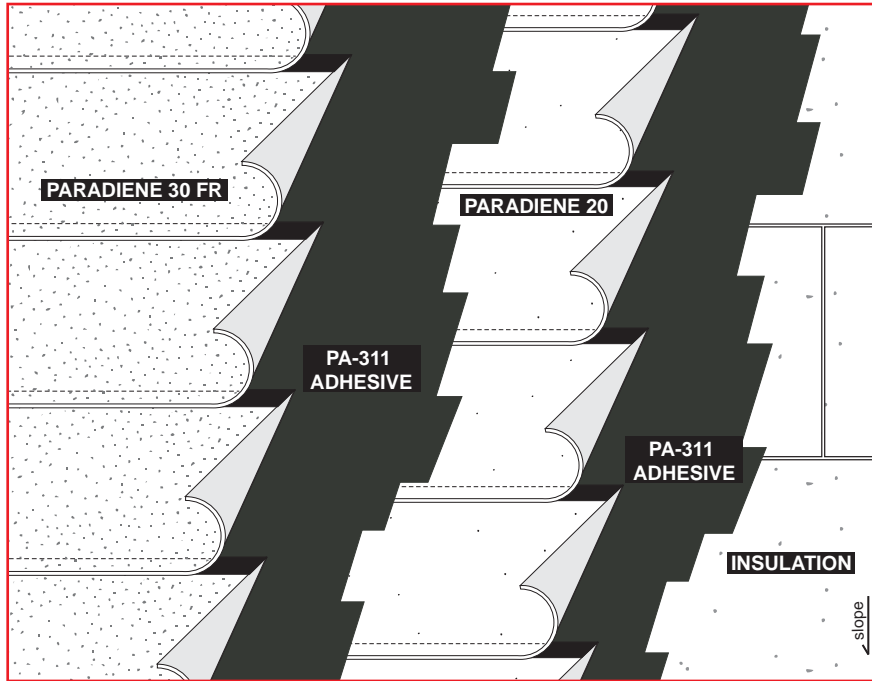

SLOPE 1/4" - 2 1/2" per ft*

MATERIALS per 100 sq ft

INSULATION
PA-311 ADHESIVE 1 1/2 - 2 1/2 gal
PARADIENE 20 62 lb
PA-311 ADHESIVE 1 1/2 gal
PARADIENE 30 FR 90 lb

* Contact Siplast for higher or lower slope requirements.

n.t.s.

Specification: 2030 IA

Requirements and recommendations detailed in the Siplast catalog and Siplast long form specifications shall apply in addition to the following recommendations and specifications.

Application

1. Install insulation panels according to manufacturer's recommendations and FM Global requirements, if applicable. The edges of insulation panels should be in moderate contact without forcing and cut to fit neatly against adjoining surfaces. The insulation layer should present a smooth surface to accept the roof membrane.
2. Beginning at the low point of the roof, lay one ply of the Paradiene 20 in a full coating of PA-311 Adhesive, lapping sides and ends a minimum of 3 inches. Offset end laps a minimum of 3 feet.
3. Beginning again at the low point of the roof, fully adhere one ply of Paradiene 30 FR to the Paradiene 20 surface using PA-311 Adhesive, lapping sides and ends a minimum of 3 inches. Offset end laps a minimum of 3 feet. Stagger laps between plies.

Ref. #: P20-a P30-a Rigid
 Date: 11.2.09



1000 East Rochelle Boulevard Irving, Texas 75062 (800) 922-8800 FAX (469) 995-2206



An Icopal Group Company