



Paraguard Coping

ORDER/SPECIFICATION FORM

MODEL NUMBER

STANDARD DIMENSIONS

- | | |
|----------------------------------|----------------------------------|
| <input type="checkbox"/> PGC600 | <input type="checkbox"/> PGC1200 |
| <input type="checkbox"/> PGC700 | <input type="checkbox"/> PGC1300 |
| <input type="checkbox"/> PGC800 | <input type="checkbox"/> PGC1400 |
| <input type="checkbox"/> PGC900 | <input type="checkbox"/> PGC1500 |
| <input type="checkbox"/> PGC1000 | <input type="checkbox"/> PGC1600 |
| <input type="checkbox"/> PGC1100 | |

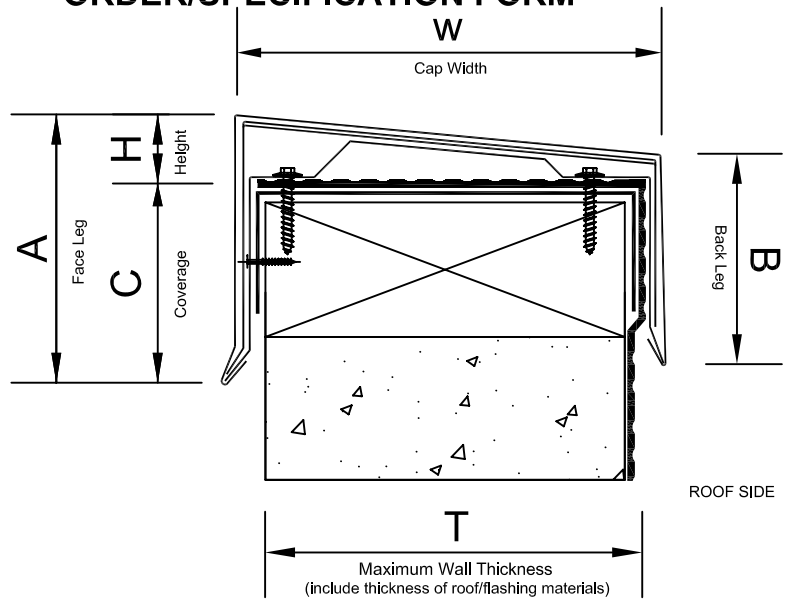

A = 4³/₄"

B = 3³/₄"

C = 3¹/₂"

H = 1¹/₄"

QUANTITY:

- ___ FT. TOTAL PERIMETER
- ___ PCS. STOCK @ 10'0"
- ___ PCS STD. O.S. CORNER
- ___ PCS STD. I.S. CORNER
- ___ PCS CUSTOM CORNER (attach sketch)
- ___ PCS END CAP - LEFT
- ___ PCS END CAP - RIGHT
- ___ PCS TRANSITION (attach sketch)
- ___ _____
- ___ _____
- ___ _____
- ___ _____

CUSTOM LEG DIMENSIONS FOR NON-STANDARD SIZES:

T = _____

B = _____

C = _____

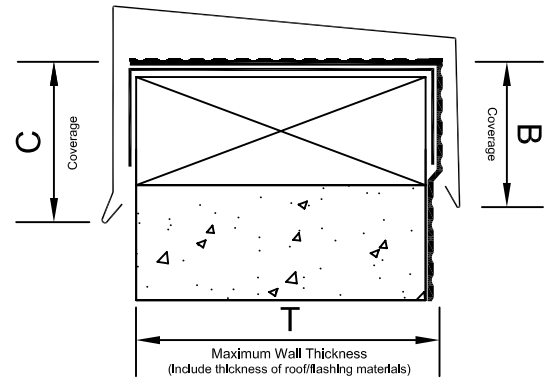

CAP MATERIAL

THICKNESS

FINISH

ALUMINUM

0.040"

COIL KYNAR

GALV. STEEL

0.050"

SPRAY KYNAR

STAIN. STEEL

0.063"

MILL

24 GAUGE

CLEAR ANODIZED

BRONZE ANODIZED

BLACK ANODIZED

SIPLAST PARAGUARD COLOR: SP _____

JOB NAME: _____ JOB NO: _____

LOCATION: _____

SHIP TO ADDRESS: _____

CONTRACTOR APPROVAL:

APPROVED FOR FABRICATION

CONTRACTOR NAME

CONTRACTOR REPRESENTATIVE

APPROVED WITH CHANGES

DATE

CONTRACTOR SIGNATURE