

INSULATION

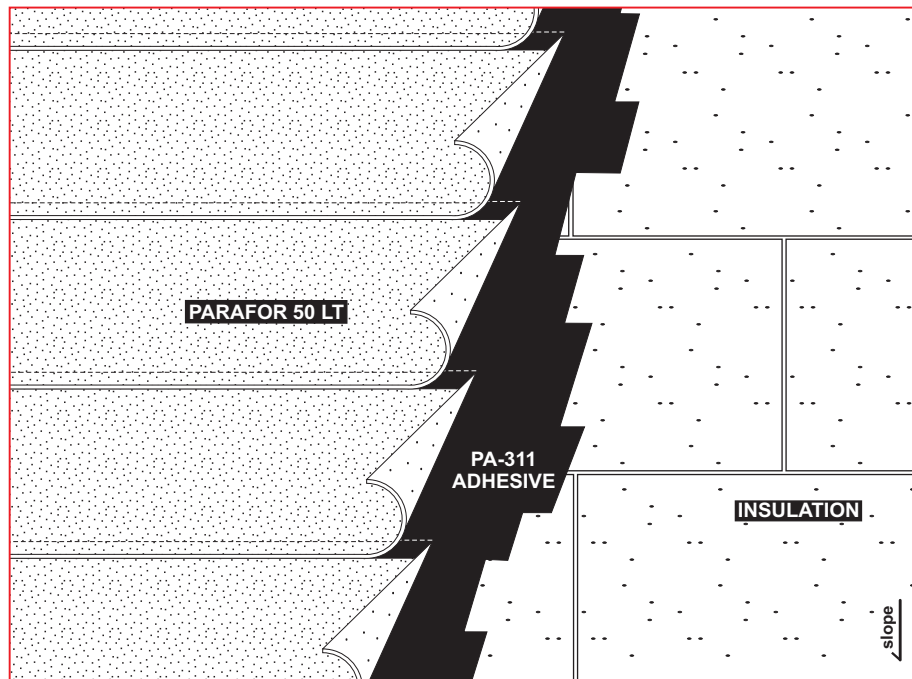

SLOPE 1/2" PER FOOT MIN*

MATERIALS per 100 sq ft

INSULATION
PA-311 ADHESIVE 1½ - 2½ gal
PARAFOR 50 LT 141 lb

* Contact Siplast for lower slope requirements.

n.t.s.

SPECIFICATION 5000 IA

Requirements and recommendations detailed in the Siplast catalog and Siplast long form specifications shall apply in addition to the following recommendations and specifications.

APPLICATION

1. Install approved insulation according to manufacturer's recommendations and FM Global requirements, if applicable. The edges of insulation panels should be in moderate contact without forcing and cut to fit neatly against adjoining surfaces. The insulation layer should present a smooth surface to accept the roof membrane.
2. Beginning at the low point of the roof, lay one ply of Parafor 50 LT in a full coating of PA-311 Adhesive, lapping sides a minimum of 4 inches and ends a minimum of 6 inches. Offset end laps a minimum of 3 feet.

Slopes over 2½" per foot: Run all plies parallel to the slope of the roof. The Parafor 50 LT must be back-nailed on slopes over 2½" per foot.



1000 East Rochelle Boulevard Irving, Texas 75062 (800) 922-8800 FAX (469) 995-2206

Ref. #: 0050IA
Rev: 10.28.07



An Icopal Group Company