

Terapro Waterproofing - Reinforced System expansion joint

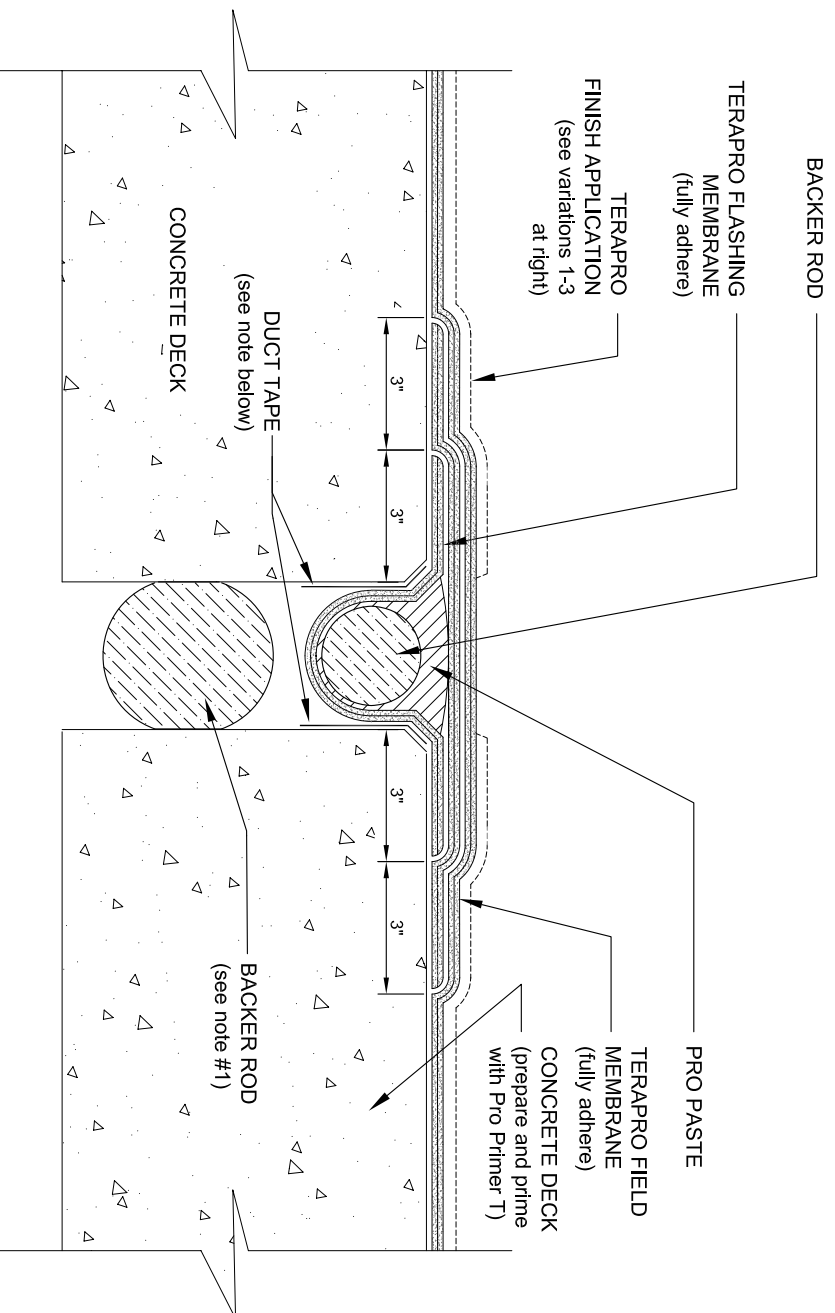

- NOTES:
1. BACKER ROD MATERIAL SHOULD BE COMPOSED OF EXTRUDED, CLOSED CELL POLYETHYLENE
 2. APPLY DUCT TAPE BENEATH FLEECE LOOP TO PREVENT ADHESION OF THE SATURATED FLEECE IN THE AREA TO EXPERIENCE EXPANSION/CONTRACTION.
 3. FINISH APPLICATION OF SURFACE AGGREGATE IS HELD BACK (not applied) DIRECTLY OVER THE EXPANSION JOINT.
 4. REFER TO SIPLEST PREPARATION GUIDELINES FOR PROPER SURFACE TREATMENT OF ALL MATERIALS PRIOR TO APPLICATION OF TERAPRO MATERIAL.
 5. REQUIREMENTS AND RECOMMENDATIONS DETAILED IN TERAPRO INSTALLATION SPECIFICATIONS SHALL APPLY IN ADDITION TO THE ABOVE DRAWING.

N.T.S.

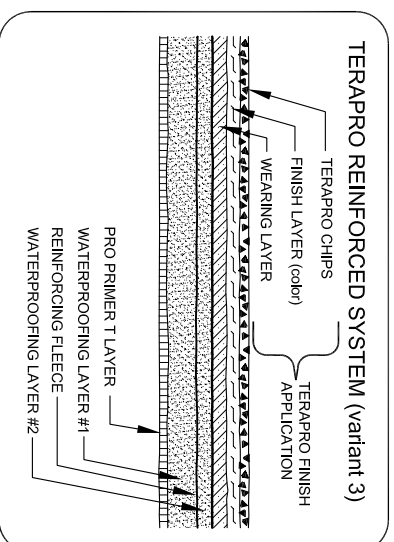
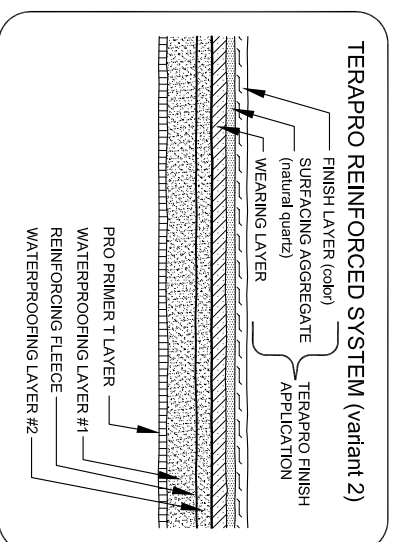
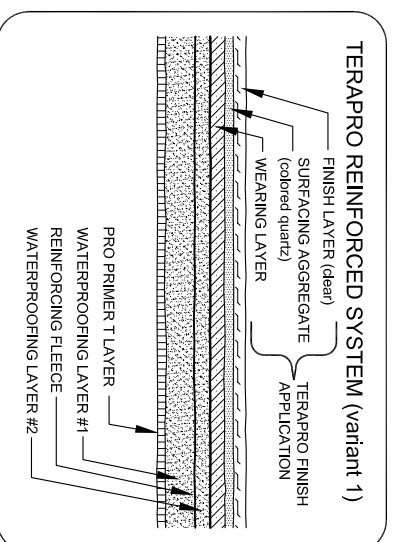

Siplast - 1000 East Rochelle Boulevard - Irving, Texas - 75062-3940
 (800) 922-8800 FAX: (469) 995-2206 www.siplast.com

Ref. #: TPR-J4
 Date: 02.22.08