

PENETRATION CONDITION

(shown without protection system)

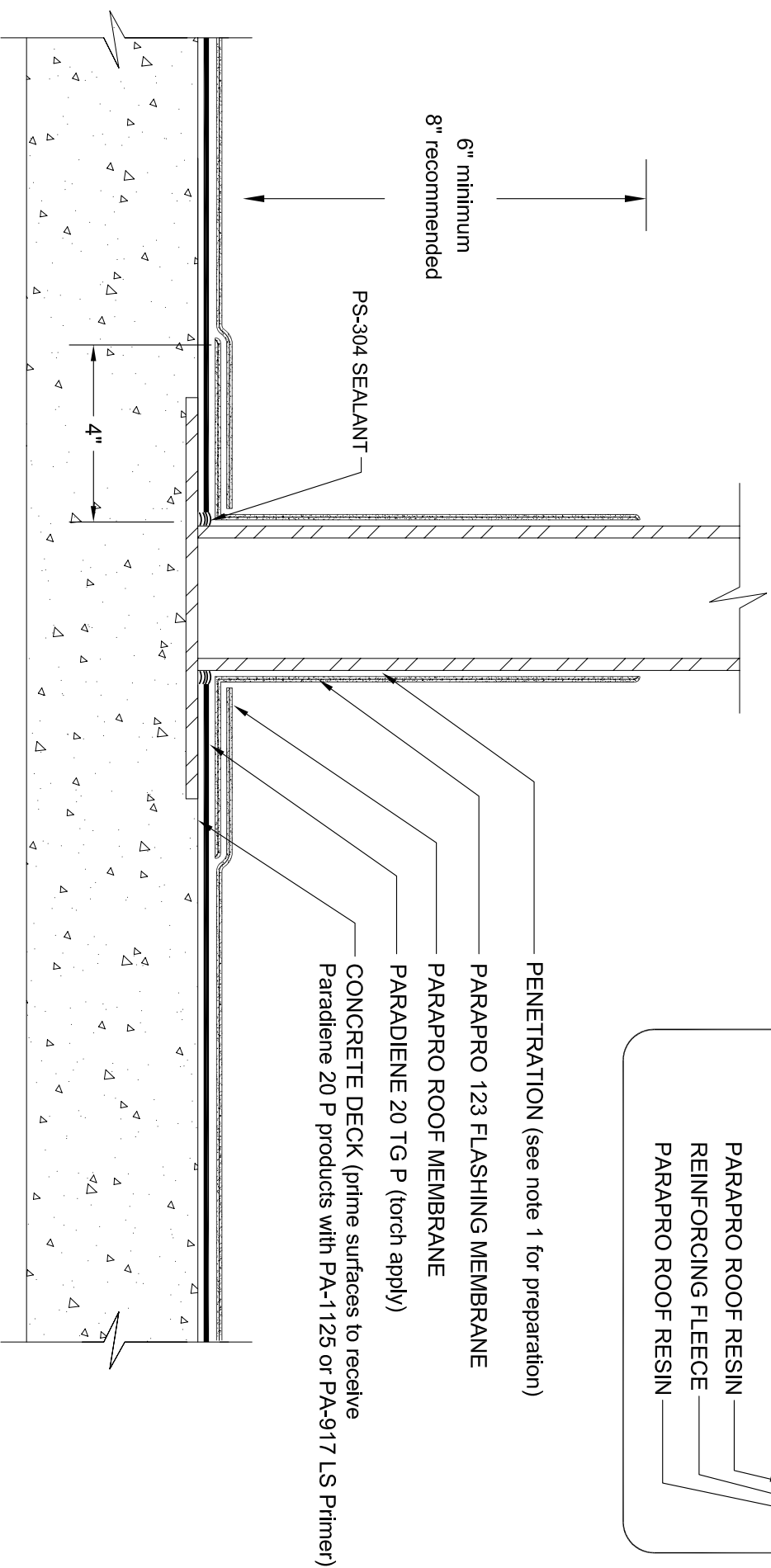

- NOTES:
1. REFER TO Siplast PREPARATION GUIDELINES FOR PROPER SURFACE TREATMENT OF ALL MATERIALS PRIOR TO APPLICATION OF PARAPRO MATERIALS.
 2. BEFORE APPLICATION OF PARAPRO FLASHING MEMBRANE, PRO PASTE OR PS-304 ELASTOMERIC SEALANT SHOULD BE USED TO FILL VOIDS WHERE ROOFING MEMBRANES TERMINATE AT PENETRATIONS.
 3. REFER TO Siplast FLEECE CUTTING RECOMMENDATIONS FOR CONFIGURATIONS, CUTTING, FOLDING AND LAPPING TECHNIQUES.
 4. REQUIREMENTS AND RECOMMENDATIONS DETAILED IN THE CURRENT Siplast SPECIFICATIONS AND PARAPRO ROOF SYSTEM INSTALLER'S GUIDE SHALL APPLY IN ADDITION TO THE ABOVE DRAWING.

N.T.S.



Siplast - 1000 East Rochelle Boulevard - Irving, Texas - 75062-3940
 (800) 922-8800 FAX: (469) 995-2206 www.siplast.com

Ref. #: 2PPRCp17
 Date: 11.03.08